

NOTES:
 1. SEE SHEET WA-C-002 FOR GENERAL NOTES, LEGEND AND ABBREVIATIONS.

This document and the design it covers are the property of PARSONS. They are loaned only with the borrower's expressed written agreement that they will not be reproduced, copied, loaned, exhibited, or used in any other way, except by written consent from PARSONS to the borrower.

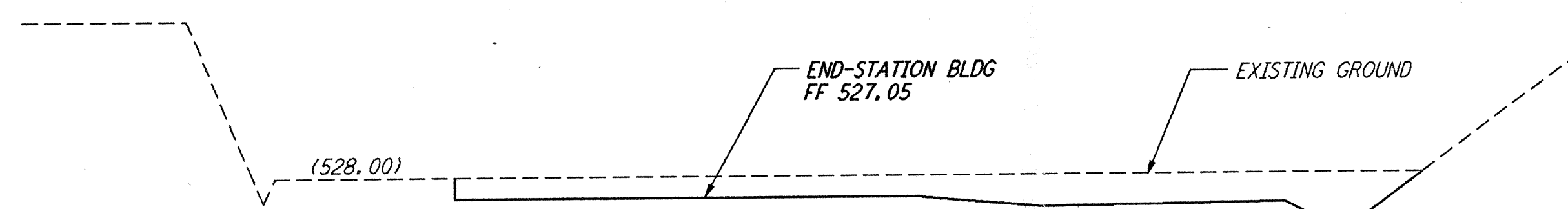

SECTION A
 SCALES: HORIZ: 1" = 20'
 VERT: 1" = 10'
 REF: WA-C-054, WA-C-026

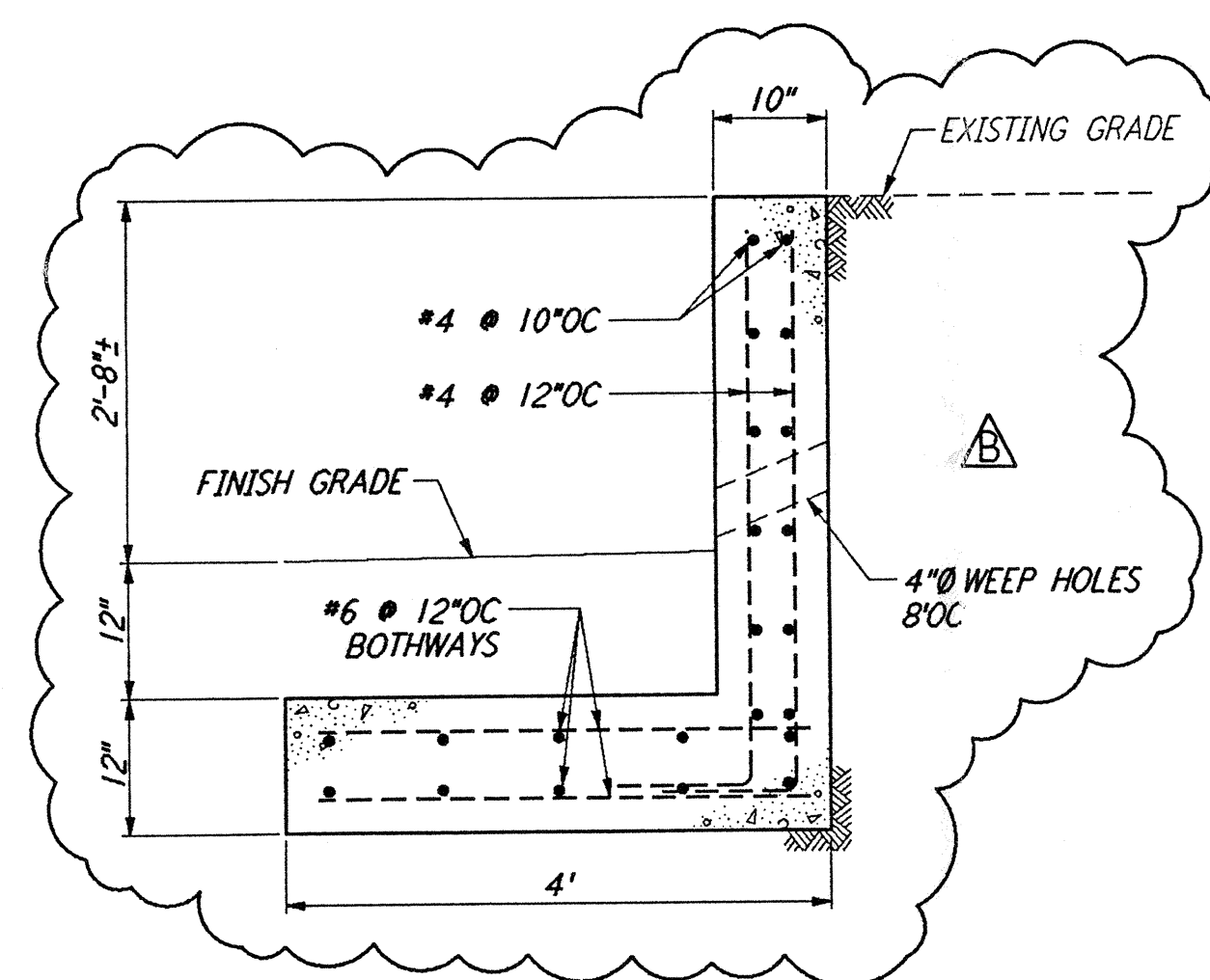

RETAINING WALL 1
 NOT TO SCALE
 REF: WA-C-054, WA-C-026, WA-C-046

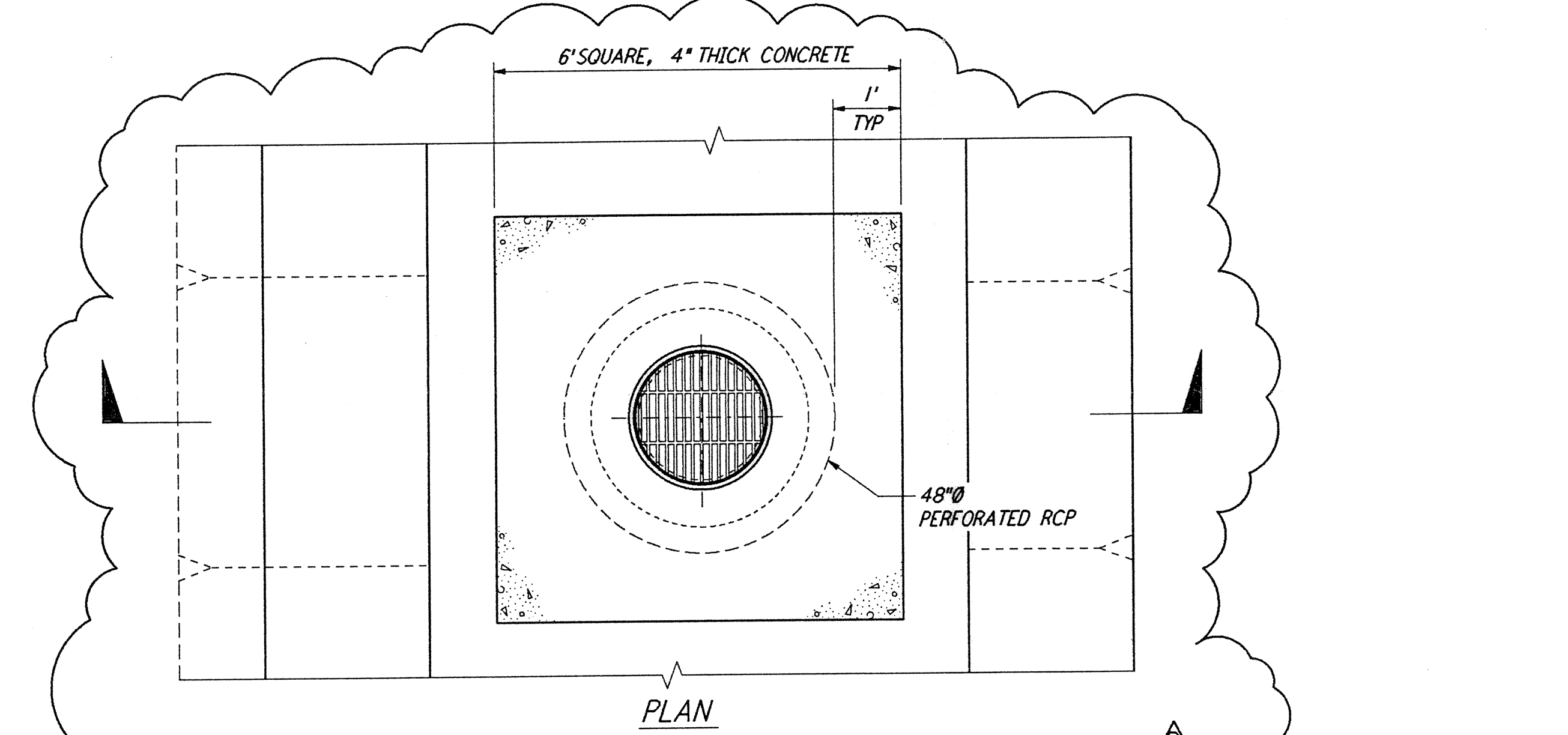

PLAN

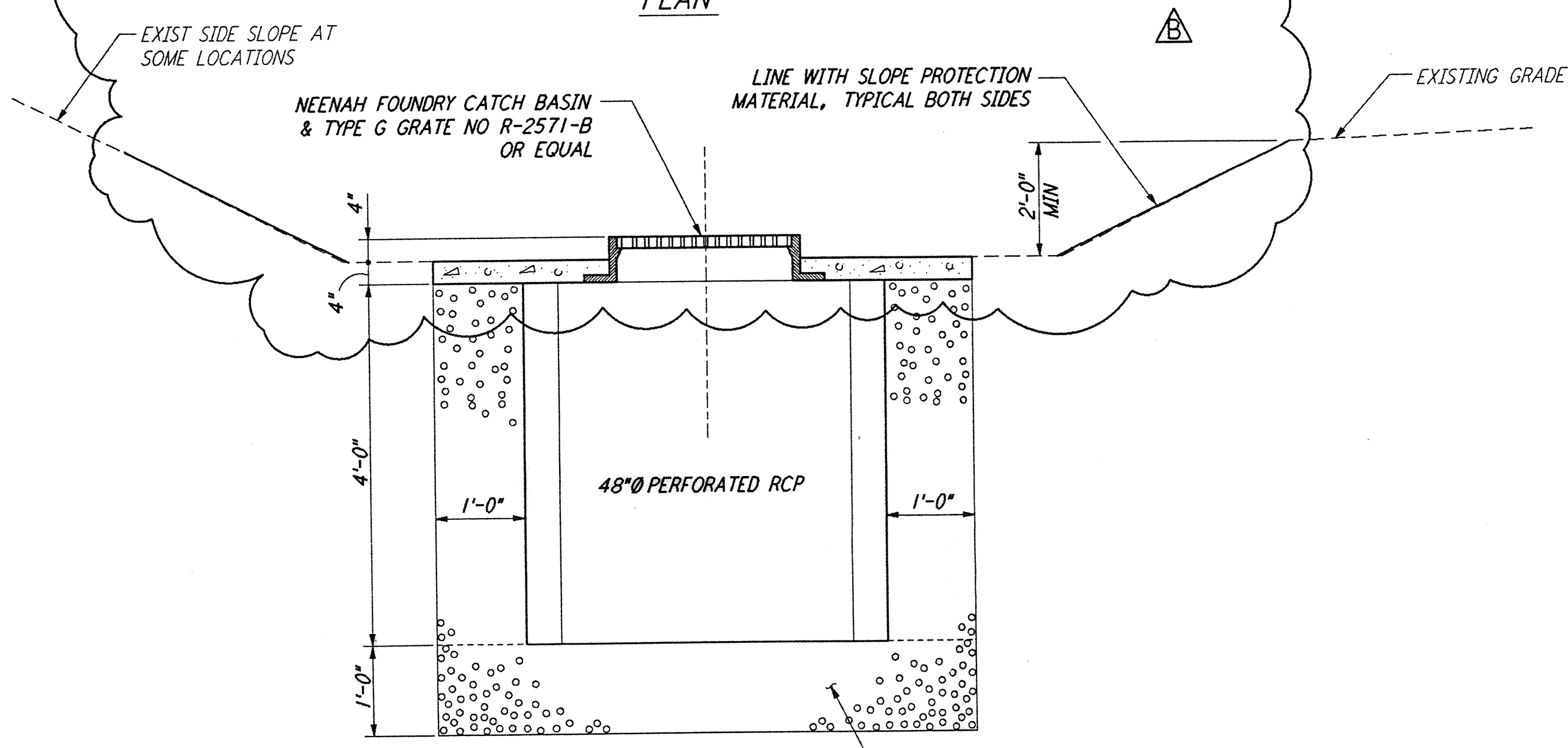

SECTION

48"Ø PERFORATED RCP w/ GRATE 2
 NOT TO SCALE
 REF: WA-C-054, WA-C-022, WA-C-026, WA-C-042

DRAWING NO.	DESCRIPTION	NO.	DATE	BY	CHKD	ENGR	PROJ	DESCRIPTION
		B	5/22/96	WRB	ML	MDW		BID ADDENDUM #2
		A	4/19/96	WRB	ML	MDW		FINAL DESIGN REVIEW & BID

DRAWN	WRB
CHECKED	
ENGINEER	
PROJ	

PARSONS
 100 WEST WALNUT STREET
 PASADENA, CALIFORNIA

LIGO
 CALIFORNIA INSTITUTE OF TECHNOLOGY
 MASSACHUSETTS INSTITUTE OF TECHNOLOGY

LASER INTERFEROMETER
 GRAVITATIONAL-WAVE OBSERVATORY
 SITE NO. 1 - HANFORD, WASHINGTON

TITLE	CIVIL GRADING SECTIONS & DETAILS SHEET 2	SCALE	AS NOTED	CONTRACT NUMBER	PP150969	PROJECT NUMBER	8094
SHEET NUMBER		WA-C-054		REVISIONS			

LIGO-D960238-B-0

LIGOWAF3.BDR