

WALL TYPE SCHEDULE

WALL TYPES LEGEND

WALL KEY	DETAIL PLAN	DESCRIPTION	WALL KEY	DETAIL PLAN	DESCRIPTION	WALL KEY	DETAIL PLAN	DESCRIPTION
18		EXTERIOR INSULATED METAL WALL PANELS (VERTICAL)  NOTE: SEE WALL SECTIONS AND DETAIL FOR ADDITIONAL INFORMATION ON CONC BASE  MTLPAN-T-ST	11		6\" METAL STUDS 5/8\" GYPSUM BOARD	4		4\" METAL STUD 5/8\" GYPSUM BOARD
19		7/8\" SMOOTH PLASTER OVER METAL LATH 1/2\" PLYWOOD 8\" METAL STUDS 1/2\" PLYWOOD 7/8\" SMOOTH PLASTER OVER METAL LATH	12		6\" METAL STUDS 1/4\" CERAMIC TILE 1\" GROUT/BACKER BOARD	5		( WIRE WHERE INSULATION OCCURS ) 4\" METAL STUDS 1\" GROUT/BACKER BOARD 1/4\" CERAMIC TILE
20			13		5/8\" GYPSUM BOARD 6\" METAL STUDS 1\" GROUT/BACKER BOARD 1/4\" CERAMIC TILE	6		5/8\" GYPSUM BOARD 4\" METAL STUD 5/8\" GYPSUM BOARD
21			14		1/4\" CERAMIC TILE 1\" GROUT/BACKER BOARD 6\" METAL STUDS 1\" GROUT/BACKER BOARD 1/4\" CERAMIC TILE	7		5/8\" GYPSUM BOARD 4\" METAL STUD 1\" GROUT/BACKER BOARD 1/4\" CERAMIC TILE
22			15		6\" METAL STUDS 5/8\" GYPSUM BOARD 5/8\" GYPSUM BOARD	8		4\" METAL STUD 5/8\" GYPSUM BOARD 5/8\" GYPSUM BOARD
23			16		5/8\" GYPSUM BOARD 6\" METAL STUDS 5/8\" GYPSUM BOARD	9		5/8\" GYPSUM BOARD 5/8\" GYPSUM BOARD 4\" METAL STUD 5/8\" GYPSUM BOARD 5/8\" GYPSUM BOARD
24			17		5/8\" GYPSUM BOARD 5/8\" GYPSUM BOARD 6\" METAL STUDS 5/8\" GYPSUM BOARD 5/8\" GYPSUM BOARD	10		5/8\" GYPSUM BOARD 5/8\" GYPSUM BOARD 4\" METAL STUD 5/8\" GYPSUM BOARD 5/8\" GYPSUM BOARD 1\" GROUT/BACKER BOARD 1/4\" CERAMIC TILE

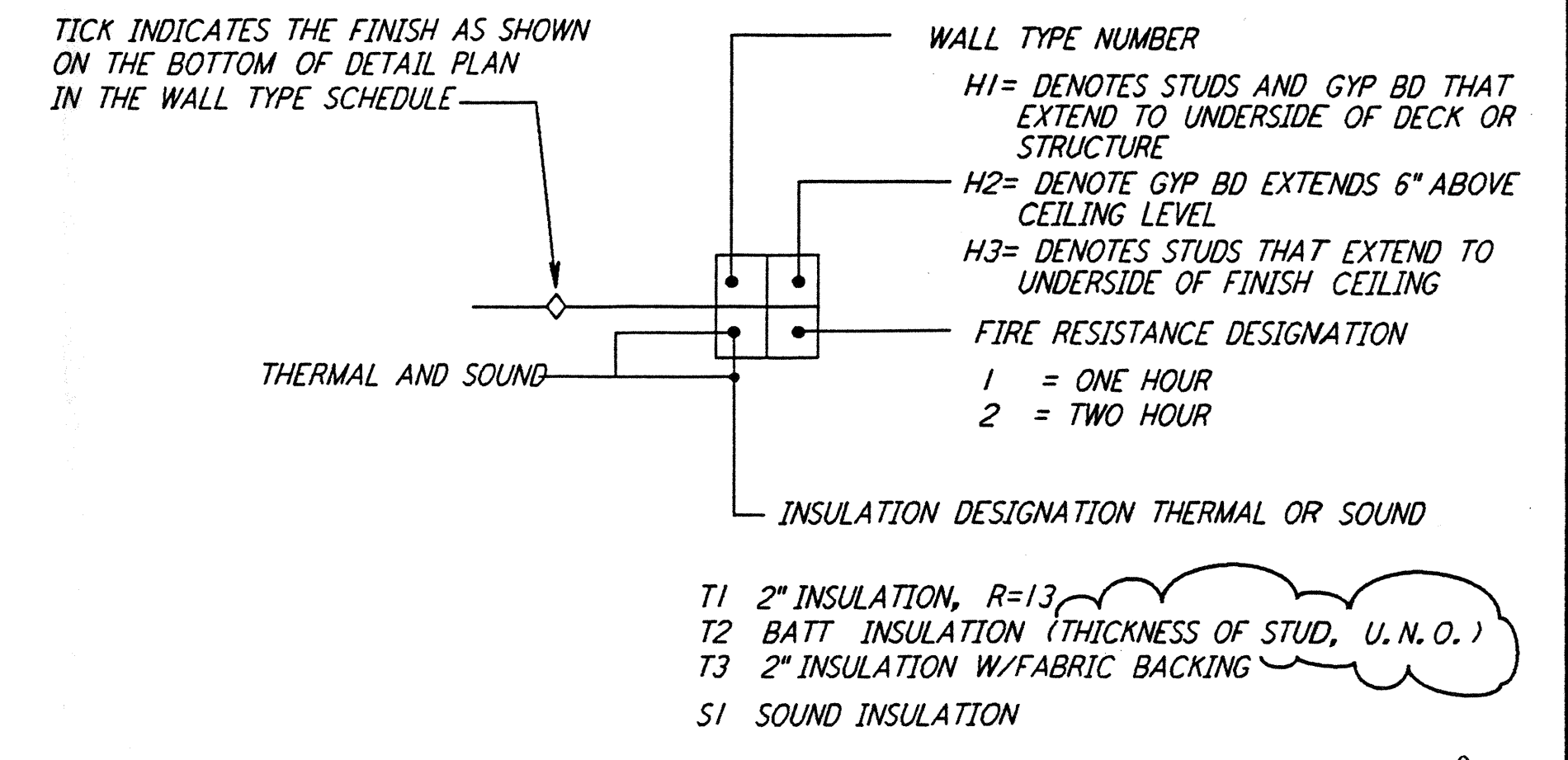

NOTE :  
 INDICATED INSULATION VALUES FOR THERMAL AND SOUND ARE THE MINIMUM REQUIRED VALUES

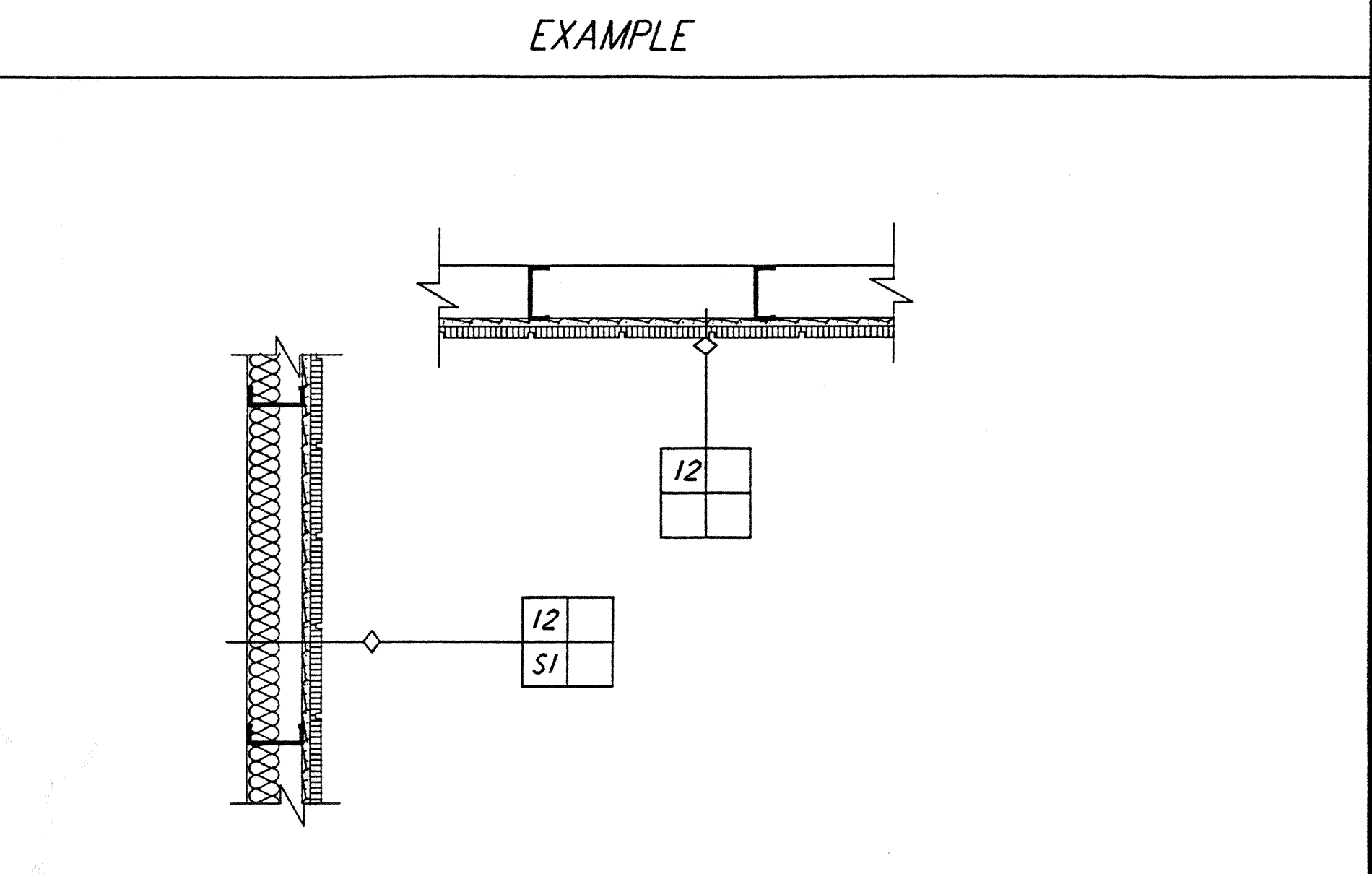

WALL KEY	DETAIL PLAN	DESCRIPTION
1		2 1/2\" METAL STUD 5/8\" GYPSUM BOARD
2		5/8\" GYPSUM BOARD 2 1/2\" METAL STUD 5/8\" GYPSUM BOARD
3		( WIRE WHERE INSULATION OCCURS ) 2 1/2\" METAL STUDS 1\" GROUT/BACKER BOARD 1/4\" CERAMIC TILE

LIGO-D960272-01-0

This document and the design it covers are the property of PARSONS. They are loaned only with the borrower's expressed written agreement that they will not be reproduced, copied, loaned, exhibited, or used in any other way, except by written consent from PARSONS to the borrower.

NO.	DATE	BY	CHKD	ENGR	PROJ	DESCRIPTION
1	2-28-97	CKT	TB	AK	TDM	CORNER STATION VSEA PARTITION

ISSUED FOR CONSTRUCTION			
DRAWN	CKT	5-12-96	
CHECKED	TB	5-26-96	
ENGINEER	bkk	7-12-96	
PROJ	MDW	7-12-96	

6829 REGISTERED ARCHITECT  
 ALEX ANDREW KRILL  
 STATE OF WASHINGTON  
 2/2/97

**PARSONS**  
 100 WEST WALNUT STREET  
 PASADENA, CALIFORNIA

**LIGO**  
 CALIFORNIA INSTITUTE OF TECHNOLOGY  
 MASSACHUSETTS INSTITUTE OF TECHNOLOGY

LASER INTERFEROMETER  
 GRAVITATIONAL-WAVE OBSERVATORY  
 SITE NO. 1 - HANFORD, WASHINGTON

TITLE: ARCHITECTURAL WALL TYPE SCHEDULES

SCALE: CONTRACT NUMBER: PP150969 PROJECT NUMBER: 8094

SHEET NUMBER: WA - A - 428