

NOTES:  
 1. FOR LEGEND, ABBREVIATIONS AND GENERAL NOTES SEE SHEETS  
 LA-H-001 AND LA-H-002.

This document and the design it covers are the property of PARSONS. They are loaned only with the borrower's expressed written agreement that they will not be reproduced, copied, loaned, exhibited, or used in any other way, except by written consent from PARSONS to the borrower.

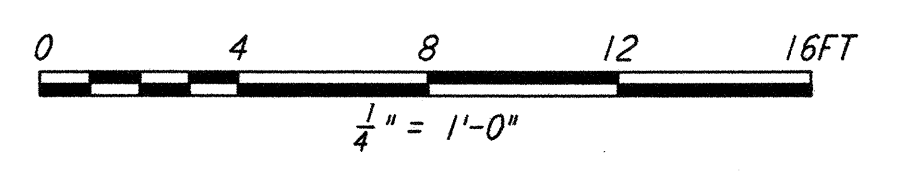
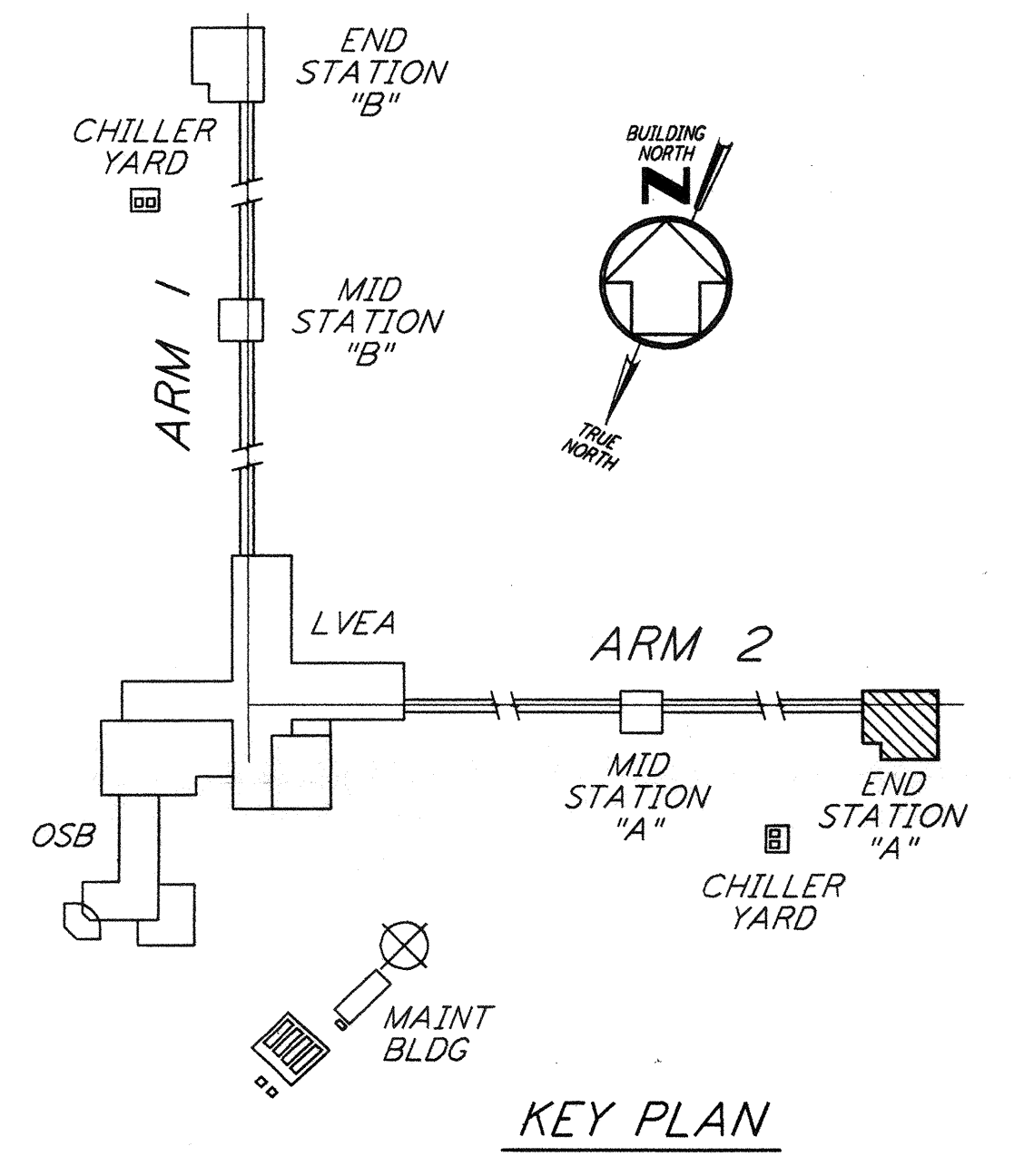
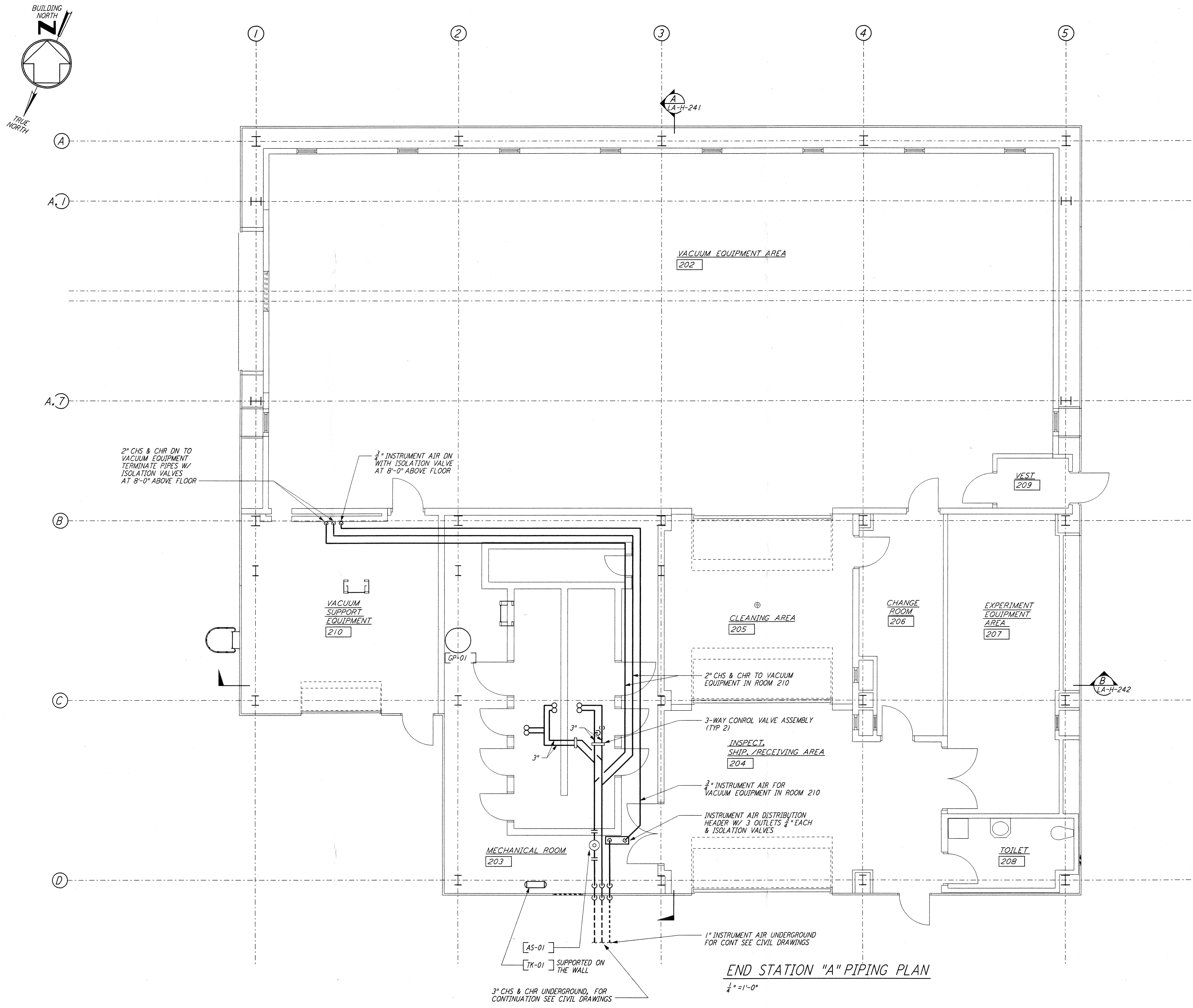

**END STATION "A" PIPING PLAN**  
 $\frac{1}{4}'' = 1'-0''$

NO.	DATE	BY	CHKD	ENGR	PROJ	DESCRIPTION
1	8-7-98	DJB	AA	AA		ISSUED FOR AS-BUILT

ISSUED FOR CONSTRUCTION	
DRAWN	CLP 11-15-96
CHECKED	MN 10-25-96
ENGINEER	AA 1-23-96
PROJ	TDM 11-15-96

**AS-BUILT DRAWINGS**



100 WEST WALNUT STREET  
 PASADENA, CALIFORNIA



CALIFORNIA INSTITUTE OF TECHNOLOGY  
 MASSACHUSETTS INSTITUTE OF TECHNOLOGY

**LIGO-D960986-01-O**  
 LASER INTERFEROMETER  
 GRAVITATIONAL-WAVE OBSERVATORY  
 SITE NO.2 - LIVINGSTON, LOUISIANA

TITLE	SCALE	CONTRACT NUMBER	PROJECT NUMBER
HVAC END STATION "A" PIPING PLAN	AS NOTED	PP150969	8094
SHEET NUMBER	REVISIONS		
<b>LA-H-215</b>			