

- NOTES:**
 1. SEE SHEET RG-C-002 FOR GENERAL NOTES, LEGEND AND ABBREVIATIONS.
 2. SEE SHEET RG-C-004 FOR TYPICAL SECTIONS AND DETAILS.

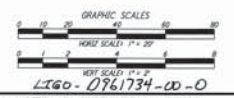
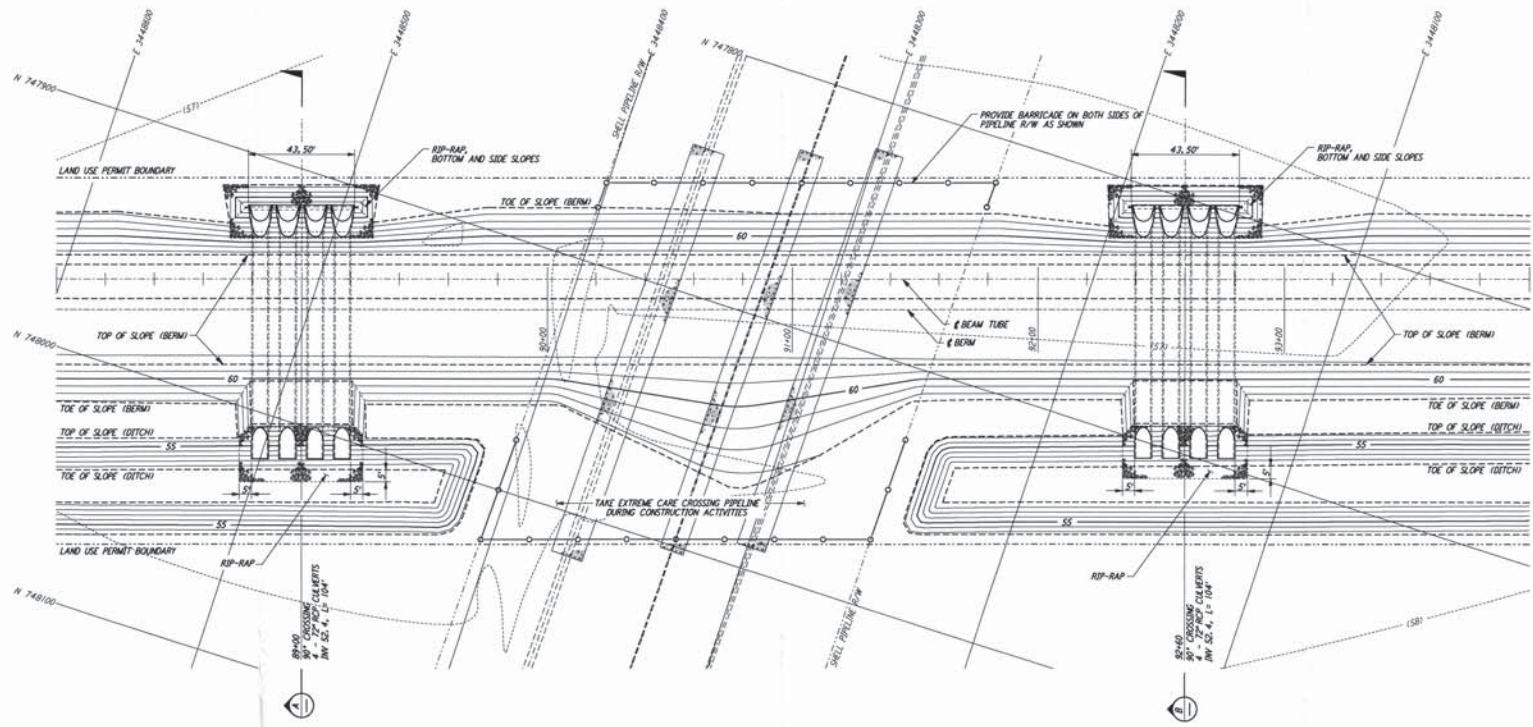
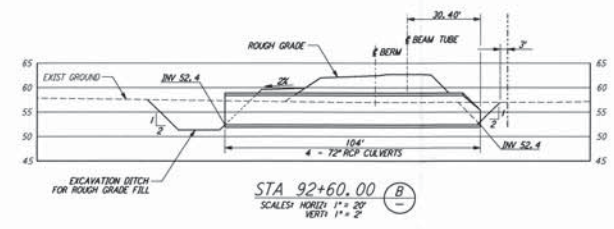
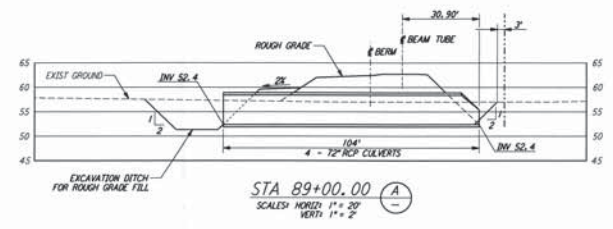

9				DATE	8/11/95		
8				DRAWN	WPS 8/9/95		
7				CHECKED	MP 8/9/95		
6				ENGINEER	WJG 8/28/95		
5				PROJ MGR	WJG 8/28/95		
4							
3							
2							
1	8/28/95	WJG	ISSUED FOR BID				
NO.	DATE	APPRO BY	DESCRIPTION OF REVISION	NO.	DATE	APPRO BY	ISSUED FOR

PARSONS
 100 WEST WALNUT STREET
 PASADENA, CALIFORNIA

LIGO
 CALIFORNIA INSTITUTE OF TECHNOLOGY
 MASSACHUSETTS INSTITUTE OF TECHNOLOGY

LASER INTERFEROMETER
 GRAVITATIONAL-WAVE OBSERVATORY
 ROUGH GRADING - LIVINGSTON, LA

ROUGH GRADING
 SOUTHWEST ARM
 CULVERT GENERAL
 ARRANGEMENTS

AS NOTED PPI50969 8094
RG-C-028

This document and the design it covers are the property of PARSONS. They are loaned only with the borrower's expressed written agreement that they will not be reproduced, copied, loaned, exhibited, or used in any other way, except by written consent from PARSONS to the borrower.

LIG Sep 12 06:16:36 1995 s3-v2662 J:\PLOT\5\DWG\5\7662\RG-C-028.DWG

E
 D
 C
 B
 A