

5

4

3

2

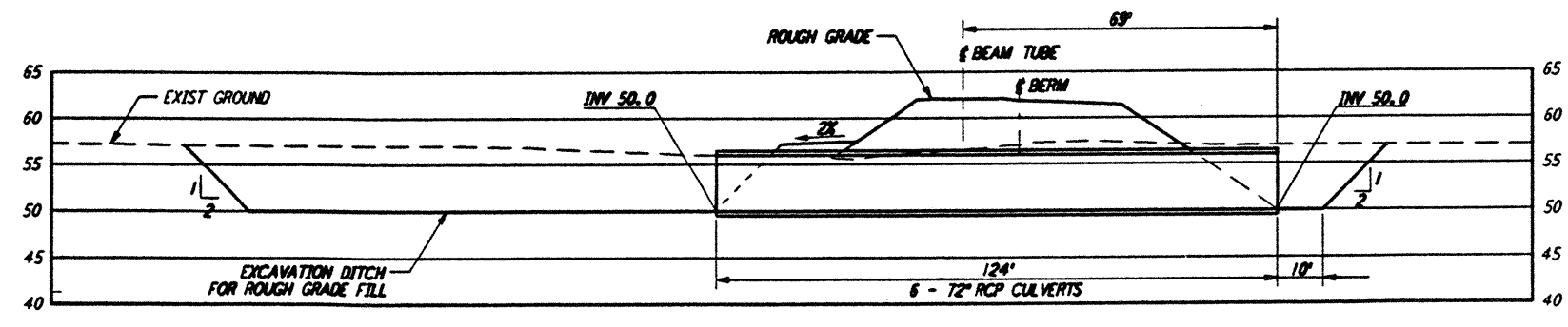

STA 27+40.00 (A)
 SCALES: HORIZ: 1" = 20'
 VERT: 1" = 2'

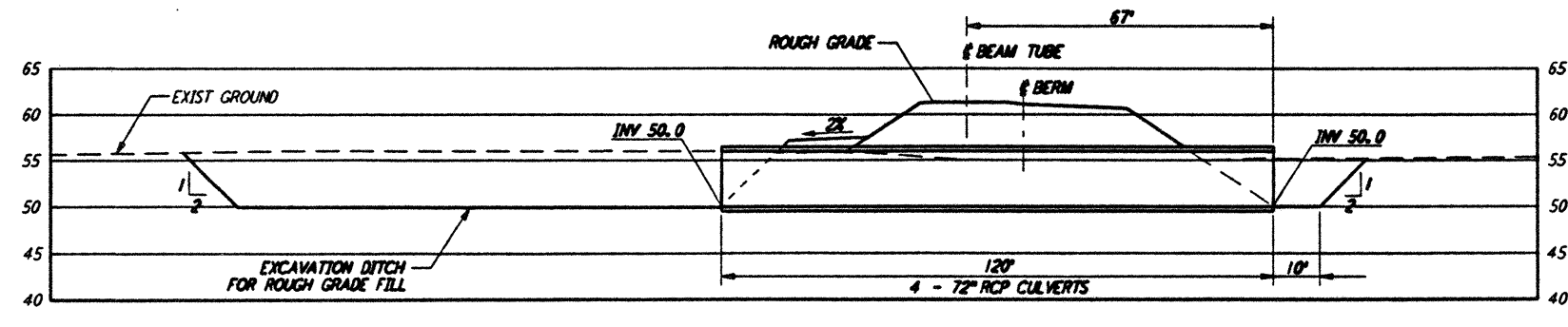

STA 43+80.00 (B)
 SCALES: HORIZ: 1" = 20'
 VERT: 1" = 2'

- NOTES:
- SEE SHEET RG-C-002 FOR GENERAL NOTES, LEGEND AND ABBREVIATIONS.
 - SEE SHEET RG-C-004 FOR TYPICAL SECTIONS AND DETAILS.

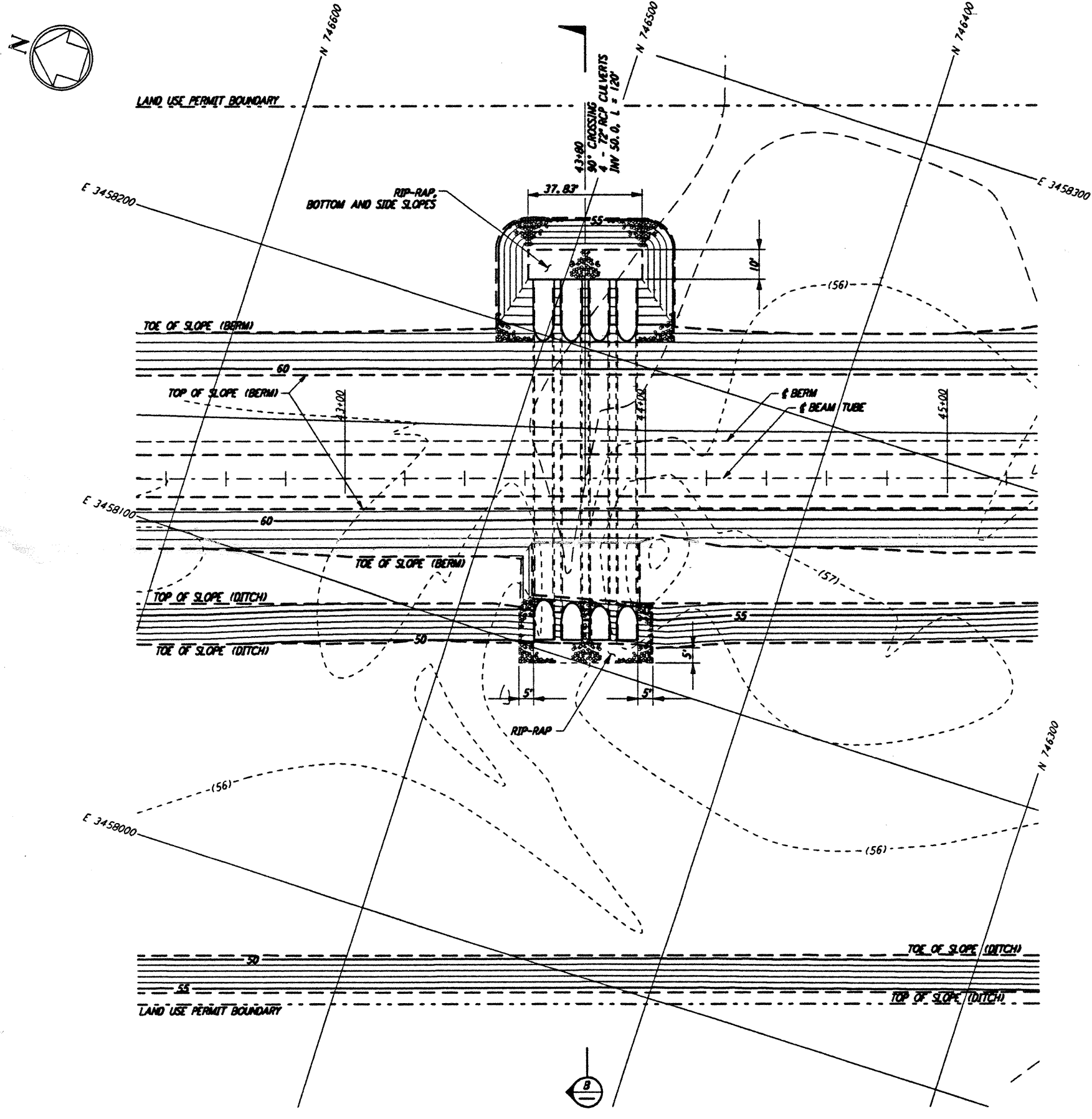
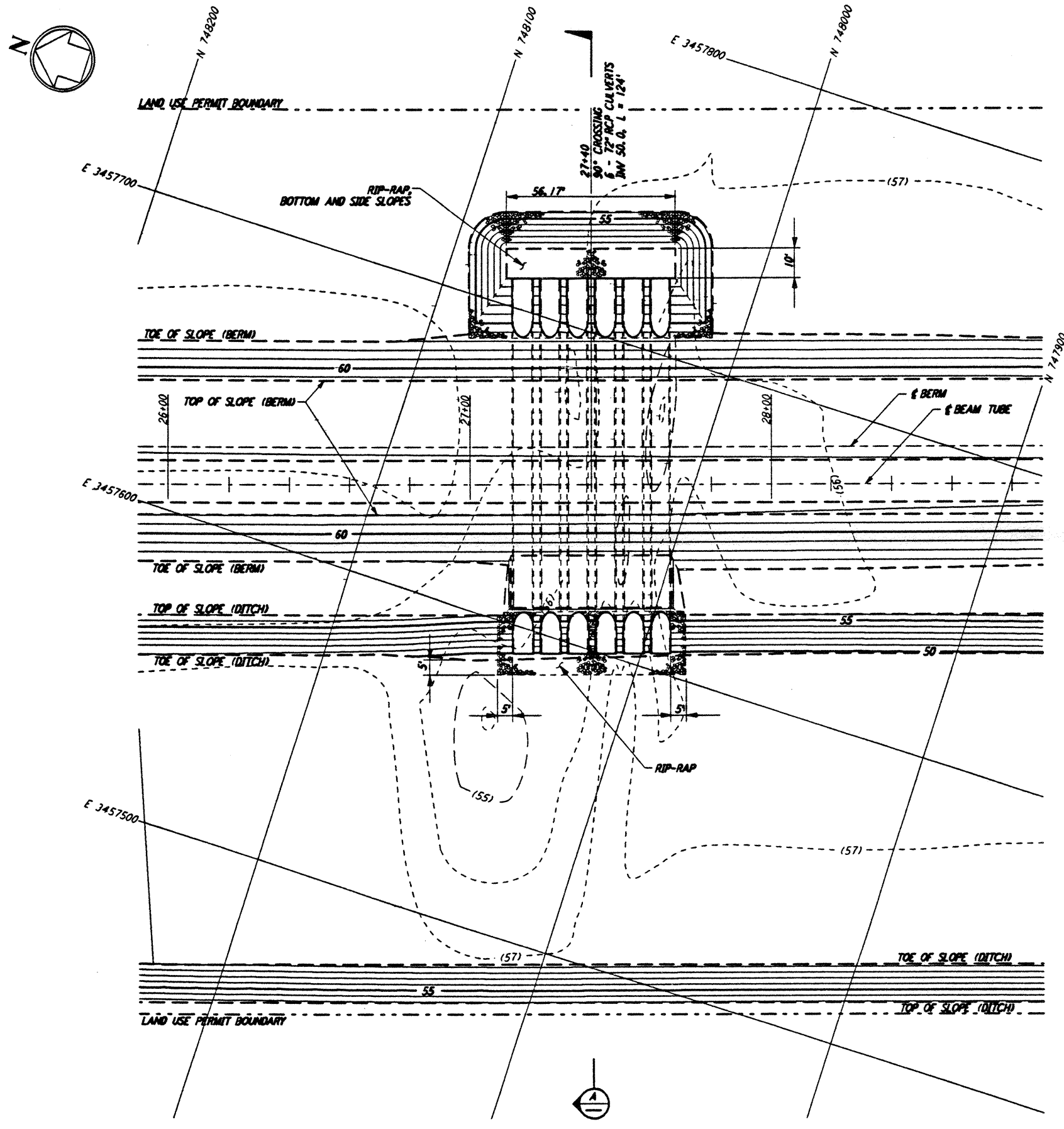

This document and the design it covers are the property of PARSONS. They are loaned only with the borrower's expressed written agreement that they will not be reproduced, copied, loaned, exhibited, or used in any other way, except by written consent from PARSONS to the borrower.

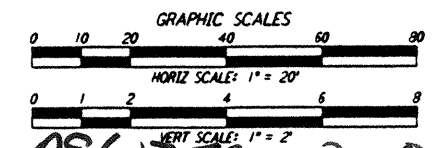

L160-0961752-00-0

NO.	DATE	APPRO BY	DESCRIPTION OF REVISION
9			
8			
7			
6			
5			
4			
3			
2			
1	8/28/95	(TJ/T)	ISSUED FOR BID

NO.	DATE	APPRO BY	ISSUED FOR
9	8/11/95		
8			
7			
6			
5			
4			
3			
2			
1	8/28/95	(TJ/T)	ISSUED FOR BID

DATE	BY	DESCRIPTION
8/11/95	WRB	DRAWN
8/8/95	MCP	CHECKED
8/2/95	(S)	ENGINEER
8/28/95	(S)	PROJ MGR

PARSONS
 100 WEST WALNUT STREET
 PASADENA, CALIFORNIA

LIGO
 CALIFORNIA INSTITUTE OF TECHNOLOGY
 MASSACHUSETTS INSTITUTE OF TECHNOLOGY

**LASER INTERFEROMETER
 GRAVITATIONAL-WAVE OBSERVATORY
 ROUGH GRADING - LIVINGSTON, LA**

TITLE: **ROUGH GRADING
 SOUTHEAST ARM
 CULVERT GENERAL
 ARRANGEMENTS**

AS NOTED: **PP150969 8094**

PROJECT NUMBER: **RG-C-047**

5

4

3

2

LIGORGF3.BOR

Fri Aug 25 15:22:14 1995 s3-v18b2 J:\PLOTS\QUEUES\18E2\CE047A.PRF