

NOTES:

1. MAKE FROM 10.75Ø x .50 WALL ALUMINUM TUBING TYPE 6061-T6
2. ABRASIVE CLEAN INNER AND OUTER SURFACES

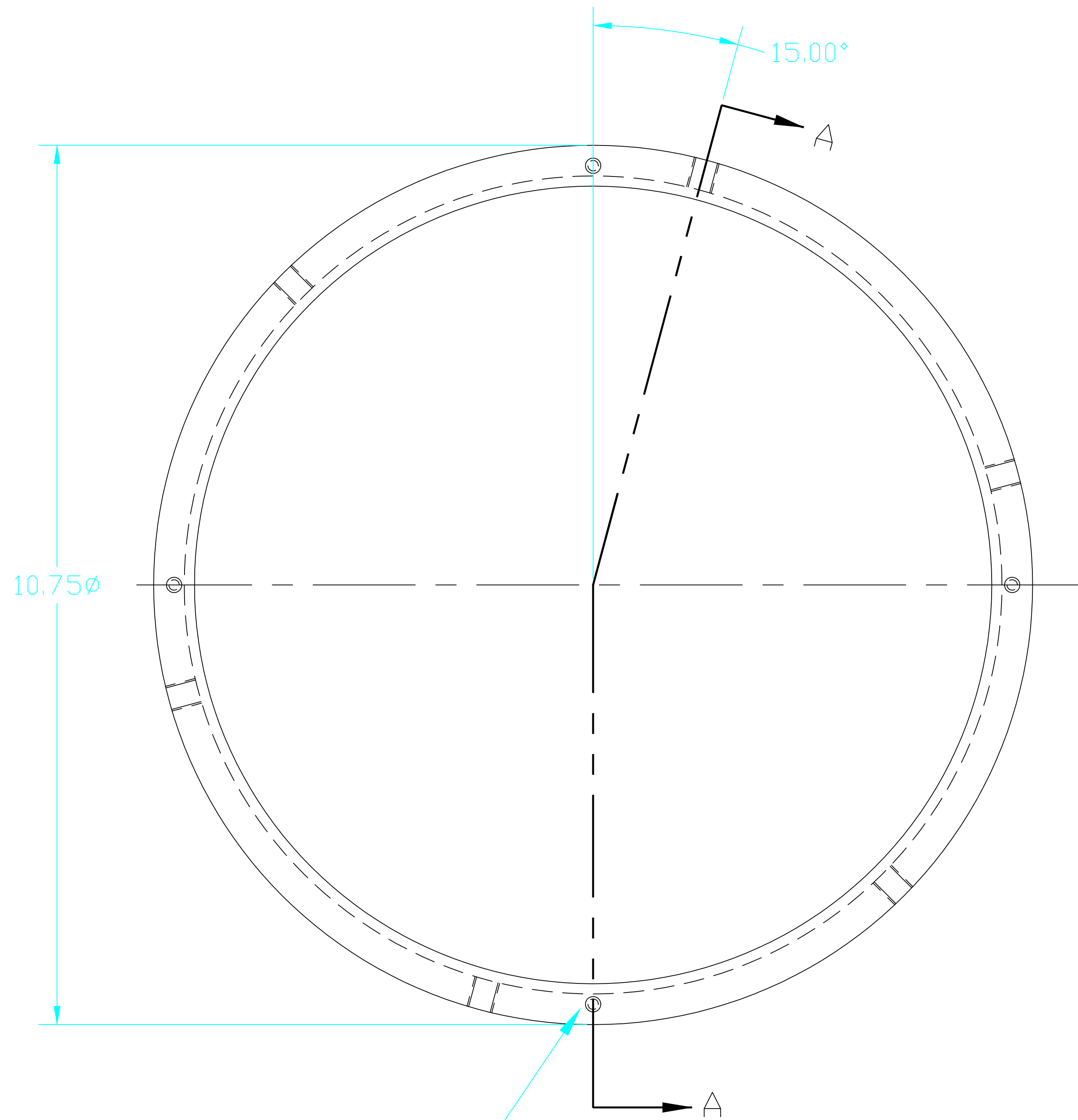

1/4-20 UNC-2B
x .50 DP (4) HOLES
EQ. SP ON A 10.25Ø B.C.

5/16-18 UNC-2B
THRU (6) PLC'S

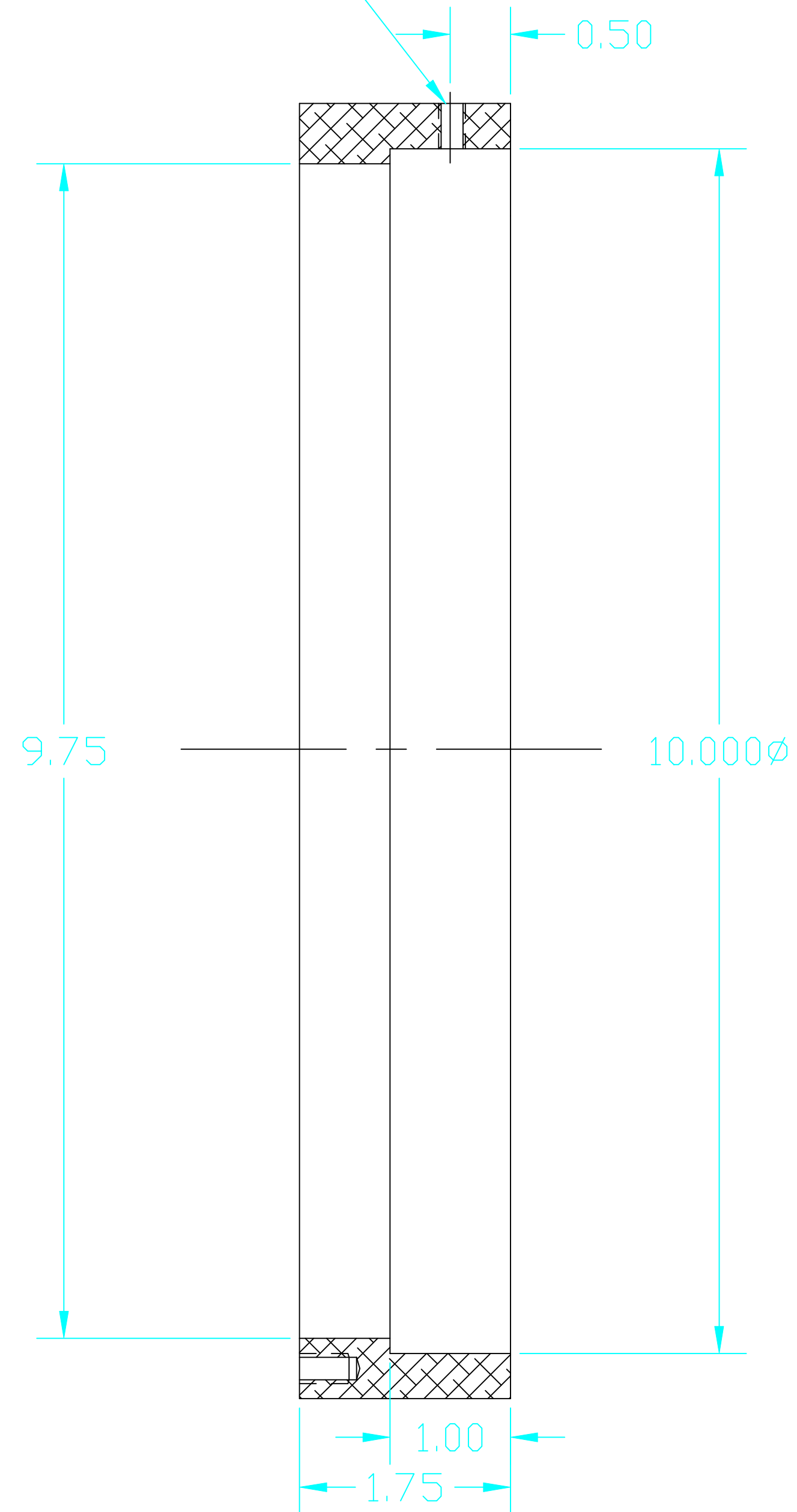

		UNLESS OTHERWISE SPECIFIED DIMENSIONS ARE IN INCHES													LIGO CALIFORNIA INSTITUTE OF TECHNOLOGY MASSACHUSETTS INSTITUTE OF TECHNOLOGY				
		TOLERANCES:		FINISHED SURFACE RMS												VIEWPORT MOUNT - ASC ALIGNMENT			
		FRACTIONAL ± 1/16(.16)		63												-			
		ANGULAR ± 1°		BREAK CORNERS IN: OUT: .02												-			
		TWO PLACE DECIMAL ± .01(.025)		REMOVE ALL BURRS												-			
		THREE PLACE DECIMAL ± .005(.013)														-			
		MATERIAL: 6061-T6 ALUM		HEAT TREAT: NONE		FINISH: NONE												-	
		USED ON: D970211-00-D		NEXT ASS'Y: -												-			
DWG. NO.		DESCRIPTION		REV		ISSUE DESCRIPTION										SCALE			
REFERENCE DRAWINGS																FULL			
																1 of 1			
																1 of 1			

CAD FILE		SIZE		DWG. NO.	
D970216-A.dwg		D		D970216-A-D	
SCALE		FULL		SHEET	
		1		1 of 1	