

8

7

6

5

4

3

2

1

REVISIONS			
REV.	DESCRIPTION	DATE	APPROVED

D

D

C

C

B

B

A

A

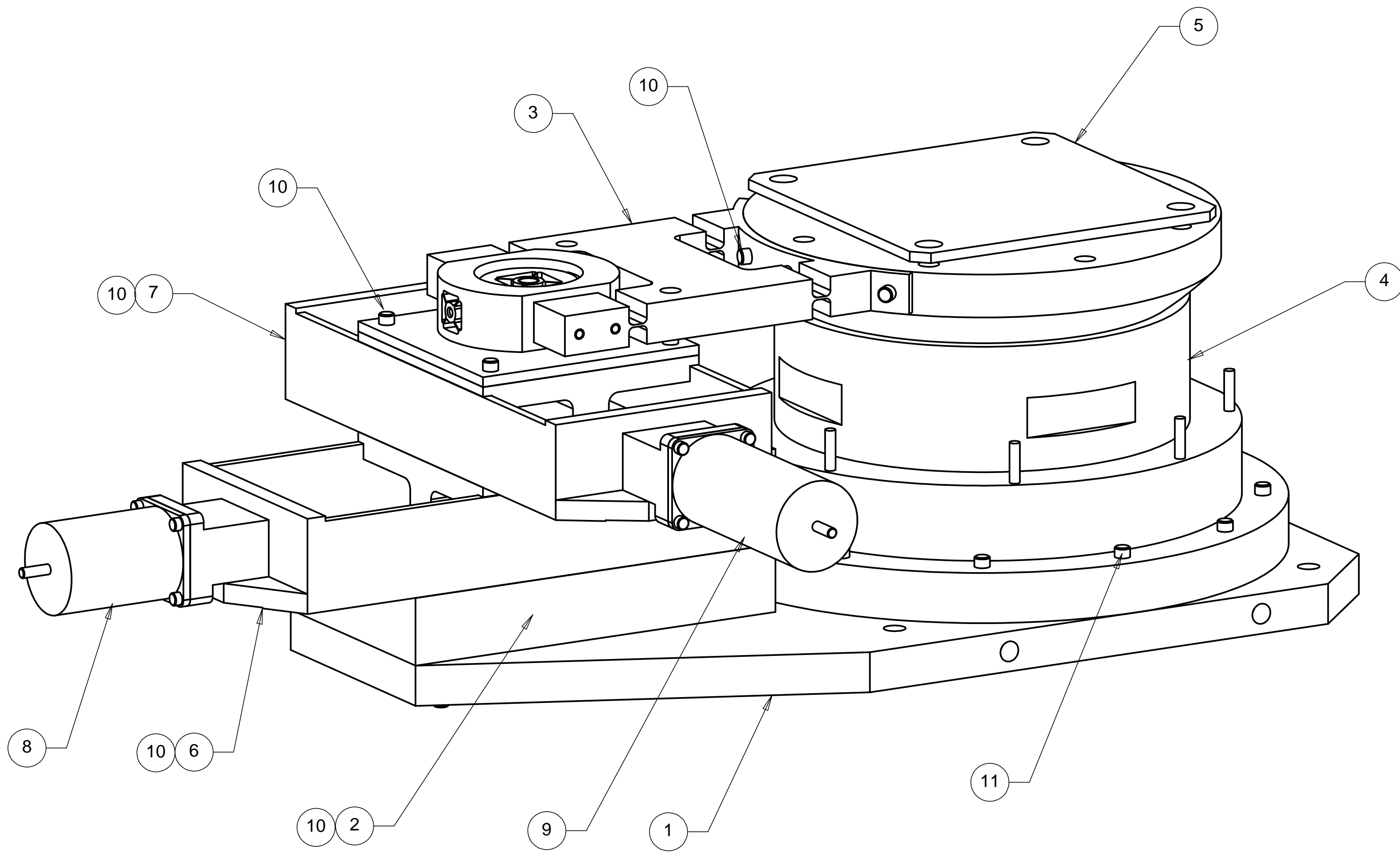

ITEM NO.	QTY.	PART NO.	DESCRIPTION
1	1	D972119-1	AIRBEARING MOUNTING PLATE
2	1	D972105-1	TRANSLATOR STACK SPACER BLOCK
3	1	D972141-1	FLEXURAL PIVOT ASSEMBLY
4	1	D972106-1	AIRBEARING ASSEMBLY
5	1	D972142-1	SPHERICAL BEARING PLATE
6	1	406004LN-ES-D1L2C2M1E1W1	DAEDAL, TRANSLATION TABLE ASSEMBLY
7	1	406004LN-ES-D1L2C5M2E1W1	DAEDAL, TRANSLATION TABLE ASSEMBLY
8	1	NEMA 23, S23	IDC STEPPER MOTER
9	1	NEMA 34, S33T	IDC STEPPER MOTER
10	26		SOC. HD. CAP SCREW, 1/4-20 UNC-2B X 1 LG, SST
11	12		SOC. HD. CAP SCREW, 1/4-20 UNC-2B X 2.0 LG, SST

PARTS LIST

UNLESS OTHERWISE SPECIFIED: DIMENSIONS ARE IN INCHES -TOLERANCES-		CAD GENERATED DRAWING, DO NOT MANUALLY UPDATE DO NOT SCALE DRAWING		<b>HYTEC, INC</b>	
DECIMALS .XX = +/- .03 .XXX = +/- .010	ANGULAR = +/- .30° SURFACE FINISH = 250			TITLE LIGO BSC COARSE X-Y DRIVEN TRANSLATION ASSEMBLY	
FINISH		SIGNATURE	DATE	DWG. NO.	SIZE SHEET NO.
		DESIGNED	ROGER L. SMITH	5-28-97	D972102 D 1 of 1
		DRAWN	ROGER L. SMITH	5-28-97	
		CHECKED	HARRY SALAZAR	8-5-97	
		ENGR.	T. THOMPSON	9-16-97	
PART NO. <b>D972102-1</b>		APPROVED	T. THOMPSON	9-16-97	SCALE 1/2 REVISION

8

7

6

5

4

3

2

1