

8

7

6

5

4

3

2

1

| REVISIONS |                                    |          |             |
|-----------|------------------------------------|----------|-------------|
| REV.      | DESCRIPTION                        | DATE     | APPROVED    |
| A         | SEE ECN# D972201-A FOR CHANGE LIST | 11-03-97 | T. THOMPSON |
| B         | SEE ECN# D972201-B FOR CHANGE LIST | 04-29-98 | T. THOMPSON |

D

D

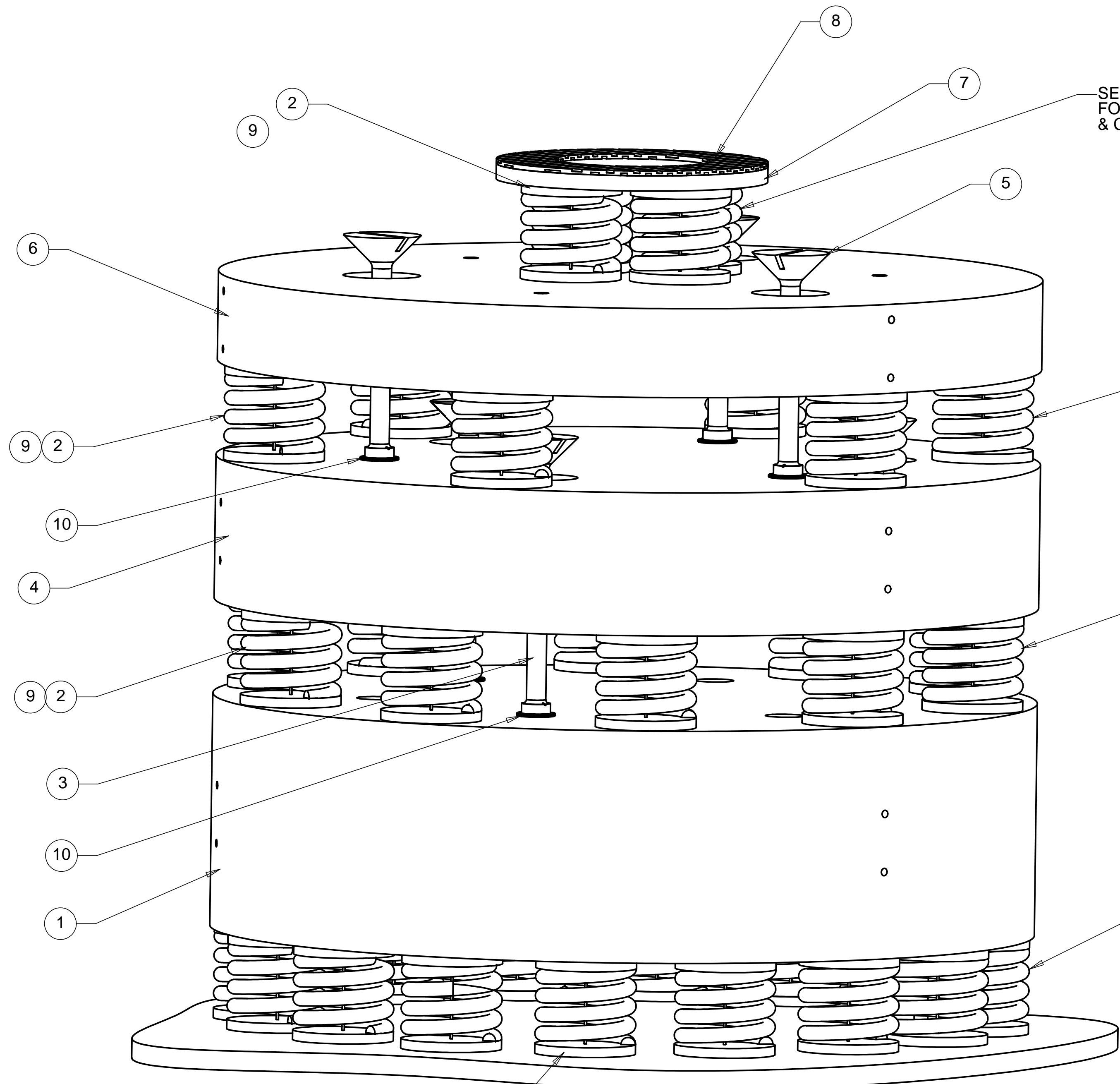

SEE SHEET D2 VIEW D-D FOR SPRING PLACEMENT & COUNT AT THIS LEVEL

SEE SHEET D2 VIEW C-C FOR SPRING PLACEMENT & COUNT AT THIS LEVEL

SEE SHEET D2 VIEW B-B FOR SPRING PLACEMENT & COUNT AT THIS LEVEL

SEE SHEET D2 VIEW A-A FOR SPRING PLACEMENT & COUNT AT THIS LEVEL

ASSEMBLE ON SUPPORT TABLE

C

C

B

B

A

A

| ITEM NO. | QTY. | PART NO.  | DESCRIPTION                         |
|----------|------|-----------|-------------------------------------|
| 1        | 1    | D972213-1 | LEG ELEMENT #1                      |
| 2        | 36   | D972218-1 | COIL SPRING                         |
| 3        | 3    | D972217-1 | LEG SCREW #1                        |
| 4        | 1    | D972214-1 | LEG ELEMENT #2                      |
| 5        | 3    | D972217-3 | LEG SCREW #2                        |
| 6        | 1    | D972215-1 | LEG ELEMENT #3                      |
| 7        | 1    | D972216-1 | SHIM                                |
| 8        | 1    | D972714-1 | VITON SHIM                          |
| 9        | 72   | D972219-1 | COIL SPRING SEAT                    |
| 10       | 6    | WFV-38    | VENTED WASHER, U-C COMPONENTS, INC. |

PARTS LIST

|   |  |  |         |  |            |
|---|--|--|---------|--|------------|
| UNLESS OTHERWISE SPECIFIED:<br>DIMENSIONS ARE IN INCHES<br>-TOLERANCES- |  | CAD GENERATED DRAWING,<br>DO NOT MANUALLY UPDATE<br>DO NOT SCALE DRAWING |         | <b>HYTEC, INC</b><br>TITLE<br>LIGO<br>BSC<br>ISOLATION STACK<br>LEG ASSEMBLY |            |
| DECIMALS<br>.XX = +/- .03<br>.XXX = +/- .010                            | ANGULAR = +/- .30°<br>SURFACE FINISH = 250 | SIGNATURE  | DATE    |  |            |
| FINISH  |  | DESIGNED<br>ROGER L. SMITH   | 5-28-97 | D972201  | D 1 of 2   |
|   |  | DRAWN<br>ROGER L. SMITH  | 5-28-97 |  |            |
| PART NO.<br>D972201-1   |  | CHECKED<br>HARRY SALAZAR   | 8-8-97  |  |            |
|   |  | ENGR.<br>T. THOMPSON   | 8-11-97 |  |            |
|   |  | APPROVED<br>T. THOMPSON  | 8-11-97 | SCALE 1/2  | REVISION B |

8

7

6

5

4

3

2

1

8

7

6

5

4

3

2

1

| REVISIONS |                                    |          |             |
|-----------|------------------------------------|----------|-------------|
| REV.      | DESCRIPTION                        | DATE     | APPROVED    |
| B         | SEE ECN# D972201-B FOR CHANGE LIST | 04-29-98 | T. THOMPSON |

D

D

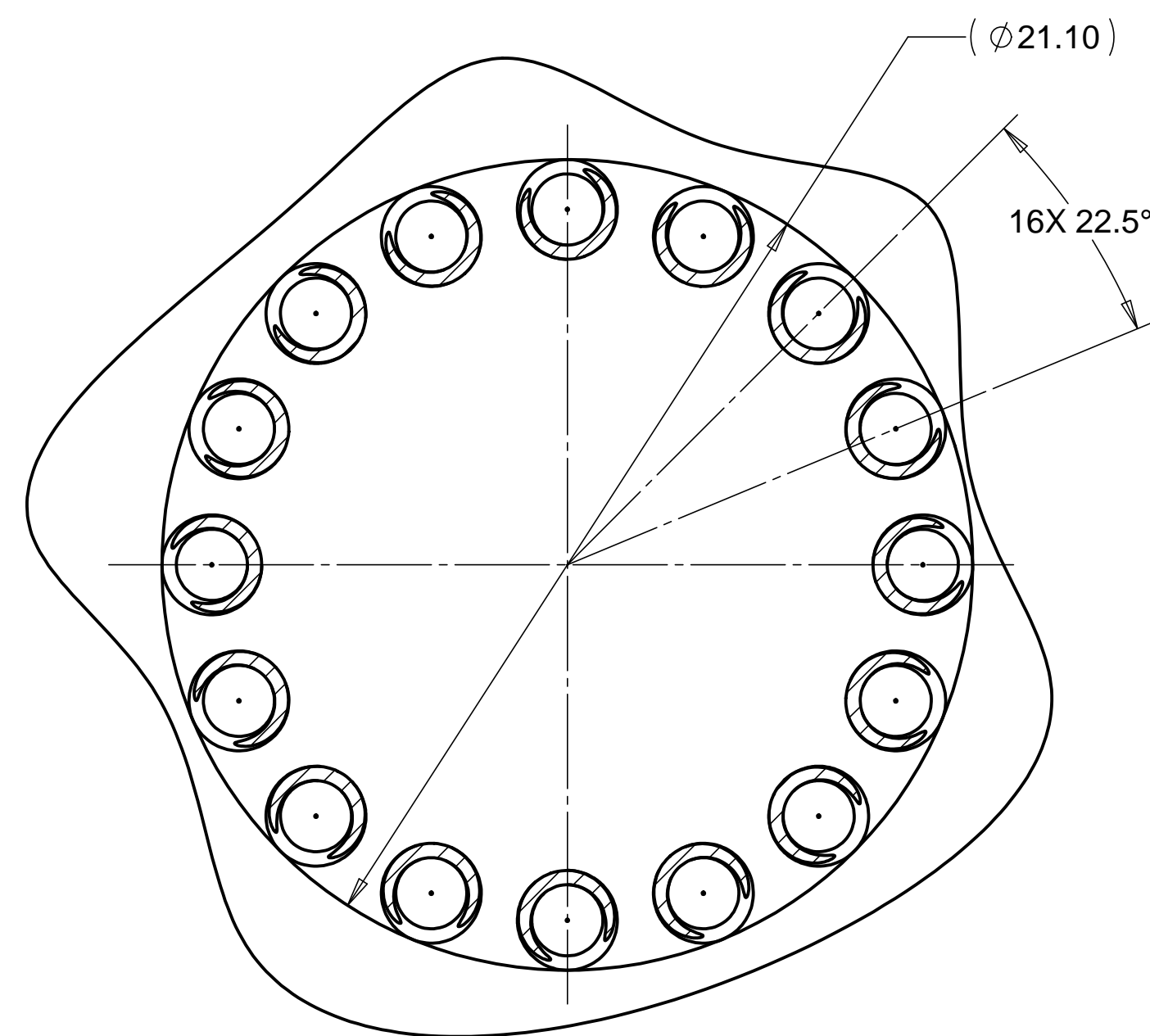

VIEW A-A

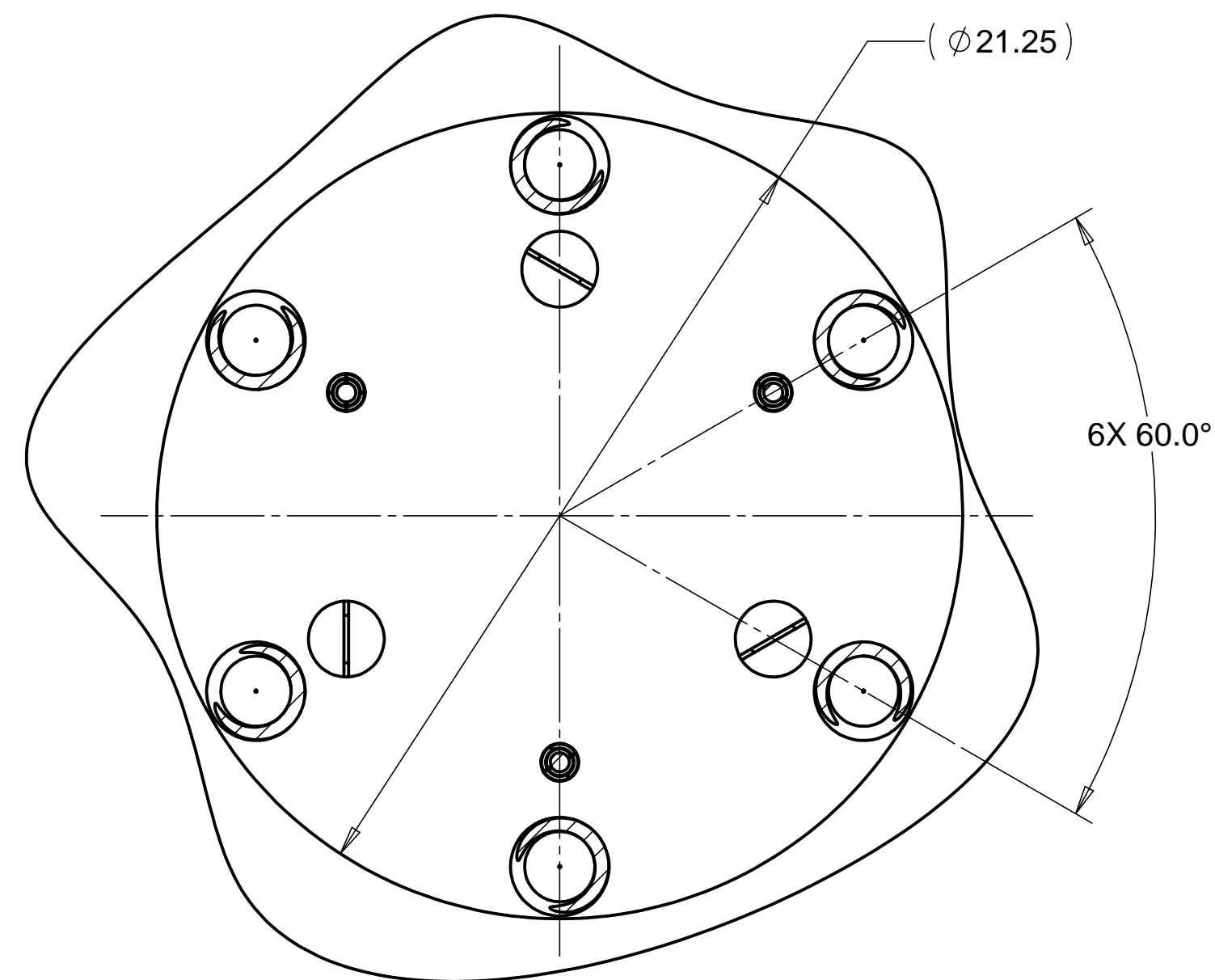

VIEW C-C

C

C

B

B

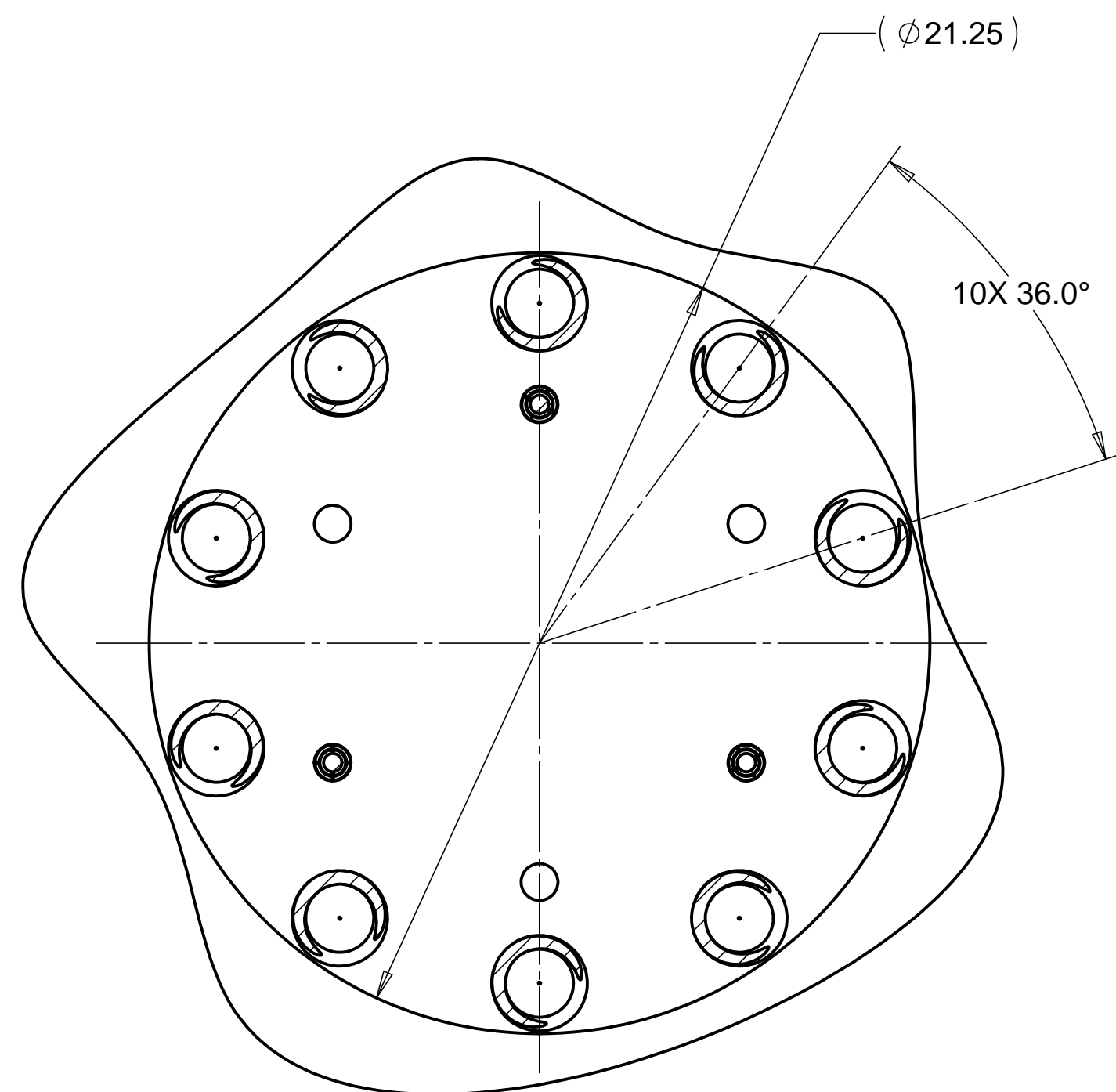

VIEW B-B

B

B

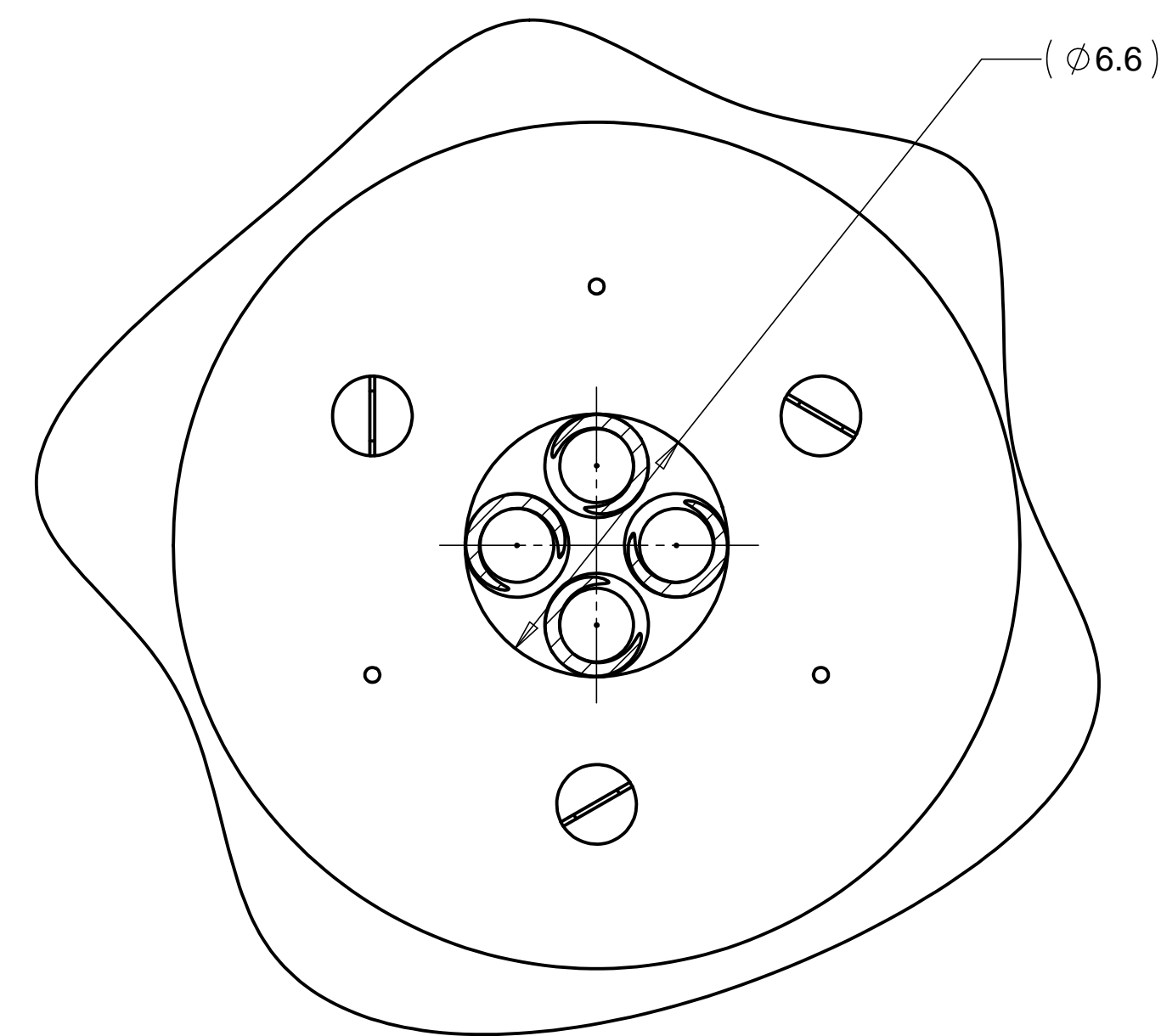

VIEW D-D

A

A

8

7

6

5

4

3

2

1

| PARTS LIST  |                      |  |                |
|---|----------------------|--|----------------|
| UNLESS OTHERWISE SPECIFIED:<br>DIMENSIONS ARE IN INCHES<br>-TOLERANCES- |                      | CAD GENERATED DRAWING,<br>DO NOT MANUALLY UPDATE<br>DO NOT SCALE DRAWING     |                |
| DECIMALS  | ANGULAR = +/- .30°   | <b>HYTEC, INC</b><br>TITLE<br>LIGO<br>BSC<br>ISOLATION STACK<br>LEG ASSEMBLY |                |
| .X = +/- .1   |                      |  |                |
| .XX = +/- .03   | SURFACE FINISH = 250 | DESIGNED   | ROGER L. SMITH |
| .XXX = +/- .010   |                      | DRAWN  | ROGER L. SMITH |
| PART NO.  |                      | CHECKED  | T. THOMPSON    |
| <b>D972201-1</b>  |                      | ENGR.  | T. THOMPSON    |
|   |                      | APPROVED   | T. THOMPSON    |
|   |                      | DATE   | 10-22-97       |
|   |                      | DATE   | 04-29-98       |
|   |                      | DATE   | 05-04-98       |
|   |                      | DATE   | 05-04-98       |
|   |                      | DATE   | 05-04-98       |
|   |                      | SCALE  | 1/4            |
|   |                      | SIZE   | D              |
|   |                      | SHEET NO.  | 2 of 2         |
|   |                      | REVISION   | B              |

8

7

6

5

4

3

2

1