

8 7 6 5 4 3 2 1

| REVISIONS | | | |
|-----------|---------------------------------------|---------|----------|
| REV. | DESCRIPTION | DATE | APPROVED |
| A | CHANGED LENGTH, CHANGED ASSORTED DIMS | 3-20-98 | WKM |

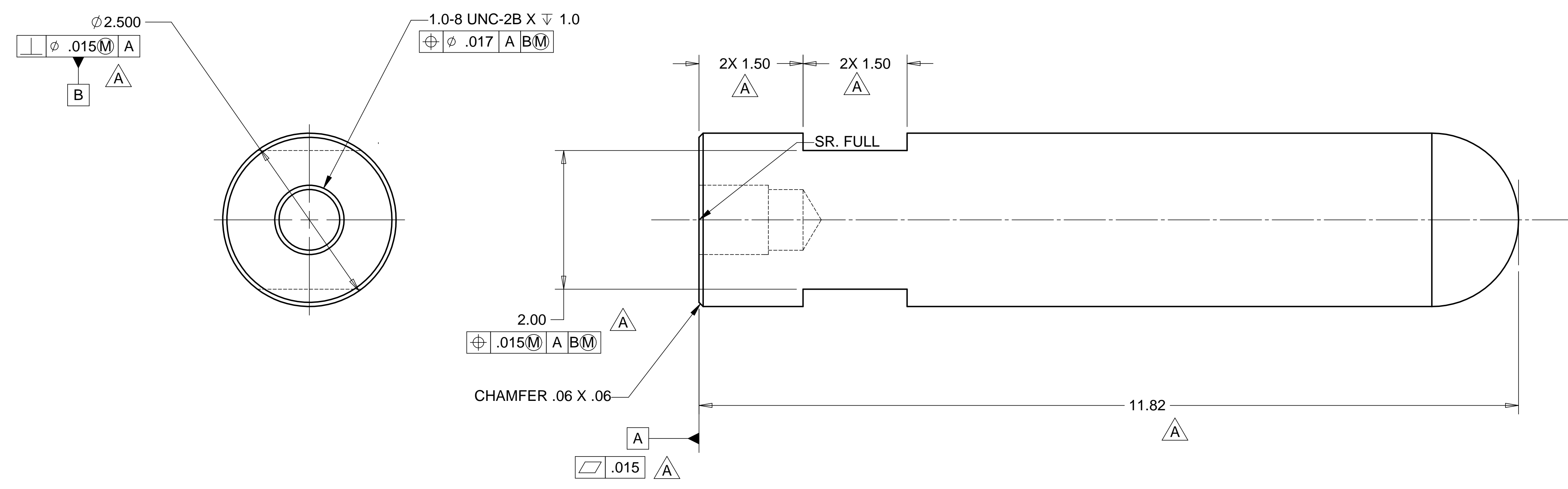
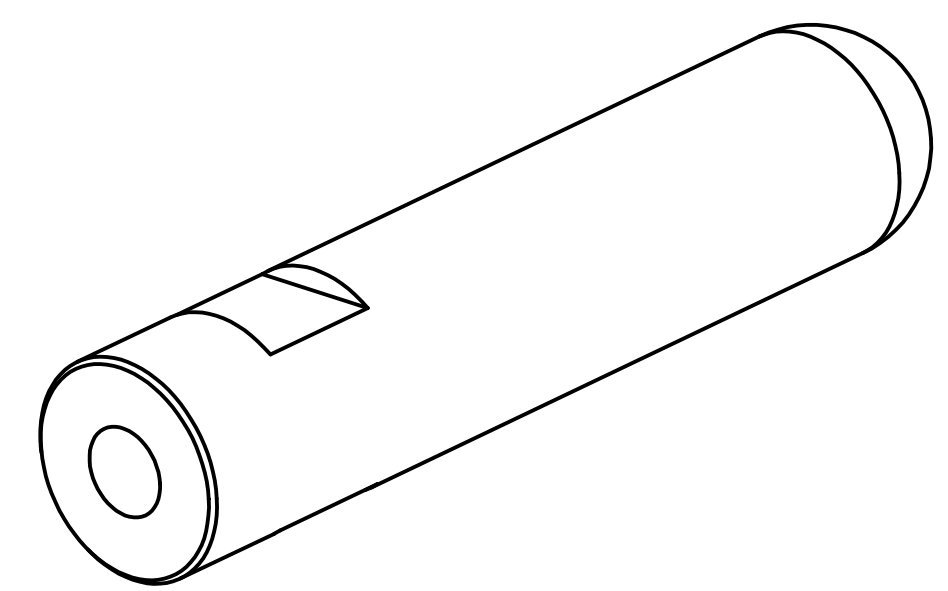

NOTES: UNLESS OTHERWISE SPECIFIED

- ALL DIMENSIONS IN INCHES
- DIMENSIONS AND TOLERANCING PER ASME Y14.5M-1994
- SURFACE TEXTURE PER ANSI/ASME B 46.1-1985
- REMOVE ALL BURRS AND BREAK SHARP EDGES TO A MAXIMUM OF .015
- ALL INSIDE CORNERS TO BE .015 RADIUS MAX
- COUNTERSINK 82 DEGREES ALL TAPPED HOLES TO MAJOR DIAMETER
- COUNTERSINK 82 DEGREES APPROXIMATELY .015 DEEP ALL DRILLED HOLES
- PARTS TO BE THOROUGHLY CLEANED TO REMOVE ALL OIL, GREASE, DIRT AND CHIPS
- PART NUMBER (DRAWING NO. PLUS DASH NO. PLUS SERIAL NO.) TO BE CLEARLY MARKED ON THE PART ITSELF.
- PART WEIGHS 16.0 Lbs.

| ITEM NO. | QTY. | DESCRIPTION | MATERIAL |
|----------|------|----------------|---------------------|
| 1 | 1 | ROD, 2.50 DIA. | 303 STAINLESS STEEL |

| PARTS LIST | | | |
|---|--|---|-----------|
| UNLESS OTHERWISE SPECIFIED: DIMENSIONS ARE IN INCHES -TOLERANCES- | | CAD GENERATED DRAWING, DO NOT MANUALLY UPDATE DO NOT SCALE DRAWING | |
| DECIMALS .XX = +/- .03 .XXX = +/- .010 | ANGULAR = +/- .30° SURFACE FINISH = 250 | HYTEC, INC TITLE BSC CENTERING JIG POINT CONTACT DETAIL | |
| FINISH | SIGNATURE | DATE | DWG. NO. |
| | DESIGNED W. K. MILLER | 1-14-98 | SIZE |
| | DRAWN GERALD BUSTOS | 3-14-98 | SHEET NO. |
| | CHECKED HARRY SALAZAR | 3-14-98 | D972421 |
| | ENGR. T. THOMPSON | 3-14-98 | D |
| | APPROVED T. THOMPSON | 3-14-98 | 1 of 1 |
| PART NO. D972421-1 | SCALE 1/1 | REVISION A | |

8 7 6 5 4 3 2 1