

8 7 6 5 4 3 2 1

REVISIONS			
REV.	DESCRIPTION	DATE	APPROVED
A	ADDED PIN HOLE	3-18-98	WKM

D

D

C

C

B

B

A

A

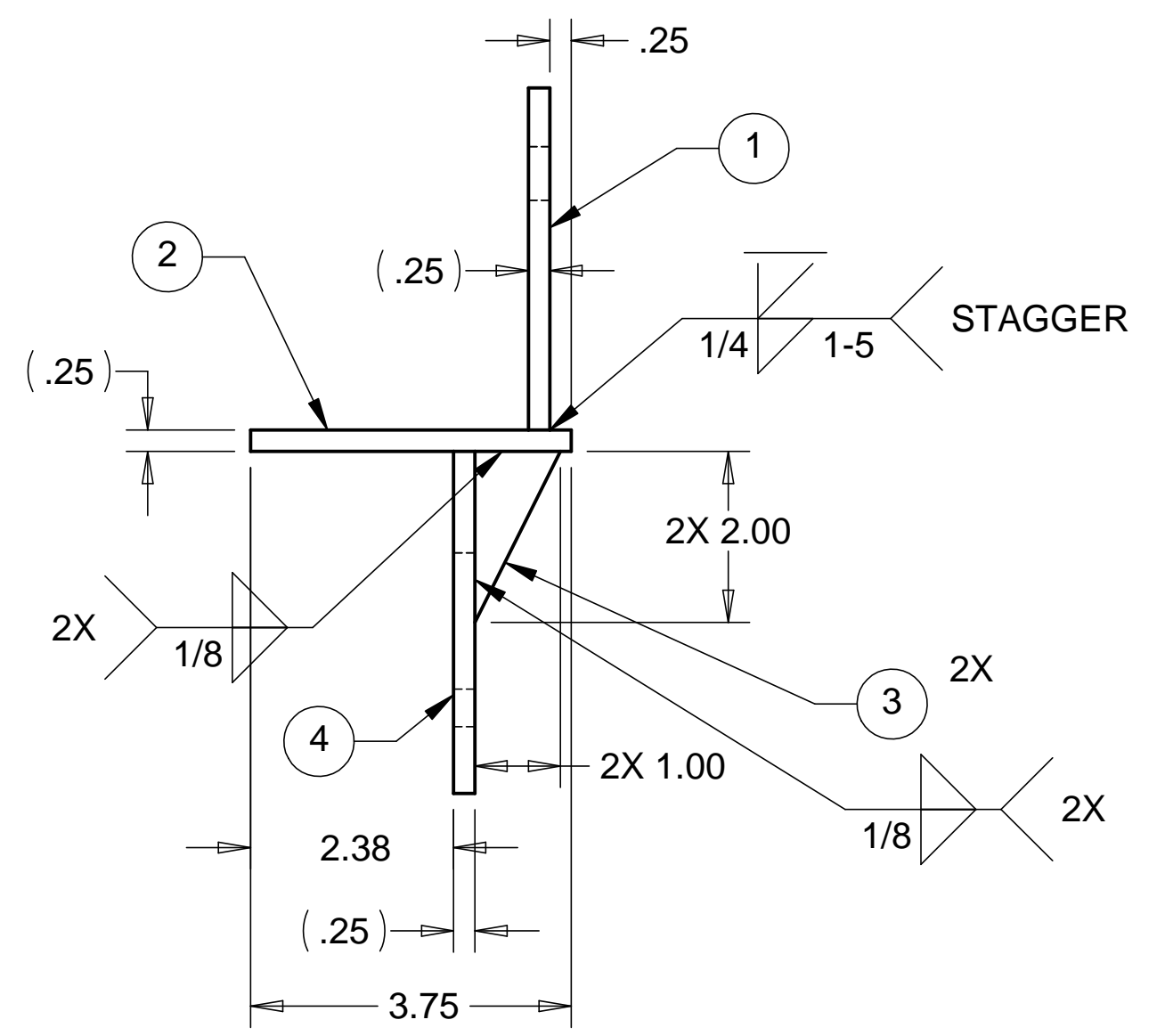
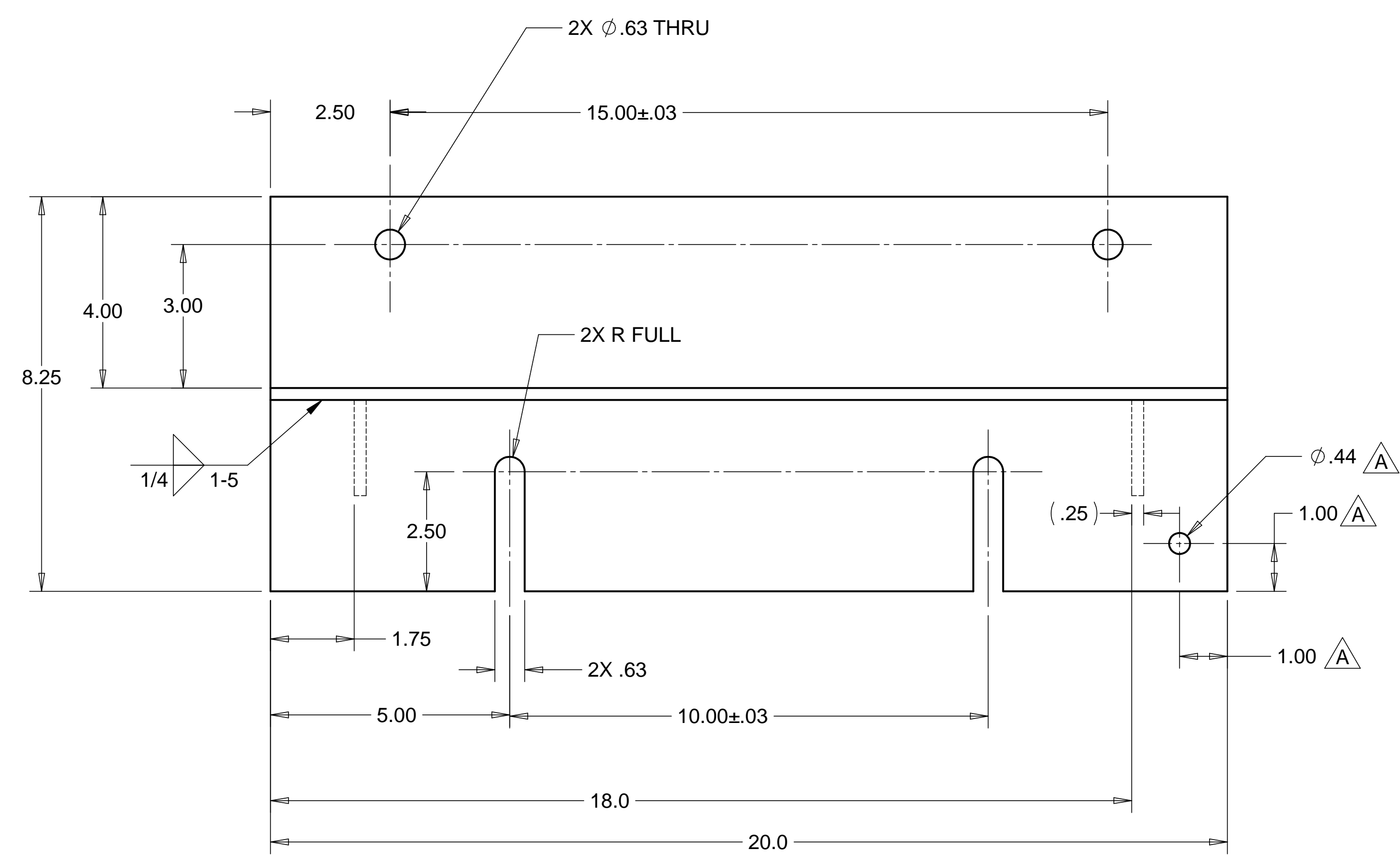

NOTES: UNLESS OTHERWISE SPECIFIED

- ALL DIMENSIONS IN INCHES
- DIMENSIONS AND TOLERANCING PER ASME Y14.5M-1994
- SURFACE TEXTURE PER ANSI/ASME B 46.1-1985
- REMOVE ALL BURRS AND BREAK SHARP EDGES TO A MAXIMUM OF .015
- ALL INSIDE CORNERS TO BE .015 RADIUS MAX
- COUNTERSINK 82 DEGREES ALL TAPPED HOLES TO MAJOR DIAMETER
- COUNTERSINK 82 DEGREES APPROXIMATELY .015 DEEP ALL DRILLED HOLES
- PARTS TO BE THOROUGHLY CLEANED TO REMOVE ALL OIL, GREASE, DIRT AND CHIPS
- PART NUMBER (DRAWING NO. PLUS DASH NO. PLUS SERIAL NO.) TO BE CLEARLY MARKED ON THE PART ITSELF.
- PART WEIGHS 19.1 Lbs.

ITEM NO.	QTY.	DESCRIPTION	MATERIAL
1	1	1/4" THK VERTICAL PLATE	ALUM. 6061-T6
2	1	1/4" THK HORIZONTAL PLATE	ALUM. 6061-T6
3	2	1/4" THK TRIANGULAR GUSSET	ALUM. 6061-T6
4	1	1/4" THK VERTICAL PLATE	ALUM. 6061-T6

PARTS LIST			
UNLESS OTHERWISE SPECIFIED: DIMENSIONS ARE IN INCHES -TOLERANCES-		CAD GENERATED DRAWING, DO NOT MANUALLY UPDATE DO NOT SCALE DRAWING	
DECIMALS .XX = +/- .03 .XXX = +/- .010	ANGULAR = +/- .30° SURFACE FINISH = 250	HYTEC, INC TITLE HAM CROSSBEAM SPACER SUPPORT	
FINISH			
PART NO. D972922-1	DESIGNED	W. K. MILLER	12/12/97
	DRAWN	W. K. MILLER	12/12/97
	CHECKED	HARRY SALAZAR	2/2/98
	ENGR.	T. THOMPSON	2/2/98
	APPROVED	T. THOMPSON	2/2/98
SCALE 1/2		DWG. NO. D972922	SIZE SHEET NO. D 1 of 1
		REVISION A	

8 7 6 5 4 3 2 1