

8 7 6 5 4 3 2 1

REVISIONS		DATE	APPROVED
REV.	DESCRIPTION		
A	ADDED TYPICAL NOTE	3-13-98	WKM

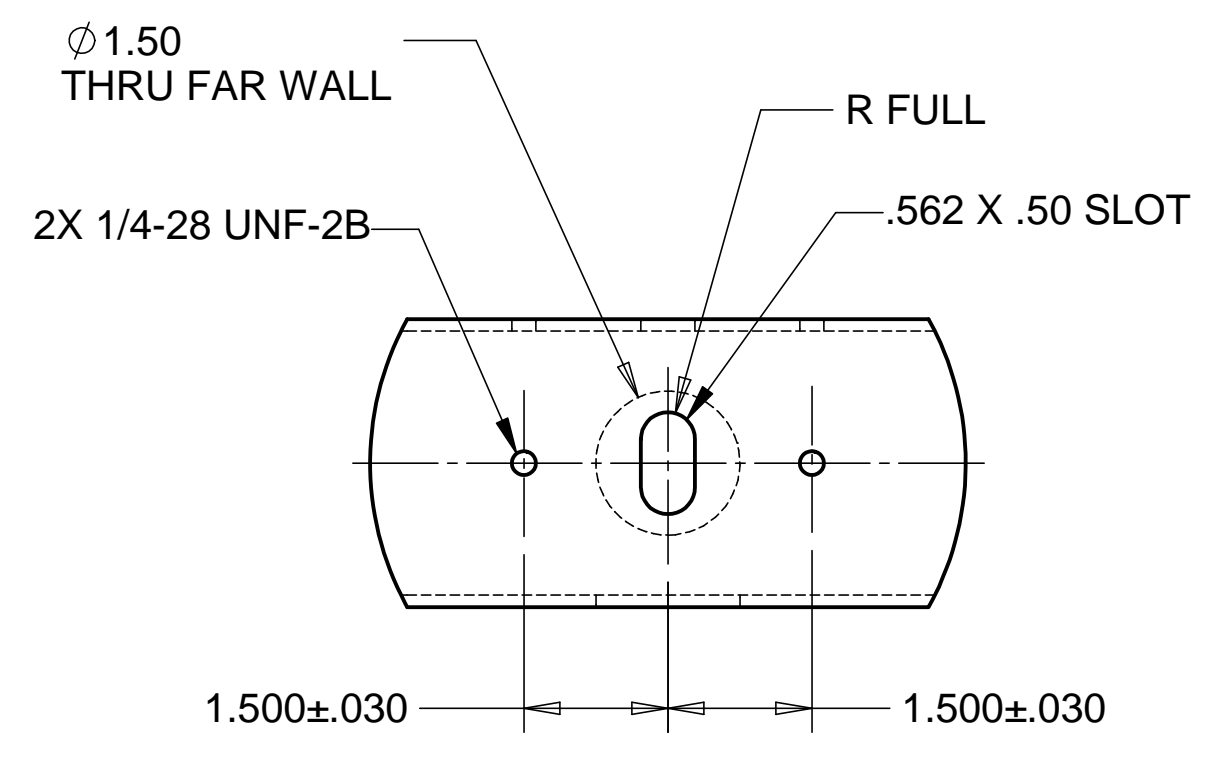

DETAIL A
SCALE 1/2
TYP. 18 PLACES

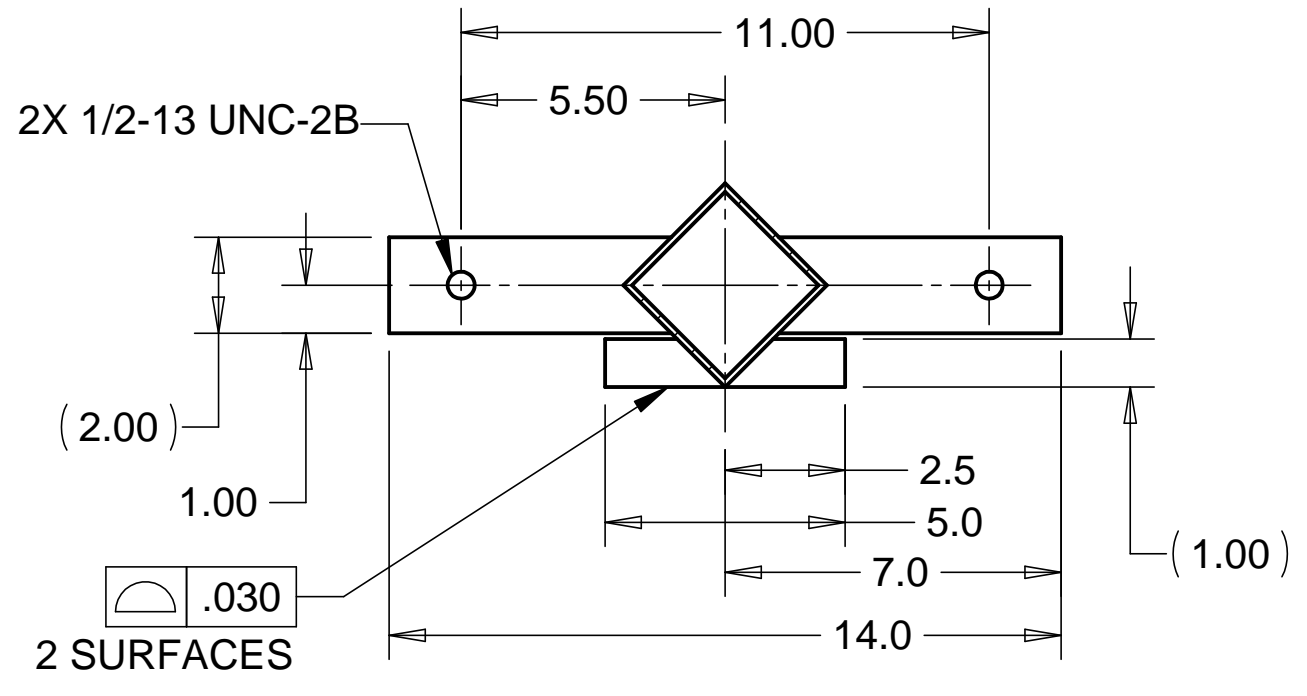

SECTION B-B
SCALE 1 : 4
ROTATED 45°
TYP. 3 PLACES

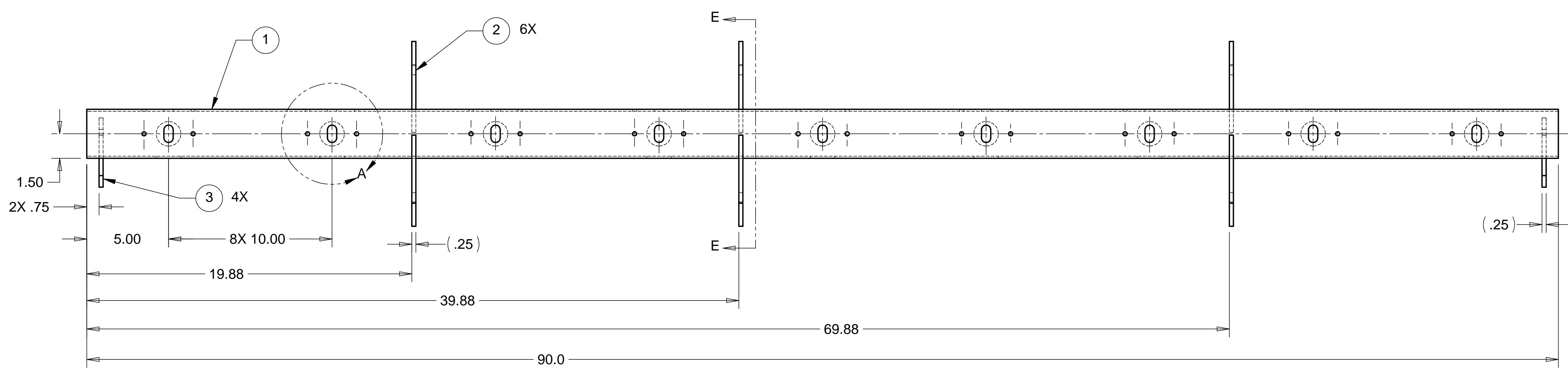
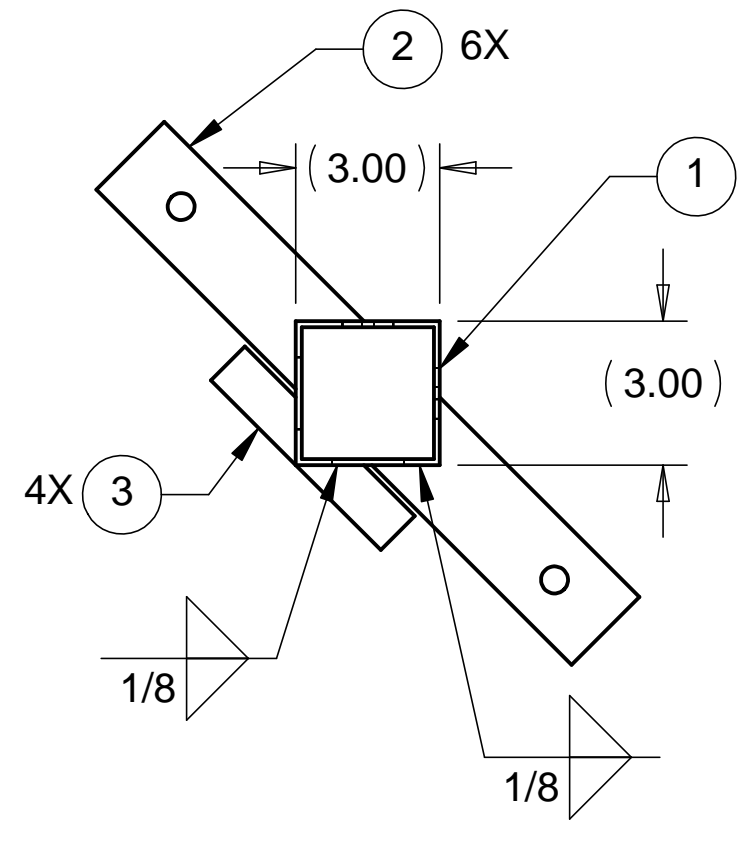
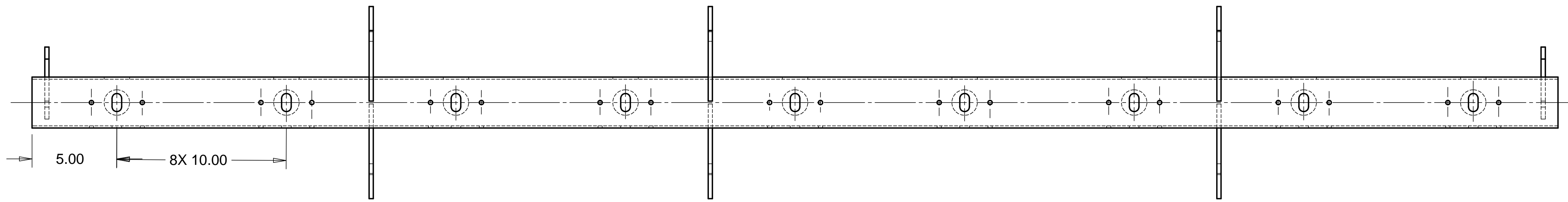

NOTES: UNLESS OTHERWISE SPECIFIED

- ALL DIMENSIONS IN INCHES
- DIMENSIONS AND TOLERANCING PER ASME Y14.5M-1994
- SURFACE TEXTURE PER ANSI/ASME B 46.1-1985
- REMOVE ALL BURRS AND BREAK SHARP EDGES TO A MAXIMUM OF .015
- ALL INSIDE CORNERS TO BE .015 RADIUS MAX
- COUNTERSINK 82 DEGREES ALL TAPPED HOLES TO MAJOR DIAMETER
- COUNTERSINK 82 DEGREES APPROXIMATELY .015 DEEP ALL DRILLED HOLES
- PARTS TO BE THOROUGHLY CLEANED TO REMOVE ALL OIL, GREASE, DIRT AND CHIPS
- PART NUMBER (DRAWING NO. PLUS DASH NO. PLUS SERIAL NO.) TO BE CLEARLY MARKED ON THE PART ITSELF.
- PART WEIGHS 41 Lbs.
- PRIMER (ALL VISIBLE SURFACES): SHERMAN WILLIAMS INDUSTRIAL WASH PRIMER PG062.
- PAINT (ALL VISIBLE SURFACES): SHERMAN WILLIAMS POLANE T POLYURETHANE COLOR JUNCTION YELLOW, COLOR #F63TXY-0310-4352.

ITEM NO.	QTY.	DESCRIPTION	MATERIAL
1	1	TUBING, 3 X 3 X .125 WALL	A36 STEEL
2	6	FLAT STOCK, 2.0 X .25 THK	A36 STEEL
3	4	FLAT STOCK, 1.0 X .25 THK	A36 STEEL

PARTS LIST				HYTEC, INC		
UNLESS OTHERWISE SPECIFIED: DIMENSIONS ARE IN INCHES -TOLERANCES-		CAD GENERATED DRAWING, DO NOT MANUALLY UPDATE DO NOT SCALE DRAWING		TITLE HAM ROLLER SYSTEM BEAM		
DECIMALS X = +/- .1 .XX = +/- .060	ANGULAR = +/- .30° SURFACE FINISH = 250	SIGNATURE	DATE	DWG. NO.	SIZE SHEET NO.	
FINISH		DESIGNED	W. K. MILLER	12/18/97	D972931 D 1 of 1	
PART NO. D972931-1		DRAWN	W. K. MILLER	12/18/97		
		CHECKED	HARRY SALAZAR	2/2/98		
		ENGR.	T. THOMPSON	2/2/98		
		APPROVED	T. THOMPSON	2/2/98	SCALE 1/4	REVISION A

8 7 6 5 4 3 2 1