

NOTES: (UNLESS OTHERWISE SPECIFIED)

1. BREAK ALL SHARP EDGES.

2. CHAMFER INSIDE SLOT AS REQUIRED FOR WELDING ON NEXT ASSEMBLY.

REV	DATE	DRAWN BY	CHECKED	DCC	DCN/DESCRIPTION
A	8/28/98	C. Conley			E980218-00/INITIAL RELEASE

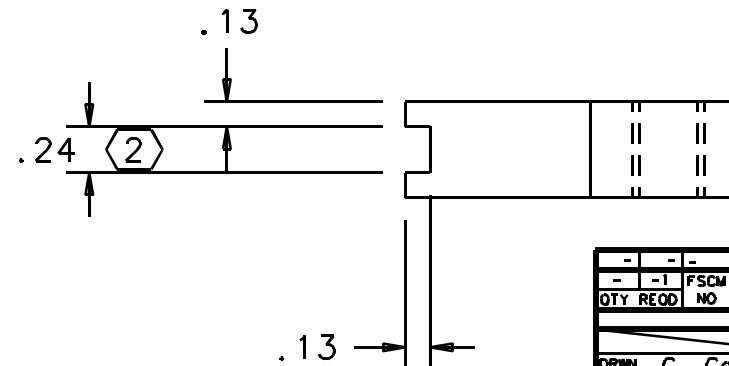
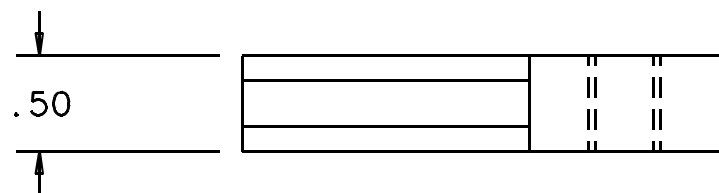
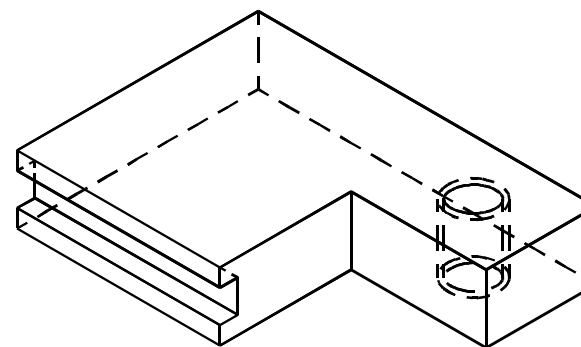
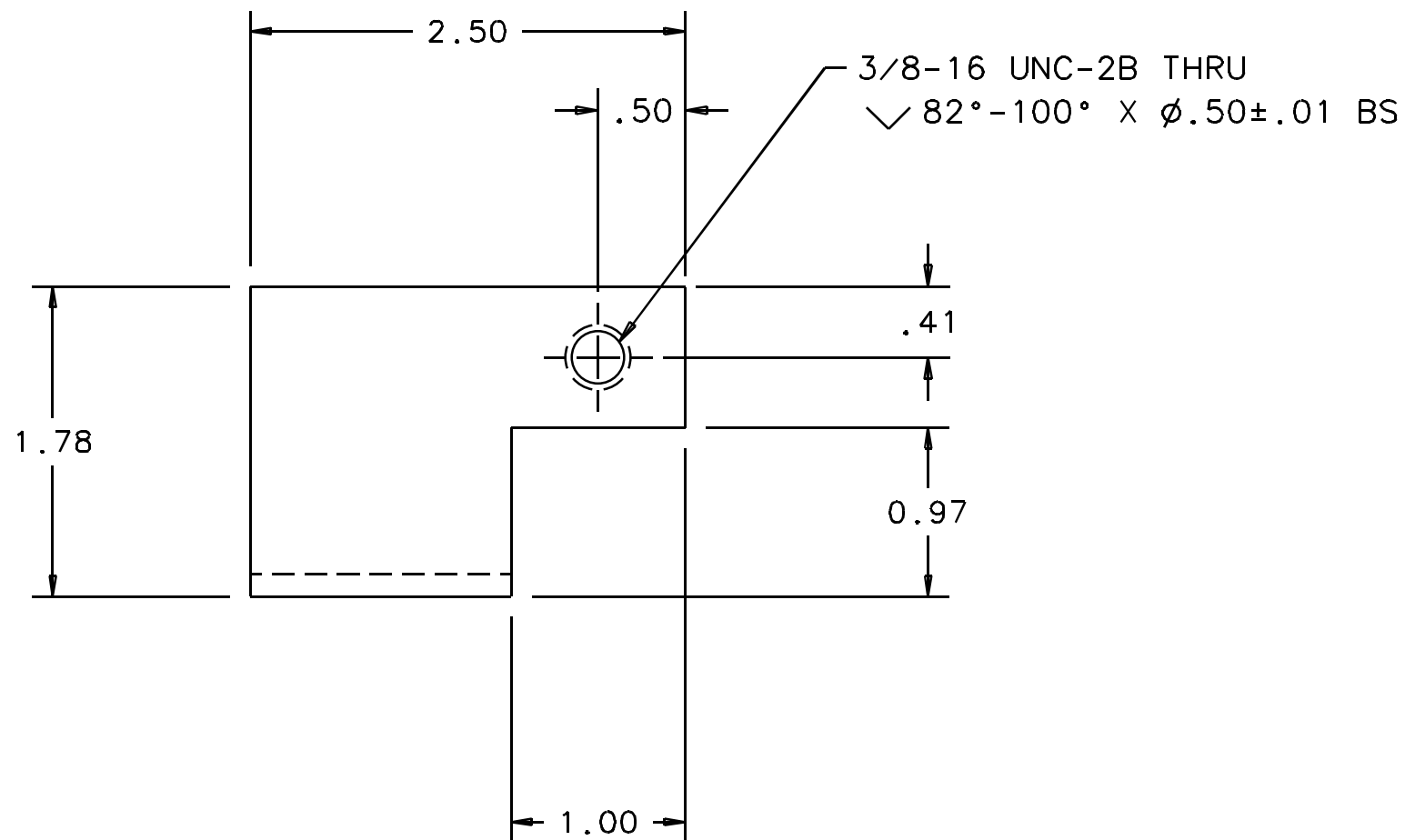

QTY	REQD	FSCM NO	PART OR IDENTIFYING NO	PART	NOMENCLATURE OR DISCRPTION	MATERIAL SPECIFICATION	ITEM NO
-	-	-	-	-	-	304 STAINLESS STEEL	-
PARTS LIST							
DRWN	C. Conley	DATE	8/28/98	CALIFORNIA INSTITUTE OF TECHNOLOGY MASSACHUSETTS INSTITUTE OF TECHNOLOGY <b>LIGO PROJECT</b>			
CHKD		1-Deas CAD file: D980373_A.dwg					
ENGR		dcc file: D980373-A.pdf					
APPD		TITLE					
UNLESS OTHERWISE SPECIFIED:						LOS3 SAFETY STOP BRACKET, FRONT	
DIMENSION UNITS ARE inch (mm)						SCALE: 1/1	
TOLERANCES ARE:						SIZE DRAWING NUMBER	
X.XXX: ± 0.005						B D980373-A-D	
X.XX: ± 0.01						SHEET	
ANGLES: ± 0.5°						1 OF 1	
NEXT ASSEMBLY: D970508							