

REV	DATE	DRAWN BY	CHECKED	DCC	DCN/DESCRIPTION

A

B

C

D

NOTES: (UNLESS OTHERWISE SPECIFIED)  
 1. DIMENSIONS IN INCHES.  
 2. BREAK ALL SHARP EDGES.  
 3. REMOVE CUT-OFF BURR.

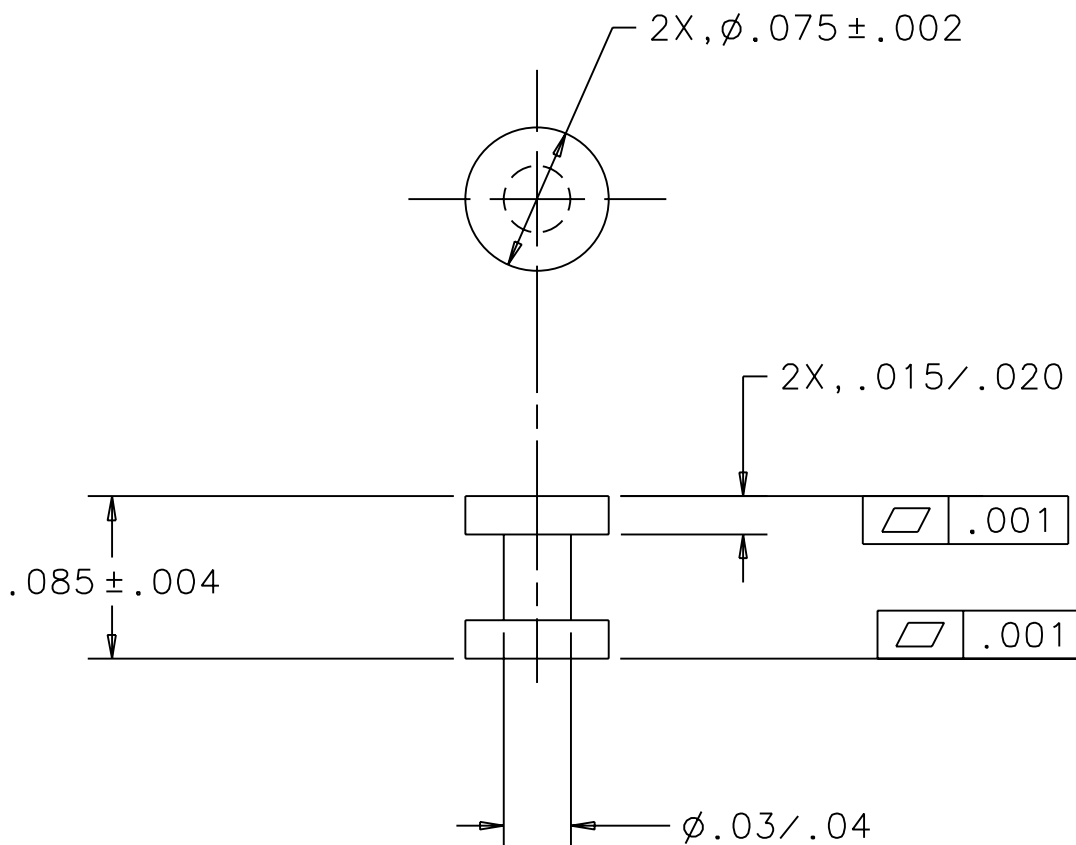

QTY REQD	FSCM NO	PART OR IDENTIFYING NO	NOMENCLATURE OR DESCRIPTION			MATERIAL SPECIFICATION	ITEM NO			
PARTS LIST										
UNLESS OTHERWISE SPECIFIED DIMENSIONS ARE IN in (mm) TOLERANCES ARE: FRACTIONS DECIMALS 0.XX = ±0.01 0.XXX = ±0.005 ANGLES = ±0.5° DO NOT SCALE DRAWING		APPROVALS		DATE	<b>L I G O</b> CALIFORNIA INSTITUTE OF TECHNOLOGY MASSACHUSETTS INSTITUTE OF TECHNOLOGY					
		DRAWN	J. Hazel	GROUP	4/14/97	TITLE				
		CHECKED				DUMBBELL STANDOFF, STAINLESS				
						SIZE	DWG NO.	D990205	REV	00
MATERIAL	304 STAINLESS									
FINISH	16/									
SCALE	10/1		FILENAME	/home/dcc/docs/D990205.pdf			SHEET	1 OF 1		