

NOTES: (UNLESS OTHERWISE SPECIFIED)

1. FILLETS: R.015 MAX.
2. BREAK ALL SHARP EDGES .01/.02 X 45°.
3. THIS DRAWING HAS BEEN RENUMBERED. THE PREVIOUS DRAWING NUMBER IS 1205445.
4. MAKE FROM 1/4-20 X .63 VENTED, SILVER PLATED STAINLESS STEEL SOCKET HEAD CAP SCREW.
5. MACHINE ALL OVER $\sqrt{64}$.

REV	DATE	DRAWN BY	CHECKED	DCC	DCN/DESCRIPTION
A	9/20/99	C. CONLEY			E990349-00-R

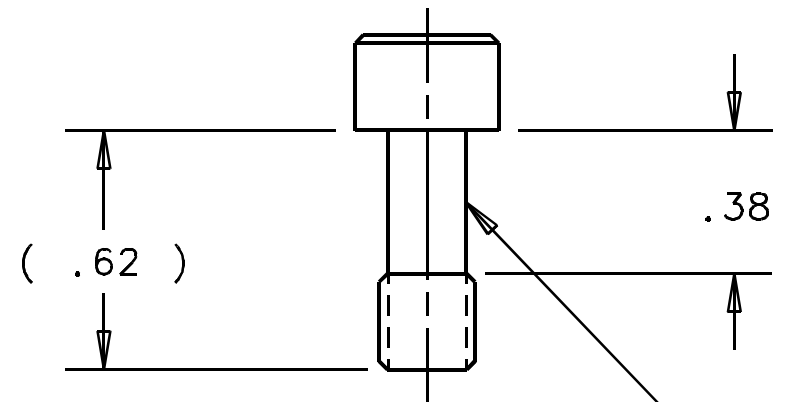

UNDERCUT TO
ROOT DIA

DATE	CALIFORNIA INSTITUTE OF TECHNOLOGY MASSACHUSETTS INSTITUTE OF TECHNOLOGY		
DRWN	LIGO PROJECT		
CHKD	I-Deas CAD file: D990562-A.dwg		
ENGR	dcc file: D990562-A.pdf		
APPD	TITLE		
UNLESS OTHERWISE SPECIFIED:			
DIMENSION UNITS ARE inch (mm)			
TOLERANCES ARE:			
X.XXX: ± .01			
X.XX: ± .005			
ANGLES: ± .25°			
NEXT ASSEMBLY:			
SCALE: 1/8	SIZE B	DRAWING NUMBER	SHEET
		D990562-A	1 OF 1