

A
2781
ELEVATION LOOKING EAST
SCALE: 1/2" = 1'-0"

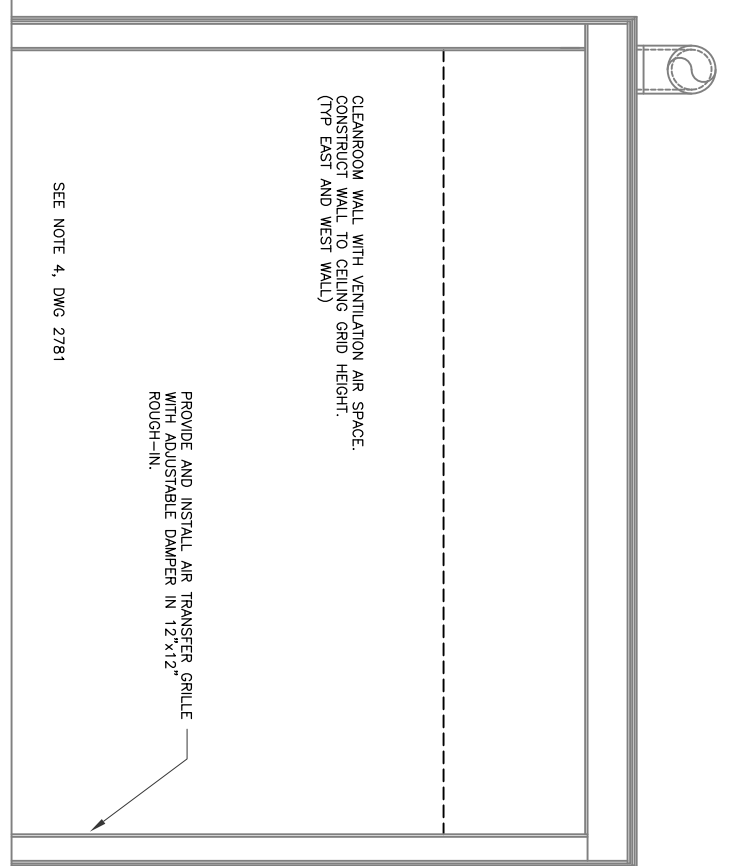

B
2781
ELEVATION LOOKING SOUTH
SCALE: 1/2" = 1'-0"

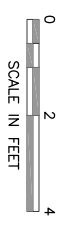
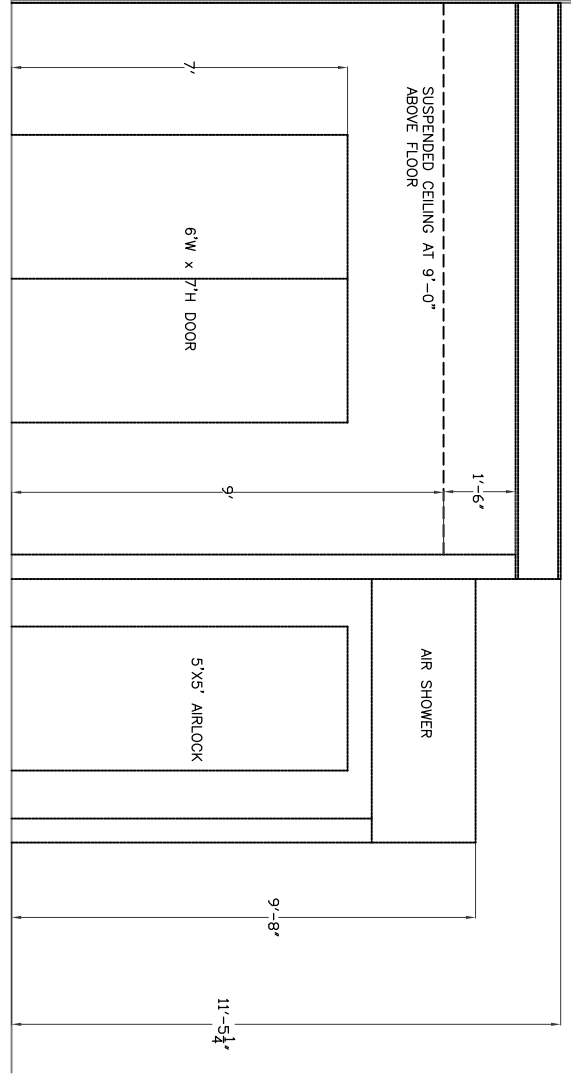
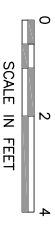

DRAWING: LIGO-D1002786

PRINTED BY: GI on 11/4/2010 3:10 PM

DRAWING NUMBER
2786
REV
v2

CALIFORNIA INSTITUTE OF TECHNOLOGY
LIGO HANFORD OBSERVATORY
HIBBS ENGINEERING, INC.
KENNEWICK, WASHINGTON

H2 LASER AREA ENCLOSURE
ANTE-ROOM
ELEVATIONS
PROJECT NUMBER: 1036.01
CAD FILE: 1036M01

© 2010 Hibbs Engineering, Inc.
DRAWN BY: GLH
CHECKED BY:
DESIGN A/E DESIGN GM
HEI APPROVAL

REV No	DATE	BY	DESCRIPTION	APPROVED
v2	11/3/10	GLH	ADJUST ROOM LENGTH AND BACKGROUND DWG.	

DATE OF ISSUE