

NOTES CONTINUED:

REV.	DATE	DCN #	DRAWING TREE #
v1	06 MAR 2011	E1100335	E1000874
v2	17 JUN 2011	E1100335	-
-	-	-	-

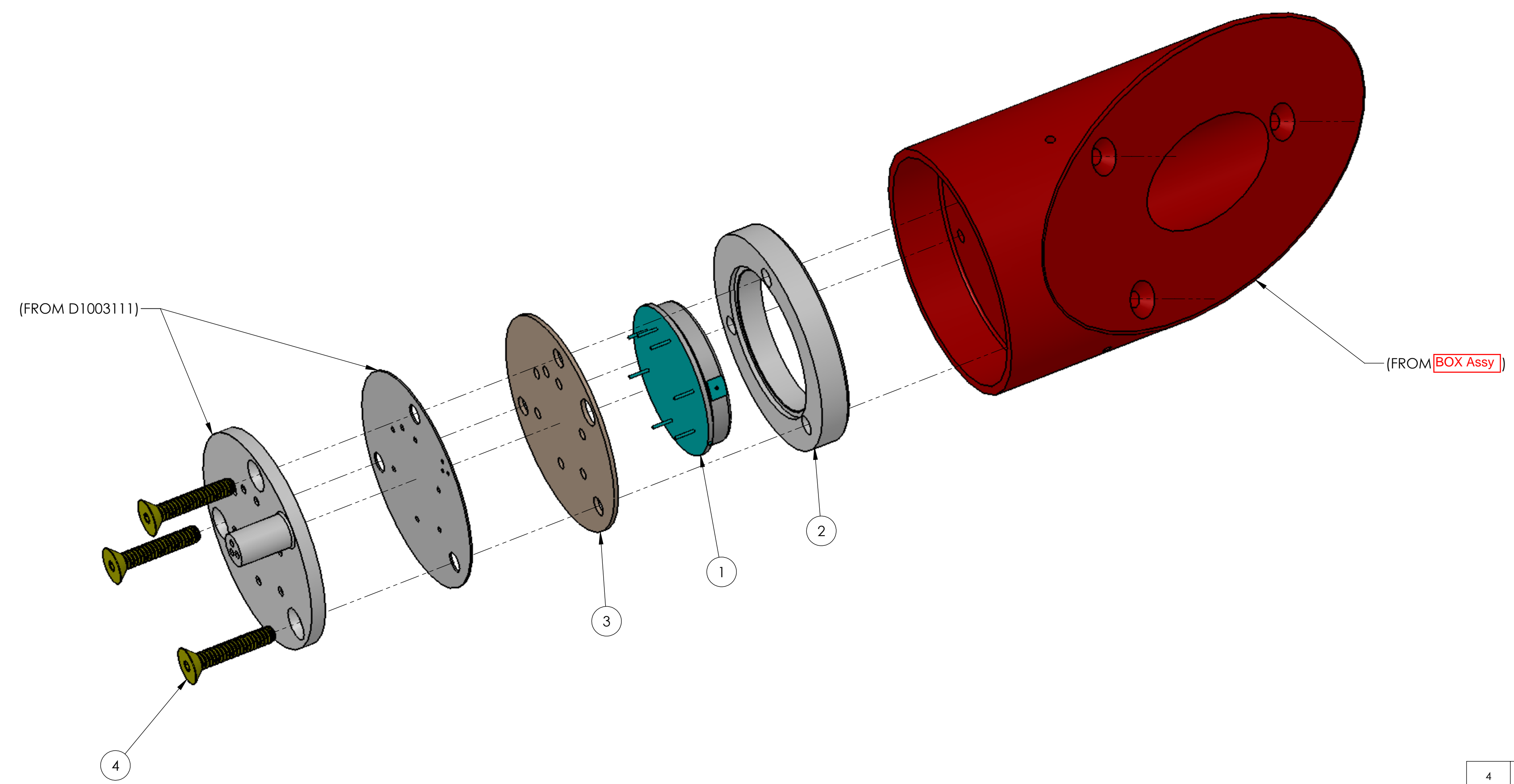
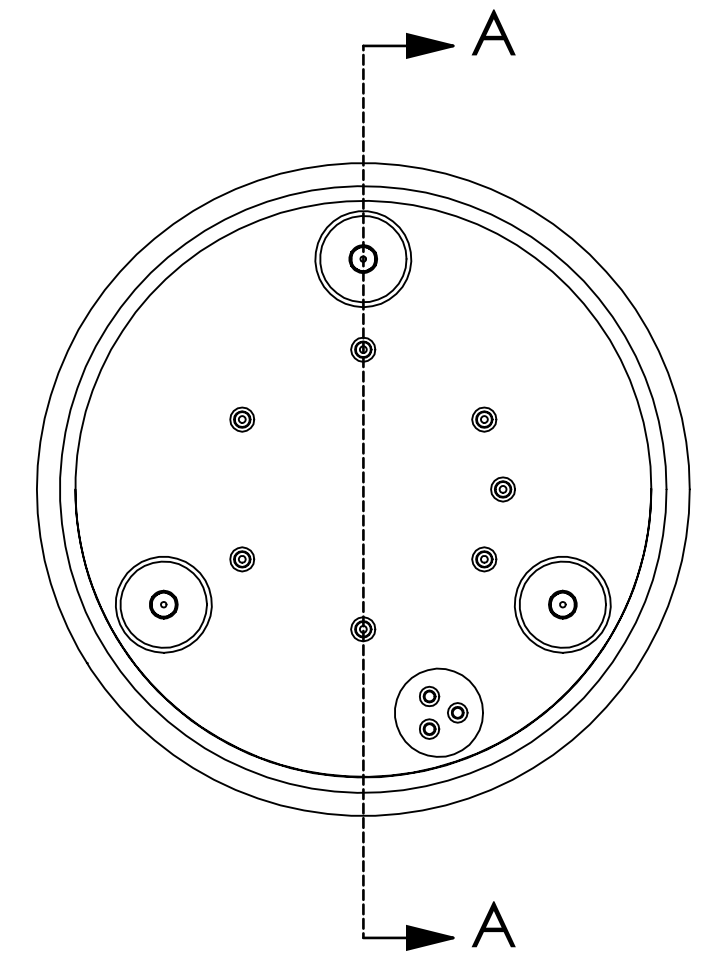
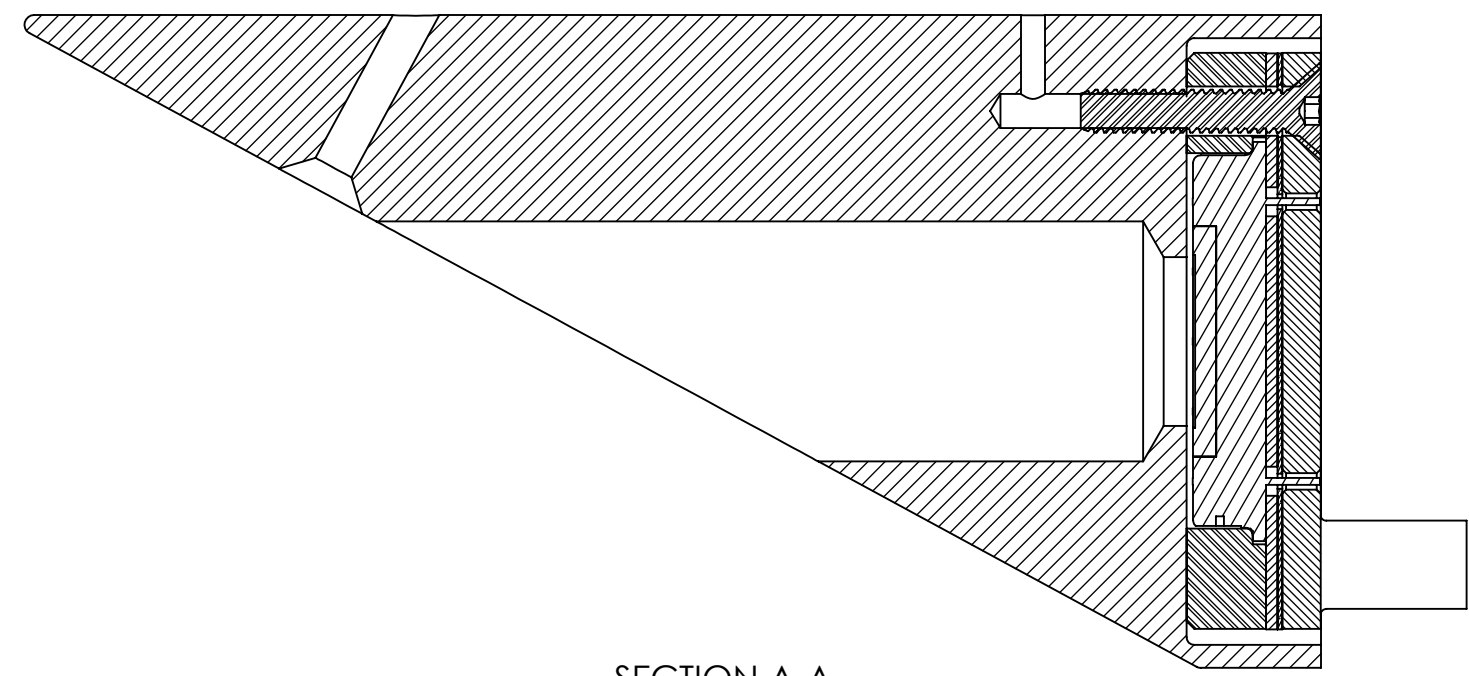

ITEM NO.	PART NUMBER	DESCRIPTION	MATERIAL	Def quit /RE G	SPARE	TOTAL
4	FA-410-A	FLAT HD VENTED SCREW #4-40 X 5/8; UC COMP	18-8 SSSL	3		0
3	D1003028	PD PCB SUPPORT	KAPTON	1		0
2	D1003024	PD FRONT PEEK INSULATOR	PEEK	1		0
1	D1101713	PHOTODIODE, ACB	UNKNOWN	1		0

NOTES AND TOLERANCES: (UNLESS OTHERWISE SPECIFIED)	
1. INTERPRET DRAWING PER ASME Y14.5-1994.	
2. REMOVE ALL SHARP EDGES, .005-.015, FOR MACHINED PARTS. ROUND ALL EDGES APPROXIMATELY R.02 FOR SHEET METAL PARTS.	
3. DO NOT SCALE FROM DRAWING.	
4. ALL MACHINING FLUIDS MUST BE FULLY SYNTHETIC, FULLY WATER SOLUBLE AND FREE OF SULFUR, SILICONE, AND CHLORINE.	
DIMENSIONS ARE IN INCHES	
TOLERANCES:	
.XX ±	
.XXX ±	
ANGULAR ± °	
MATERIAL	N/A
FINISH	N/A μinch

LIGO CALIFORNIA INSTITUTE OF TECHNOLOGY
MASSACHUSETTS INSTITUTE OF TECHNOLOGY

SYSTEM: ADVANCED LIGO SUB-SYSTEM: AOS

NEXT ASSY: D1200657

PART NAME		DESIGNER		DATE		SIZE		DWG. NO.		REV.	
ARM CAVITY BAFFLE PD ASSY		N. Nguyen		28 Nov 2010		D		D1003013		v3	
DRAFTER		N. Nguyen		29 Nov 2010							
CHECKER		M. Smith		01 Dec 2010							
APPROVAL											
						SCALE: 2:1		PROJECTION:		SHEET 1 OF 1	

D1003013_AudiGO_AOS_31C_ACB_PhotodiodeAsy_PART PDM REV: X.050; DRAWING PDM REV: X.030