

REV.	DATE	DCN #	DRAWING TREE #
v1	8 Mar 2011	E1100015	E1100016

NOTES CONTINUED:

- 4. ALL MACHINING FLUIDS MUST BE FULLY SYNTHETIC, FULLY WATER SOLUBLE AND FREE OF SULFUR, SILICONE AND CHLORINE.
- ⑤ SCRIBE, ENGRAVE, OR MECHANICALLY STAMP (NO INKS OR DYES) DRAWING PART NUMBER, REVISION (AND VARIANT OR "TYPE" IF APPLICABLE ON NOTED SURFACE OF PART FOLLOWED ON THE NEXT LINE WITH A THREE DIGIT SERIAL NUMBER. SERIAL NUMBERS START AT 001 FOR THE FIRST ARTICLE AND PROCEED CONSECUTIVELY. USE MINIMUM 0.12 HIGH CHARACTERS, UNLESS THE SIZE OF THE PART DICTATES SMALLER CHARACTERS. A VIBRATORY TOOL MAY BE USED. EXAMPLE DXXXXXXX-VY, TYPE-XX, S/N XXX.
- 6. APPROXIMATE WEIGHT = 0.960 LB.
- 7. ALL PARTS SHALL BE MANUFACTURED IN ACCORDANCE WITH LIGO SPECIFICATION E0900364.

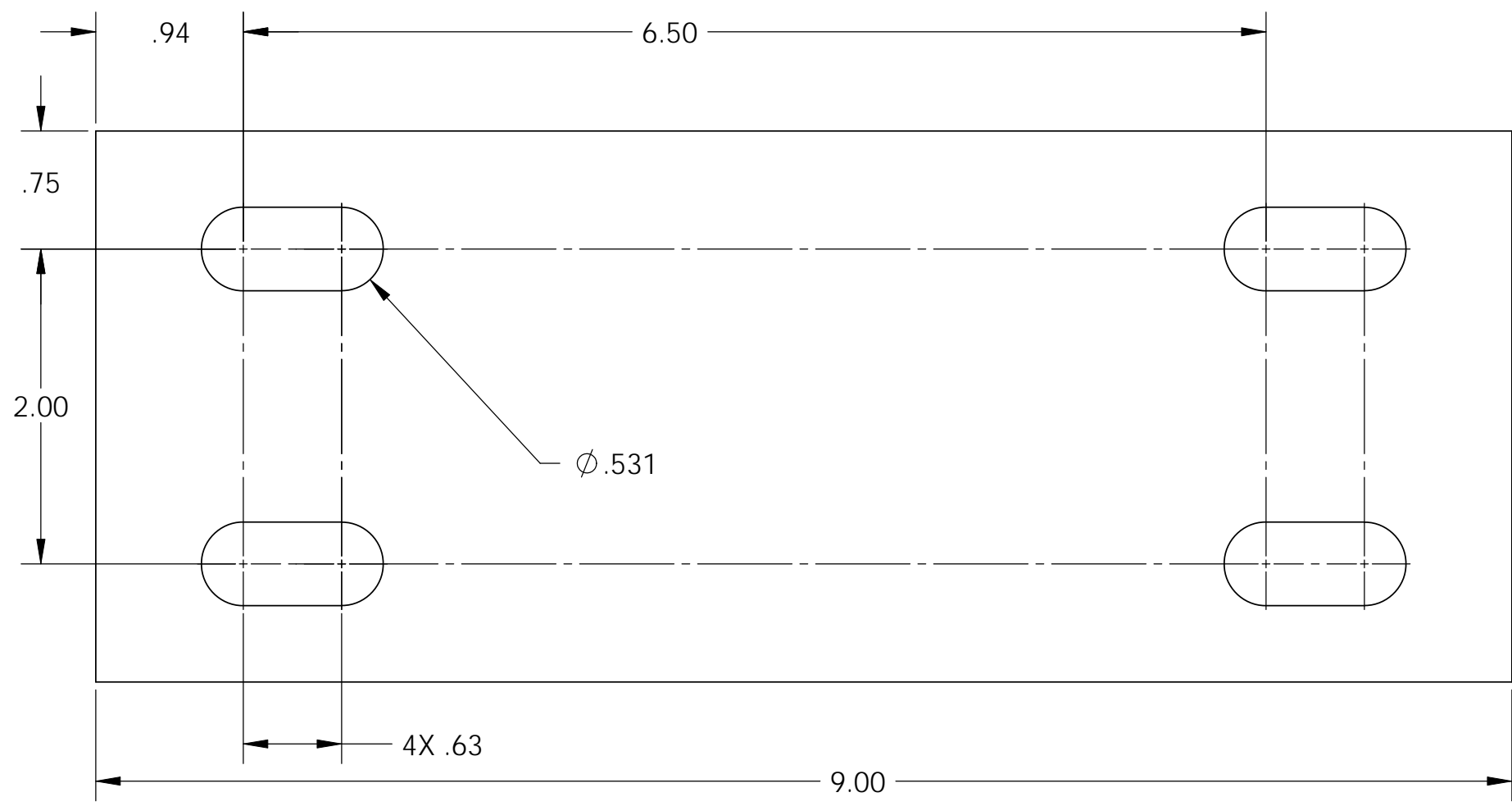
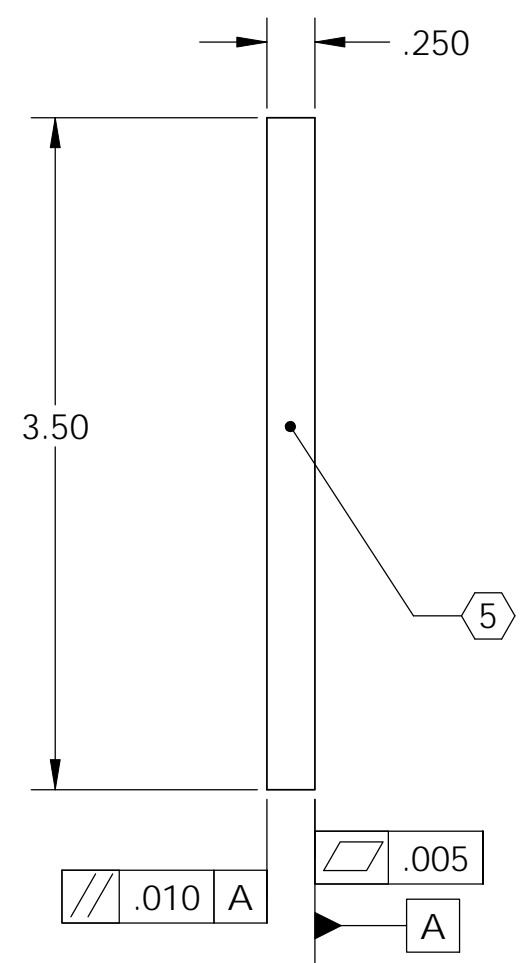

D1100516, PART PDM REV: X-000, DRAWING PDM REV: X-001

NOTES AND TOLERANCES: (UNLESS OTHERWISE SPECIFIED)				LIGO		PART NAME	
DIMENSIONS ARE IN INCHES		1. INTERPRET DRAWING PER ASME Y14.5-1994.		CALIFORNIA INSTITUTE OF TECHNOLOGY		HAM HEPI CLAMP SHIM, aLIGO HAM	
TOLERANCES: .XX ± .015 .XXX ± .005		2. REMOVE ALL SHARP EDGES, .03 x 45°.		MASSACHUSETTS INSTITUTE OF TECHNOLOGY		DESIGNER M.HILLARD 8 Mar 2011	
ANGULAR ± .5°		3. DO NOT SCALE FROM DRAWING.		SYSTEM ADVANCED LIGO		SUB-SYSTEM SEI	
		MATERIAL 304, 316 OR 302 SSSL		FINISH 63 μinch		DRAFTER M.HILLARD 8 Mar 2011	
				NEXT ASSY D040002		CHECKER 8 Mar 2011	
						APPROVAL 8 Mar 2011	
				SCALE: 1:1		PROJECTION:	
				DWG. NO. D1100516		REV. v1	
				SHEET 1 OF 1			