

D1100522 TMS Telescope Second Fold Mirror, PART PDM REV: X-007, DRAWING PDM REV: X-018

**NOTES CONTINUED:**  
 5. SCRIBE, ENGRAVE (A VIBRATORY TOOL MAY BE USED),  
~~ETCH OR MECHANICALLY STAMP~~ (NO INKS OR  
 DYES) DRAWING PART NUMBER, REVISION (AND  
 VARIANT OR "TYPE" IF APPLICABLE) ON NOTED SURFACE  
 OF PART FOLLOWED ON THE NEXT LINE WITH A THREE  
 DIGIT SERIAL NUMBER. SERIAL NUMBERS START AT 001  
 FOR THE FIRST ARTICLE AND PROCEED CONSECUTIVELY.  
 USE MINIMUM 0.12" HIGH CHARACTERS, UNLESS THE SIZE  
 OF THE PART DICTATES SMALLER CHARACTERS.  
 EXAMPLE: DXXXXXX-VY, TYPE-XX, S/N XXX  
 6. APPROXIMATE WEIGHT = .42 LB [1.9 KG].  
 7. MARKING TO BE DONE AT CALTECH  
 8. MAKE FROM:  
 EAV-PM-3550-C (CVI Melles Griot)  
 ENHANCED ALU COATED MIRROR 3.500" DIA, .500" THK  
 BK7  
 9. STANDARD GROUND SURFACE QUALITY ON FLATS.

REV.	DATE	DCN #	DRAWING TREE #
v1	23 MAR 2011	E1100262-v1	-
-	-	-	-
-	-	-	-

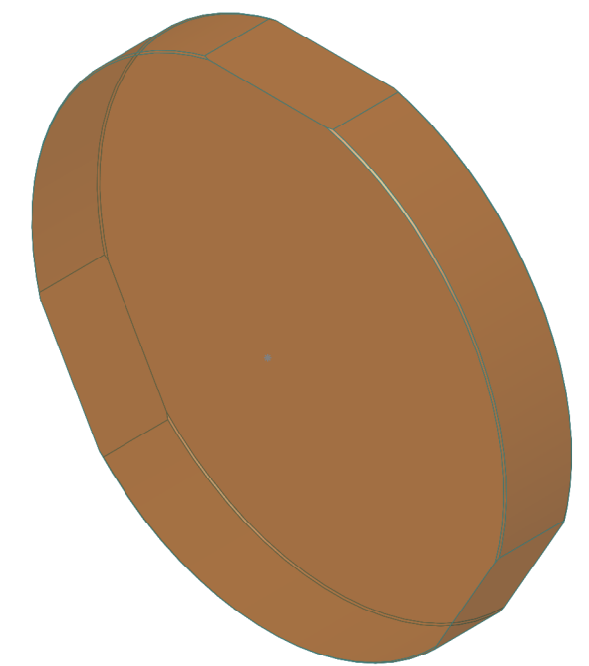
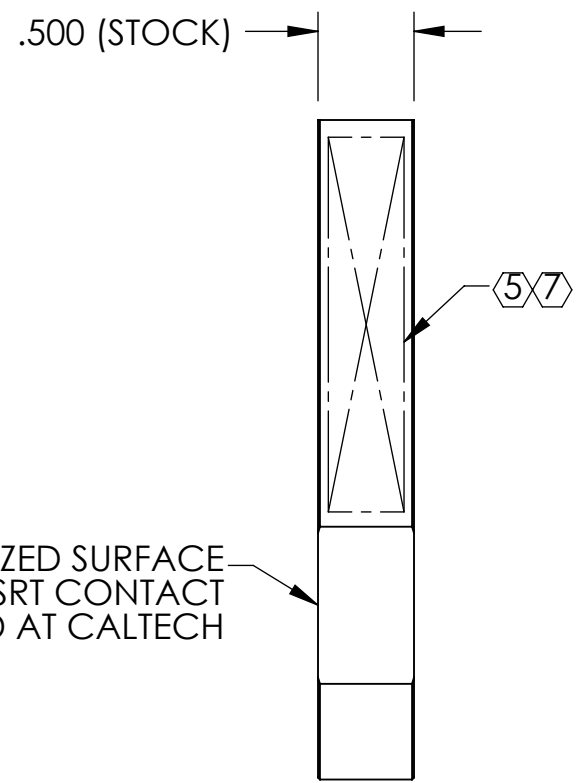
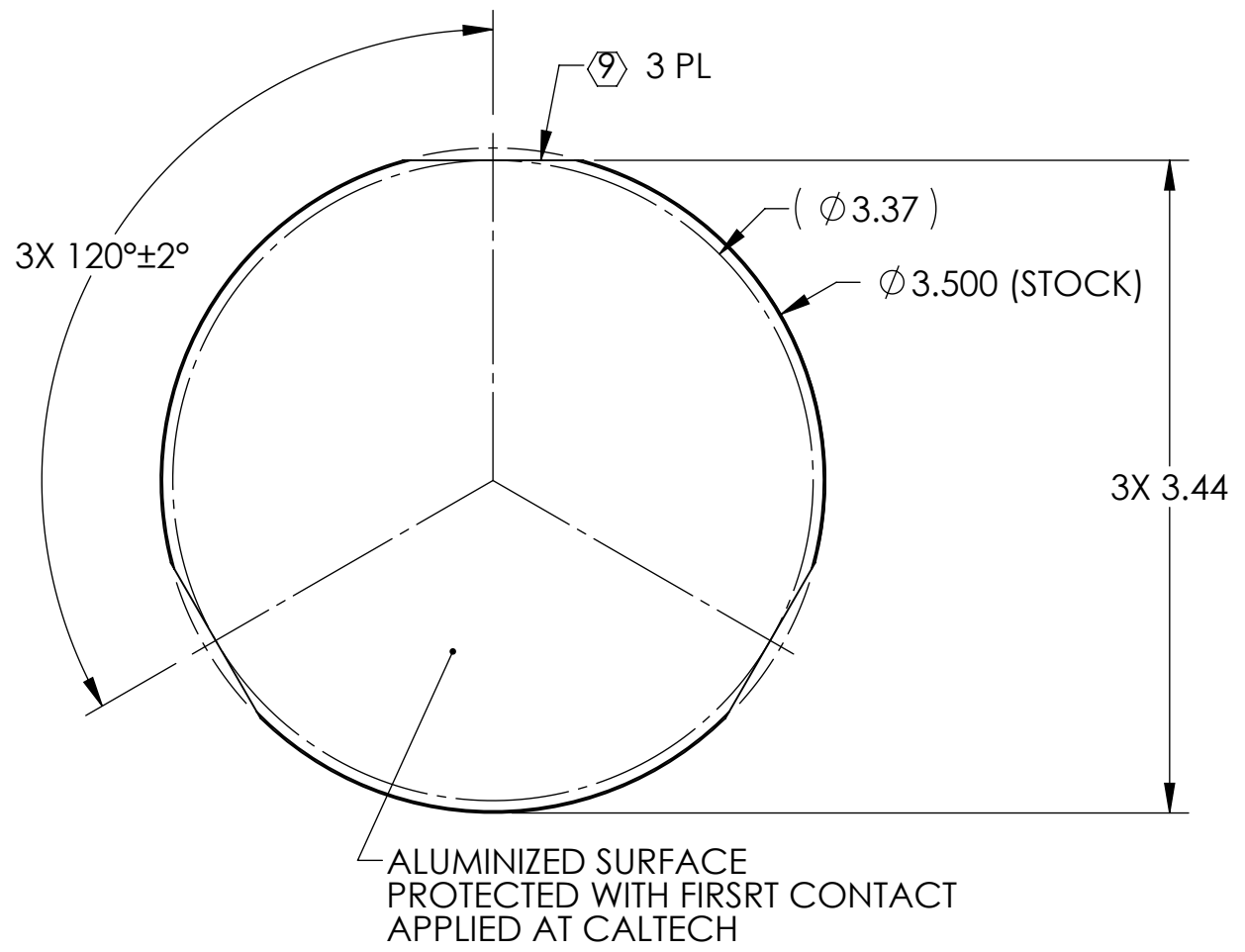

NOTES AND TOLERANCES: (UNLESS OTHERWISE SPECIFIED)	
DIMENSIONS ARE IN INCHES	
TOLERANCES: .XX ± .01 .XXX ± .005 ANGULAR ± 1.0°	
1. INTERPRET DRAWING PER ASME Y14.5-1994. 2. REMOVE ALL SHARP EDGES, .005-.015, FOR MACHINED PARTS. ROUND ALL EDGES APPROXIMATELY R.02 FOR SHEET METAL PARTS. 3. DO NOT SCALE FROM DRAWING. 4. ALL MACHINING FLUIDS MUST BE FULLY SYNTHETIC, FULLY WATER SOLUBLE AND FREE OF SULFUR, SILICONE, AND CHLORINE.	
MATERIAL	FINISH
8	9

CALIFORNIA INSTITUTE OF TECHNOLOGY MASSACHUSETTS INSTITUTE OF TECHNOLOGY		PART NAME <b>TMS TELESCOPE SECOND FOLD MIRROR</b>	
SYSTEM	SUB-SYSTEM	DESIGNER	DATE
ADVANCED LIGO	AOS	C. CONLEY	23 MAR 2011
CHECKER	APPROVAL	C. CONLEY	23 MAR 2011
NEXT ASSY		SIZE	DWG. NO.
D1000088		B	D1100522
		SCALE: NONE	PROJECTION:
			SHEET 1 OF 1