

NOTES CONTINUED:

REV.	DATE	DCN #	DRAWING TREE #
V1	1 JUN 2011	-	-
-	-	-	-
-	-	-	-

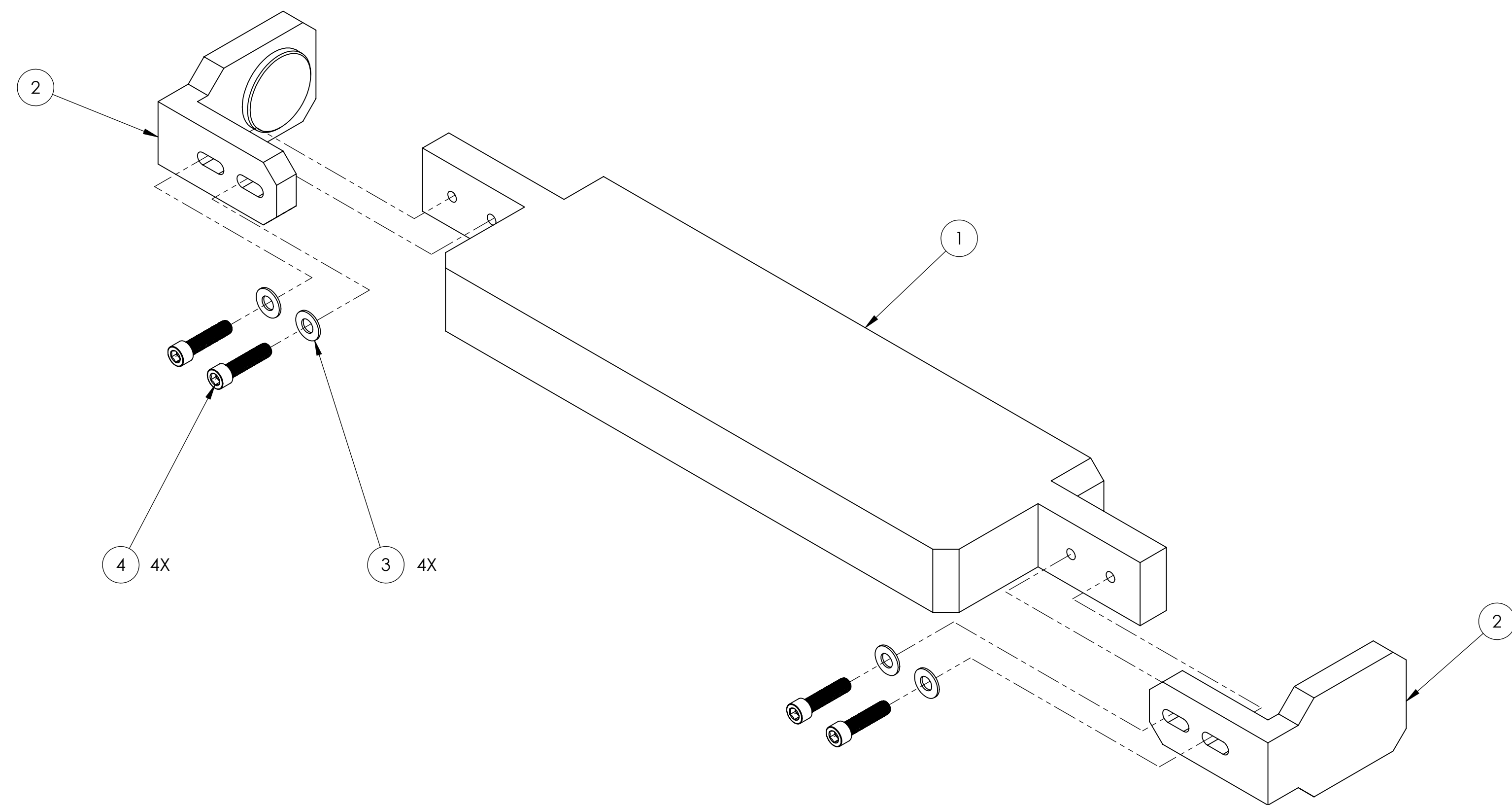

ITEM NO.	PART NUMBER	DESCRIPTION	MATERIAL	REQ	SPARE	TOTAL
4	92185A585	McMASTER, SOCKET HEAD CAP SCREW, .312-18 UNC X 1.25 LG, SSSL	18-8 SSSL	4		4
3	98019A385	.312 FLAT WASHER, .34 ID X .69 OD X .06 T, NASM 15795-812, SSSL	300 SSSL	4		4
2	D1101037	QUAD LIFTING BAR CLAMP	6061-T6 Al	2		2
1	D1101036	QUAD LIFTING BAR	6061-T6 Al	1		1

NOTES AND TOLERANCES: (UNLESS OTHERWISE SPECIFIED)	
1. INTERPRET DRAWING PER ASME Y14.5-1994. 2. REMOVE ALL SHARP EDGES, .005-.015, FOR MACHINED PARTS. ROUND ALL EDGES APPROXIMATELY R.02 FOR SHEET METAL PARTS. 3. DO NOT SCALE FROM DRAWING. 4. ALL MACHINING FLUIDS MUST BE FULLY SYNTHETIC, FULLY WATER SOLUBLE AND FREE OF SULFUR, SILICONE, AND CHLORINE.	
DIMENSIONS ARE IN MILLIMETERS TOLERANCES: .XX ± .25 .XXX ± .13 ANGULAR ± .5°	MATERIAL N/A FINISH N/A μinch

CALIFORNIA INSTITUTE OF TECHNOLOGY
MASSACHUSETTS INSTITUTE OF TECHNOLOGY

SYSTEM: **ADVANCED LIGO** SUB-SYSTEM: **SUS**

NEXT ASSY:

PART NAME		QUAD LIFTING BAR ASSEMBLY	
DESIGNER	K. BUCKLAND	1 JUN 2011	SIZE DWG. NO.
DRAFTER	K. BUCKLAND	1 JUN 2011	D D1101035
CHECKER			REV. v1
APPROVAL			SCALE: 1:2 PROJECTION:  SHEET 1 OF 1

D1101036-QUAD LIFTING BAR ASSEMBLY PART PDM REV: X-000 DRAWING PDM REV: X-000