

8

7

6

5

4

3

2

1

NOTES CONTINUED:

5. BAG AND TAG PARTS WITH THEIR DRAWING PART NUMBER, REVISION, VARIANT OR "TYPE" (IF APPLICABLE), AND QUANTITY. IF PARTS ARE TOO SMALL TO SCRIBE, BAGGING AND TAGGING ALONE IS SUFFICIENT. EXAMPLE (PART): 001-v1 EXAMPLE (TAG): DXXXXXX-VY, TYPE-XX, QTY: TBD

- 6. APPROXIMATE WEIGHT = X.XXX LB.
- 7. MACHINE ALL SURFACES TO REMOVE OXIDES AND MILL FINISH. USE OF ABRASIVE REMOVAL TECHNIQUES IS NOT ALLOWED. REFER TO LIGO-E0900364
- 8. ALL PARTS SHALL BE MANUFACTURED IN ACCORDANCE WITH LIGO SPECIFICATION E0900364.
- 9. ALL MATERIAL IS TO BE VIRGIN MATERIAL (i.e. NO PLUGS OR RECYCLED MATERIAL). NO REPAIRS SHALL BE MADE UNLESS APPROVED IN ADVANCE, AND IN WRITING, BY LIGO LABORATORY. REFER TO LIGO-E0900364.

| REV. | DATE | DCN # | DRAWING TREE # |
|------|--------------|----------|----------------|
| V1 | 30 AUG 2012 | E1200796 | - |
| V2 | 11 SEPT 2012 | E1200819 | - |
| - | - | - | - |

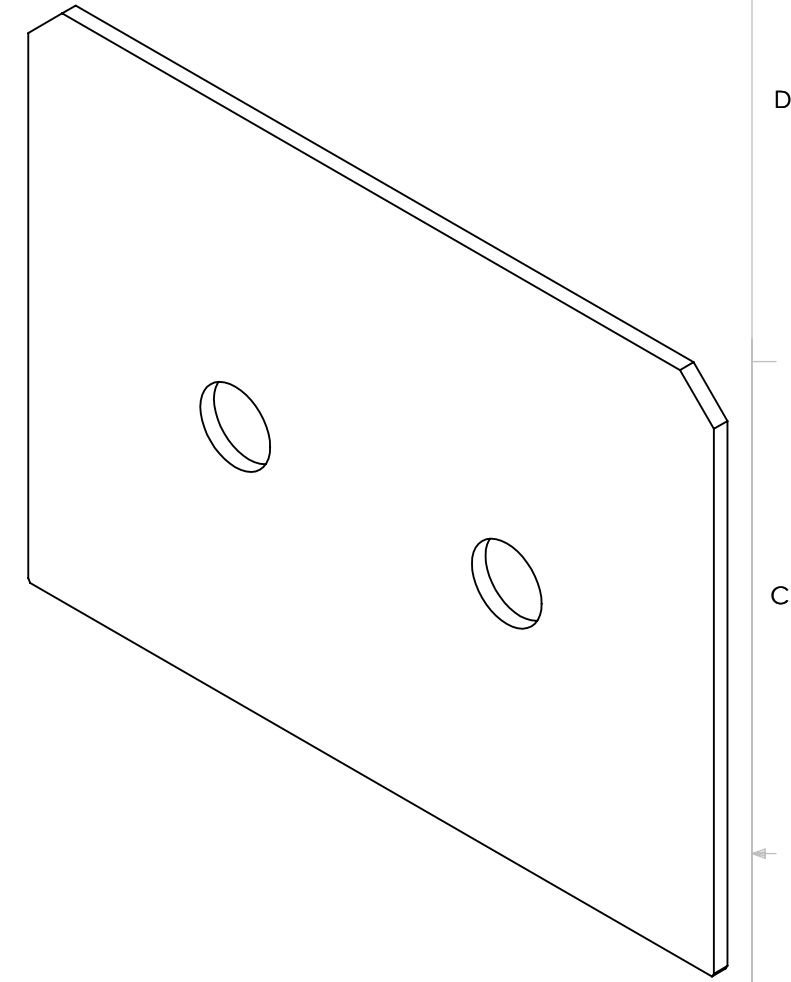
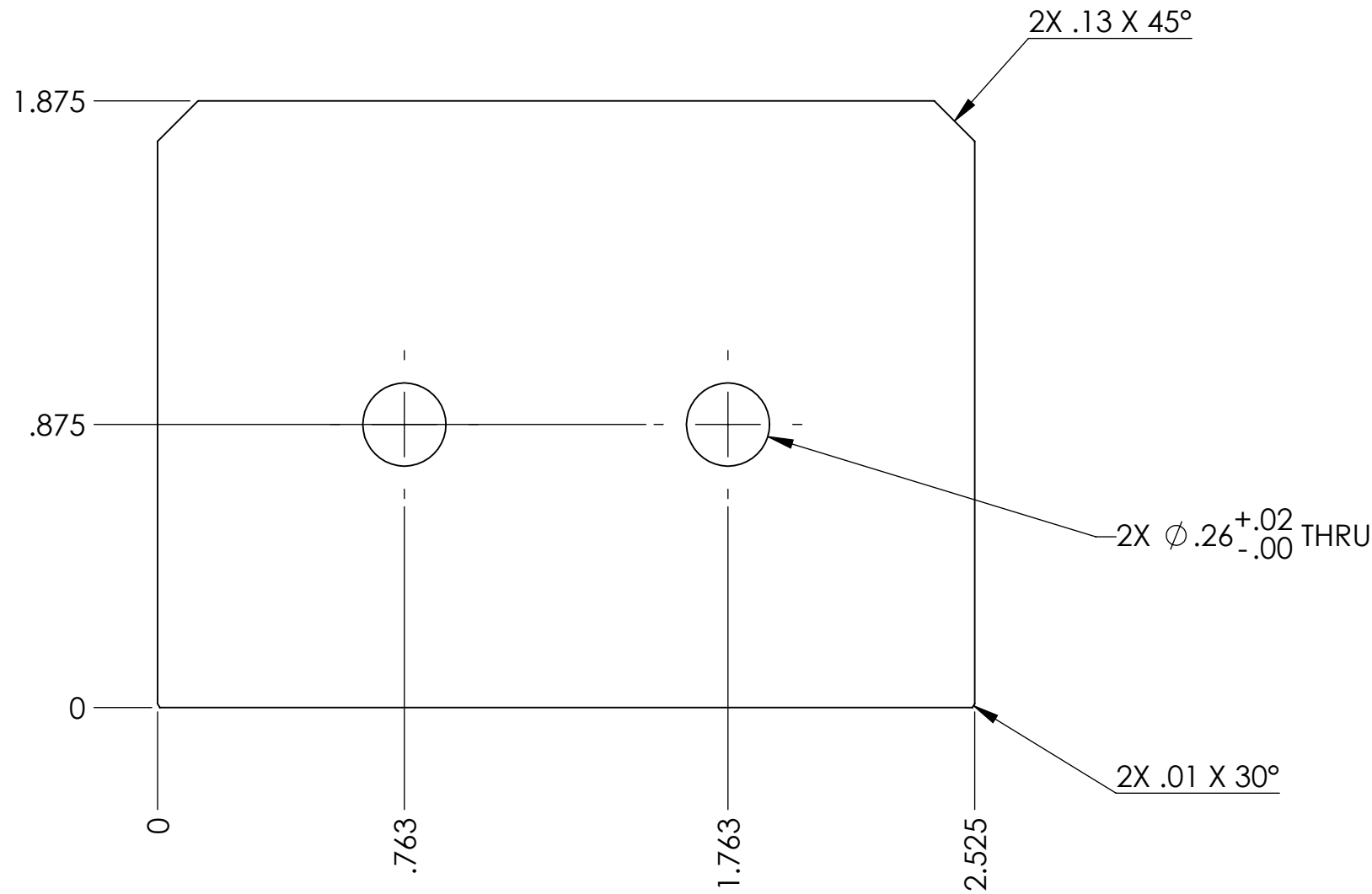
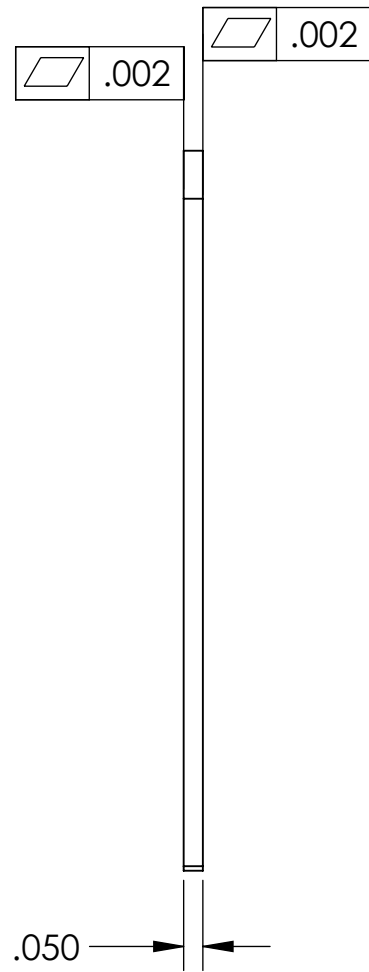

D1101997 LSC VAC ENCLOSURE - alumina spacer aLIGO, PART PDM REV: X-001, DRAWING PDM REV: X-001

| NOTES AND TOLERANCES: (UNLESS OTHERWISE SPECIFIED) | |
|---|----------|
| DIMENSIONS ARE IN INCHES | |
| TOLERANCES: .XX ± .01 .XXX ± .005 | |
| ANGULAR ± 0.5° | |
| 1. INTERPRET DRAWING PER ASME Y14.5-1994. 2. REMOVE ALL SHARP EDGES, .005-.015, FOR MACHINED PARTS. ROUND ALL EDGES APPROXIMATELY R.02 FOR SHEET METAL PARTS. 3. DO NOT SCALE FROM DRAWING. 4. ALL MACHINING FLUIDS MUST BE FULLY SYNTHETIC, FULLY WATER SOLUBLE AND FREE OF SULFUR, SILICONE, AND CHLORINE. | |
| MATERIAL | FINISH |
| ALUMINA | 63 μinch |

| | | | |
|---|--|-------------------|--|
| CALIFORNIA INSTITUTE OF TECHNOLOGY MASSACHUSETTS INSTITUTE OF TECHNOLOGY | | PART NAME | |
| SYSTEM ADVANCED LIGO | | SUB-SYSTEM ISC | |
| NEXT ASSY | | D1101992 | |

| | | | | | |
|----------|-----------|--------------|------------|-----------------|--------------|
| DESIGNER | RABBOTT | 7 FEB 2012 | SIZE | DWG. NO. | REV. |
| DRAFTER | SBARNUM | 11 SEPT 2012 | B | D1101997 | v2 |
| CHECKER | RABBOTT | FEB 7 2012 | SCALE: 2:1 | PROJECTION: | SHEET 1 OF 1 |
| APPROVAL | PFRITCHEL | | | | |

8

7

6

5

4

3

2

1