

NOTES CONTINUED:

- [5] HARTMANN SENSOR COMPONENTS PROVIDED BY aLIGO TCS
- [6] ALS COMPONENTS PROVIDED BY aLIGO ISC
- [7] PRE EXISTING COMPONENT REUSED FROM iLIGO
- [8] INTERFACE CLEARANCES TO BE MAINTAINED BETWEEN ISC AND TCS COMPONENTS

REV.	DATE	DCN #	DRAWING TREE #
v1	04 NOV 2011	E1101076-v1	

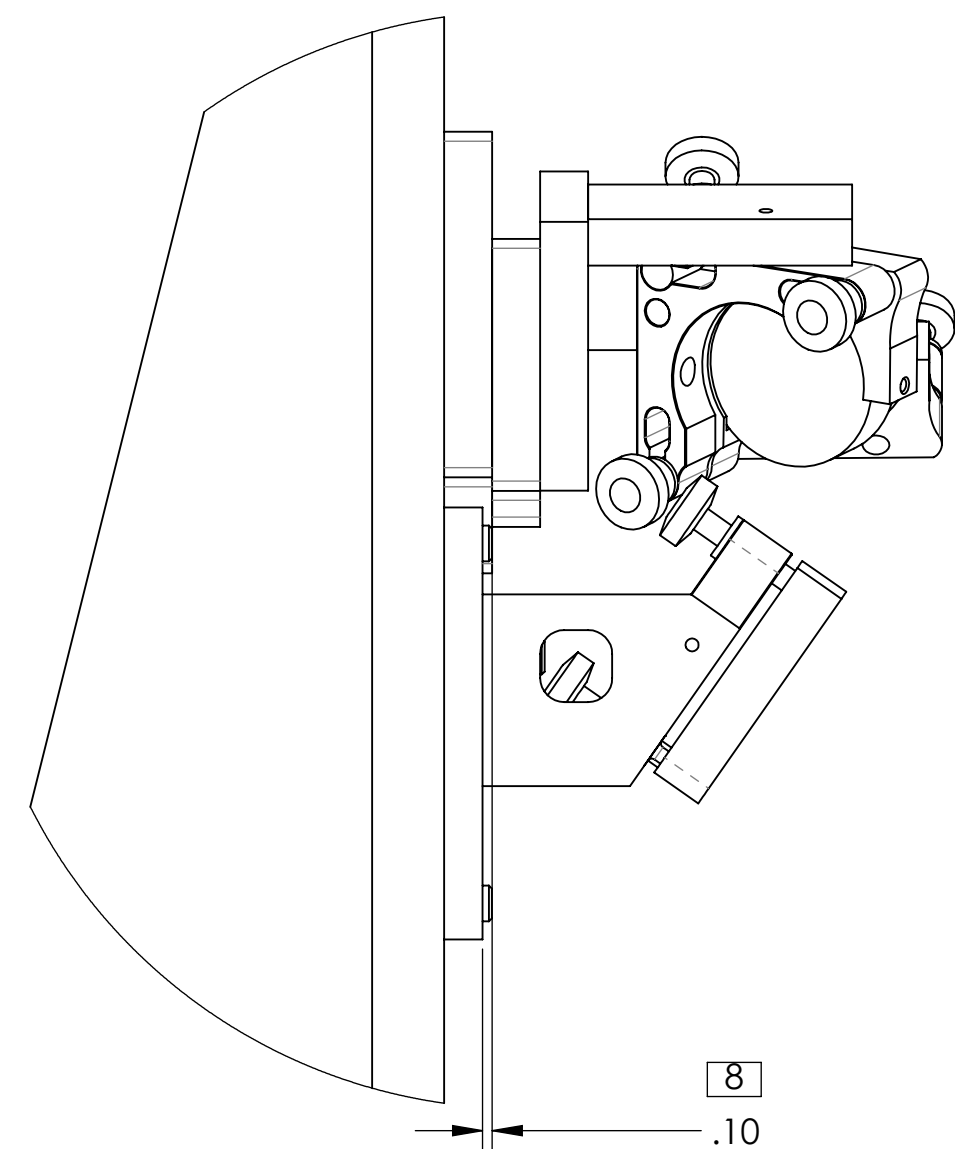

DETAIL A
SCALE 1 : 2

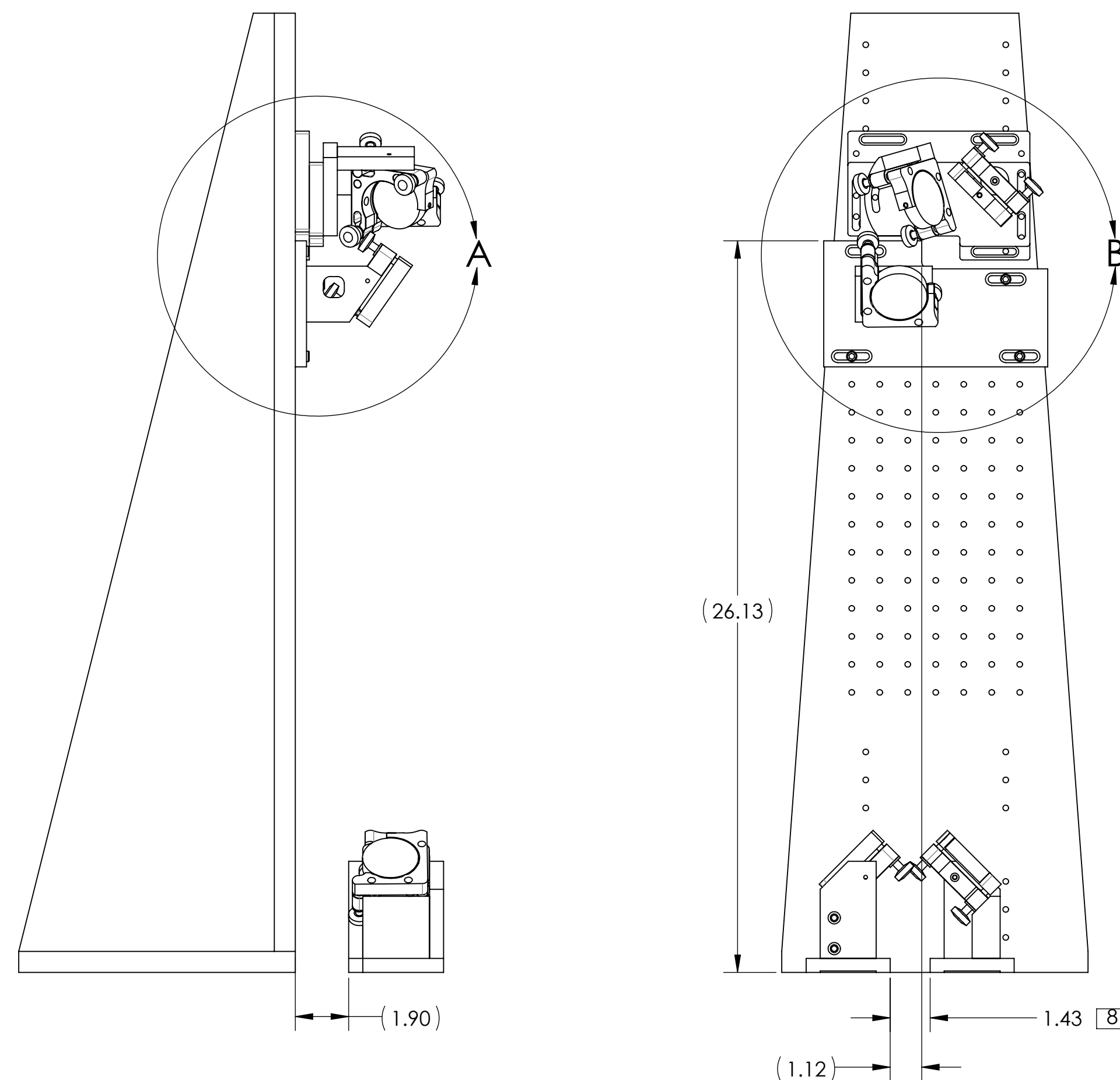

DETAIL B
SCALE 1 : 2

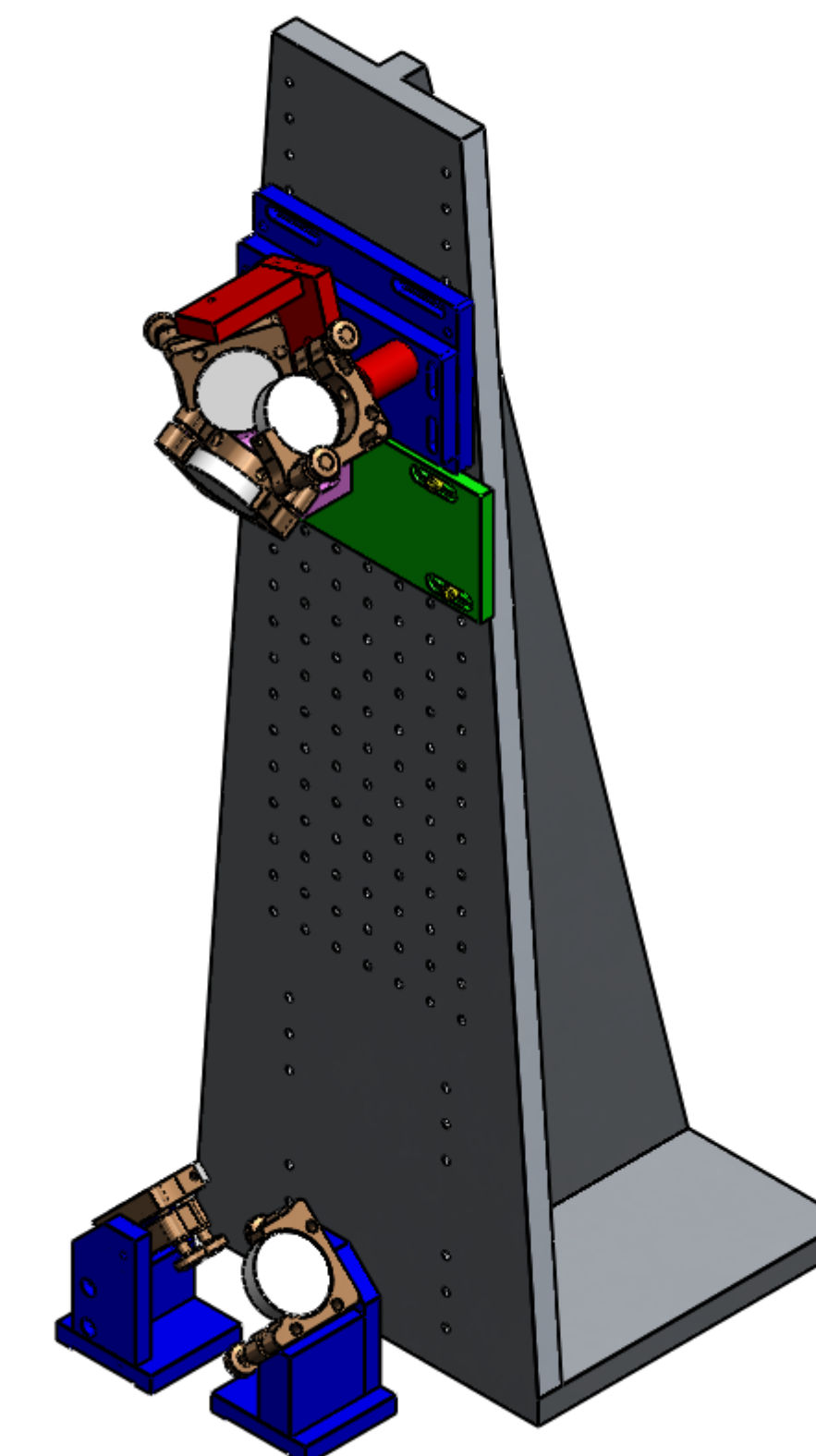
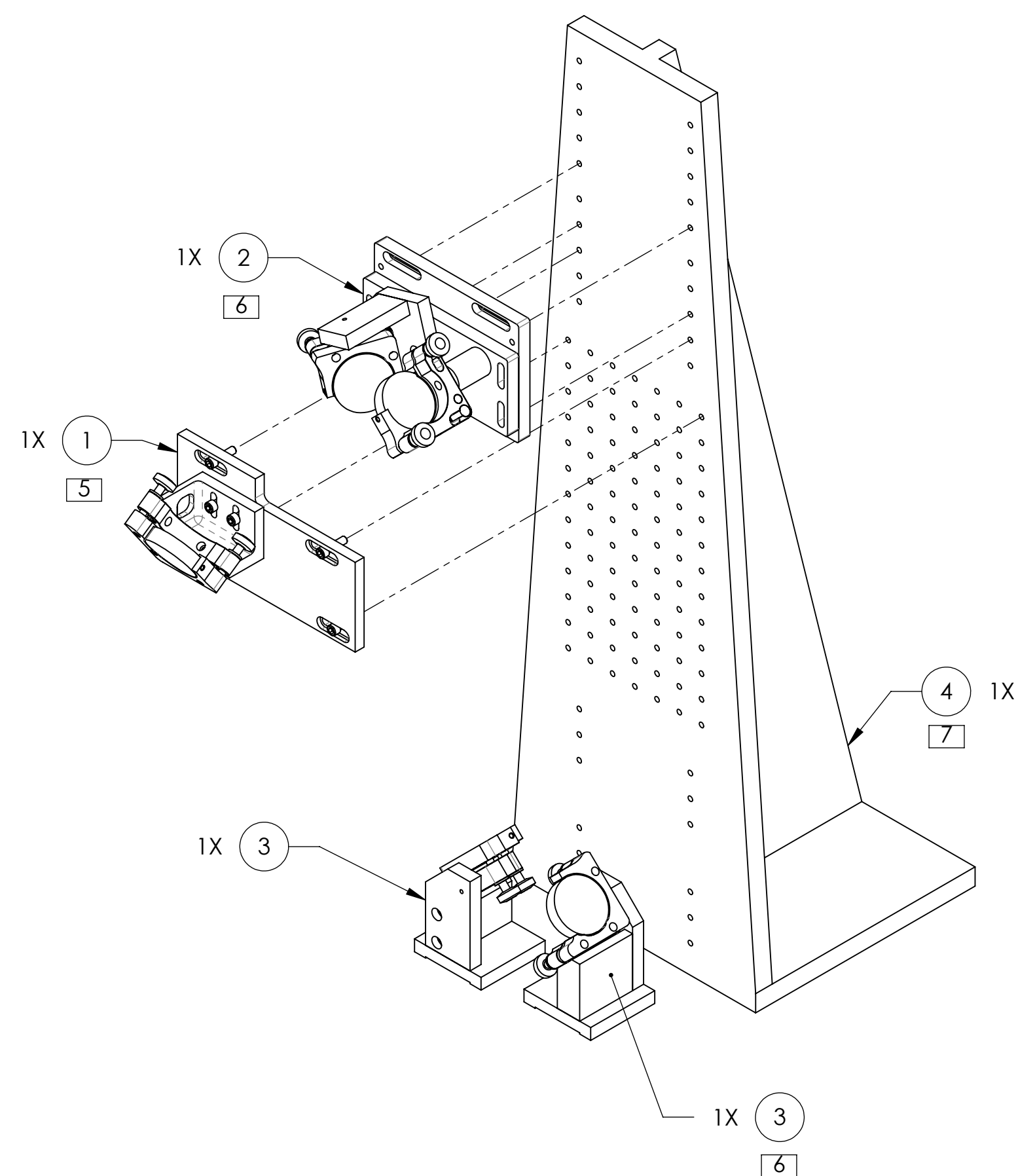

ITEM NO.	PART NUMBER	DESCRIPTION	MATERIAL	Default/REQ	SPARE	TOTAL
4	D1102140	PERISCOPE MOUNT, REUSED AT BSC6 IN-AIR TABLE	6061 Alloy	1	0	1
3	D1101860	ALS Y-End Lower Periscope Mirror Assembly	N/A	2	0	2
2	D1101481	ALS Y-End-Station Upper Periscope Assembly	N/A	1	0	1
1	D1101819	HWS ETM PERISCOPE MIRROR MOUNT ASSY	N/A	1	0	1
PARTS LIST						

DIMENSIONS ARE IN INCHES TOLERANCES: .XX ± .XXX ± ANGULAR ± °		NOTES AND TOLERANCES: (UNLESS OTHERWISE SPECIFIED) 1. INTERPRET DRAWING PER ASME Y14.5-1994. 2. REMOVE ALL SHARP EDGES, .005-.015, FOR MACHINED PARTS. ROUND ALL EDGES APPROXIMATELY R.02 FOR SHEET METAL PARTS. 3. DO NOT SCALE FROM DRAWING. 4. ALL MACHINING FLUIDS MUST BE FULLY SYNTHETIC, FULLY WATER SOLUBLE AND FREE OF SULFUR, SILICONE, AND CHLORINE.		CALIFORNIA INSTITUTE OF TECHNOLOGY MASSACHUSETTS INSTITUTE OF TECHNOLOGY		PART NAME ALS and HWS PERISCOPE PLATE ASSY									
MATERIAL N/A		FINISH N/A μinch		NEXT ASSY D1100607		SYSTEM ADVANCED LIGO		SUB-SYSTEM ISC		DESIGNER A. LYNCH 19 OCT 2011		SIZE DWG. NO. D D1102049		REV. v1	
APPROVAL A. BROOKS 26 OCT 2011		CHECKER M. JACOBSON 04 NOV 2011		DRAFTER A. LYNCH 02 NOV 2011		SCALE: 1:4		PROJECTION:		SHEET 1 OF 1					

D1102049_ALS and HWS Periscope Plate Assembly, PART PDM REV: X-021, DRAWING PDM REV: X-005