

D:\102144_ACS_Installation\Starts\Telescope Tube Framing_PART.PDM REV. X-046, DRAWING PDM REV. X-016

NOTES CONTINUED:
 5. SCRIBE, ENGRAVE (A VIBRATORY TOOL MAY BE USED), LASER MARK OR MECHANICALLY STAMP (NO INKS OR DYES) DRAWING PART NUMBER, REVISION (AND VARIANT OR "TYPE" IF APPLICABLE) ON NOTED SURFACE OF PART FOLLOWED ON THE NEXT LINE WITH A THREE DIGIT SERIAL NUMBER. SERIAL NUMBERS START AT 001 FOR THE FIRST ARTICLE AND PROCEED CONSECUTIVELY. USE MINIMUM 0.12" HIGH CHARACTERS, UNLESS THE SIZE OF THE PART DICTATES SMALLER CHARACTERS. EXAMPLE: DXXXXXX-VY, TYPE-XX, S/N XXX

- 6. APPROXIMATE WEIGHT = 1.853 LB.
- 7. ALL PARTS SHALL BE MANUFACTURED IN ACCORDANCE WITH LIGO SPECIFICATION E0900364.
- 8. ALL MATERIAL IS TO BE VIRGIN MATERIAL (i.e. NO WELD REPAIRS, PLUGS OR RECYCLED MATERIAL), NO REPAIRS SHALL BE MADE UNLESS APPROVED IN ADVANCE, AND IN WRITING, BY LIGO LABORATORY. REFER TO LIGO-E0900364.
- 9. MATERIAL AS RECEIVED MACHINE FINISH.

| REV. | DATE | DCN # | DRAWING TREE # |
|------|-------------|-------------|----------------|
| v1 | 20 OCT 2011 | E1100335-v3 | - |
| - | - | - | - |
| - | - | - | - |

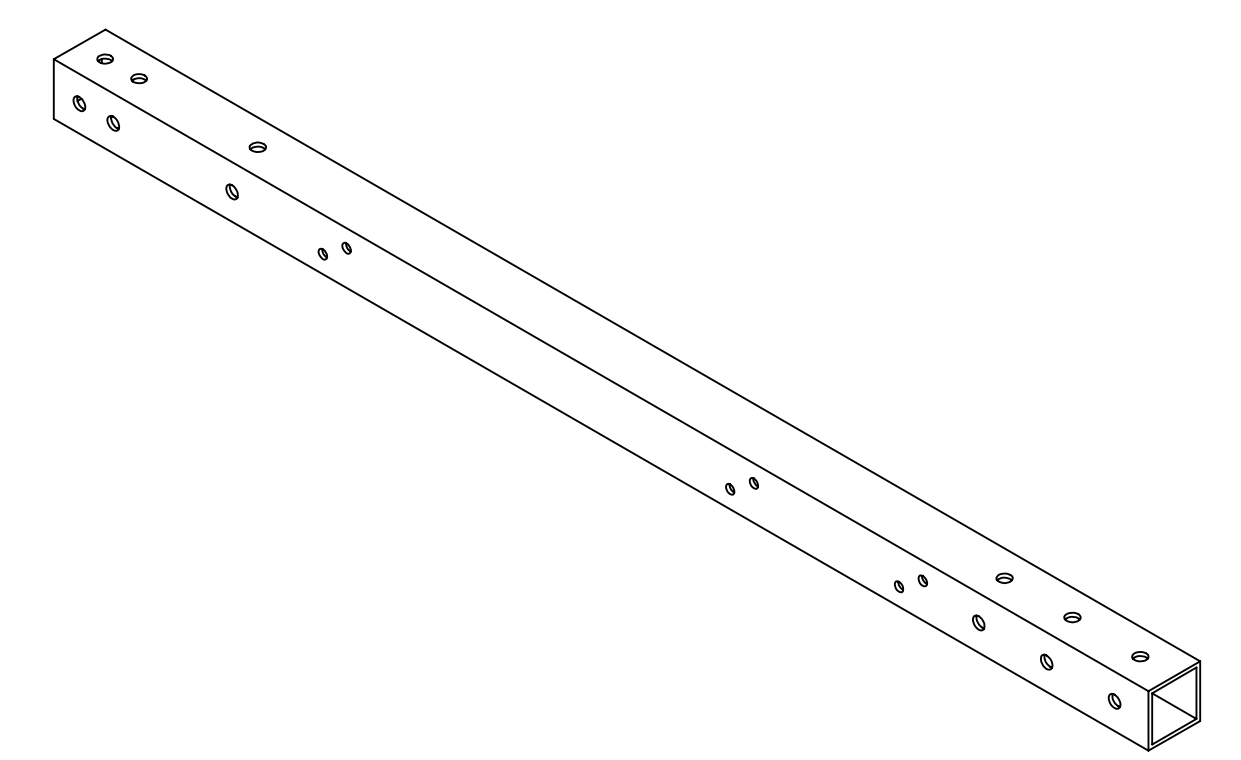

GENERAL VIEW FOR REFERENCE ONLY NO SCALE

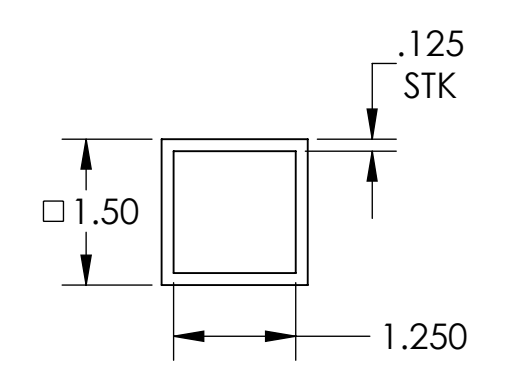
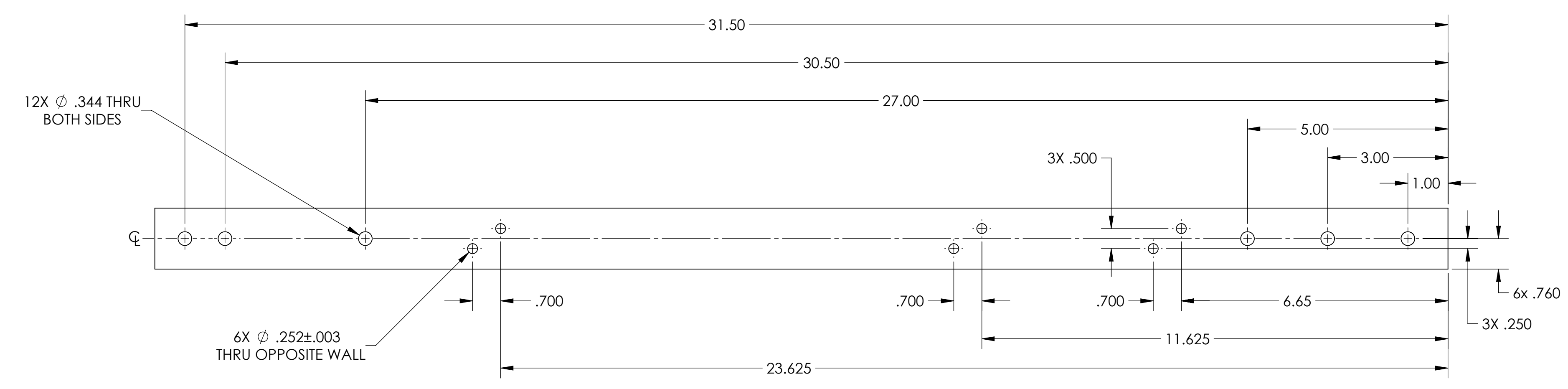
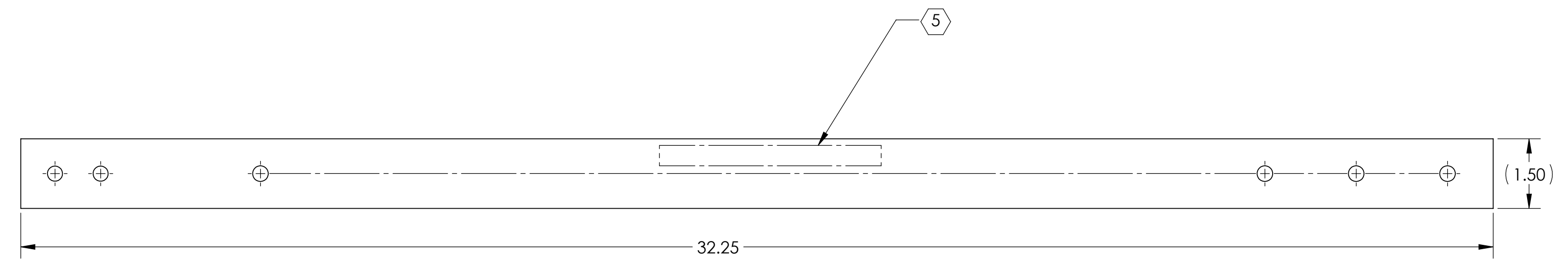

-01
1.50" Aluminum TUBE
TELESCOPING-TUBE

| DIMENSIONS ARE IN INCHES | | NOTES AND TOLERANCES: (UNLESS OTHERWISE SPECIFIED) | | LIGO CALIFORNIA INSTITUTE OF TECHNOLOGY MASSACHUSETTS INSTITUTE OF TECHNOLOGY | | PART NAME | | | |
|---|--|---|--|---|--|-----------------------|--|------------------------|--|
| TOLERANCES: .XX ± .01 .XXX ± .005 | | 1. INTERPRET DRAWING PER ASME Y14.5-1994. 2. REMOVE ALL SHARP EDGES, .005-.015, FOR MACHINED PARTS. ROUND ALL EDGES APPROXIMATELY R.02 FOR SHEET METAL PARTS. 3. DO NOT SCALE FROM DRAWING. 4. ALL MACHINING FLUIDS MUST BE FULLY SYNTHETIC, FULLY WATER SOLUBLE AND FREE OF SULFUR, SILICONE, AND CHLORINE. | | SYSTEM ADVANCED LIGO | | SUB-SYSTEM AOS | | TELESCOPE TUBE FRAMING | |
| ANGULAR ± 1.0° | | MATERIAL 6061-T6 Al | | FINISH N/A μinch | | NEXT ASSY D1101957 | | DESIGNER TQ. NGUYEN | |
| | | | | | | DATE 15 OCT 2011 | | SIZE D | |
| | | | | | | DWG. NO. D1102144 | | REV. v1 | |
| | | | | | | CHECKER L. AUSTIN | | SCALE: 1:2 | |
| | | | | | | APPROVAL C. TORRIE | | PROJECTION: | |
| | | | | | | | | SHEET 1 OF 3 | |

NOTES:

1. TUBE 1.25" SLIDING FREELY INSIDE TUBE 1.5".

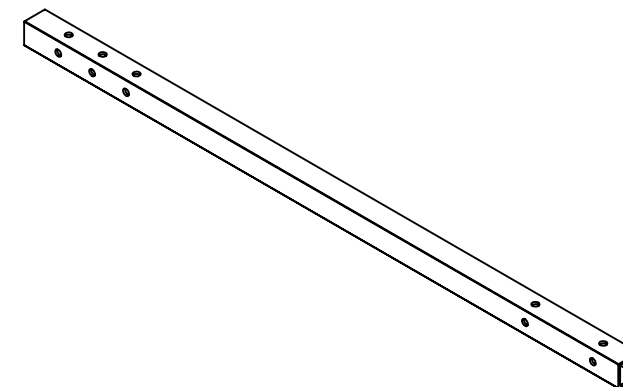
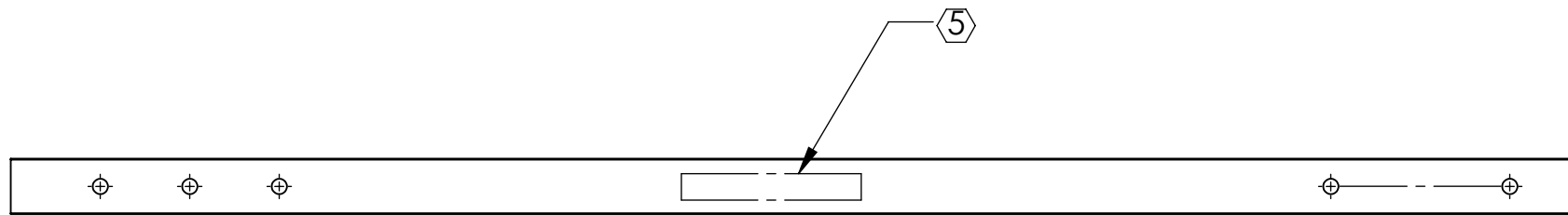

GENERAL VIEW
FOR REFERENCE ONLY
NO SCALE

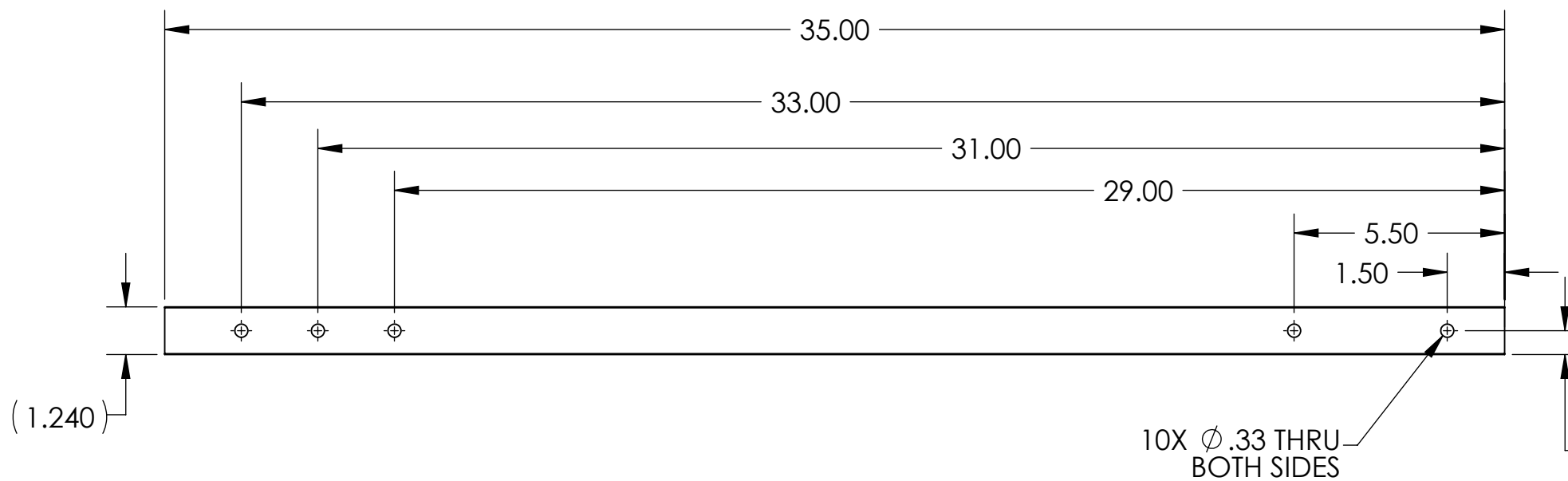

-02
1.25" Aluminum TUBE
FRAMING-TUBE
SCALE 1:4

10X ϕ .33 THRU
BOTH SIDES

5.X .620

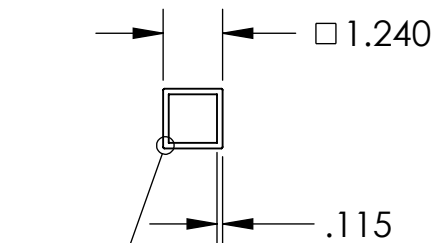

DETAIL A
SCALE 2:1

D1102144_ACB Installation Stand_Telescope Tube Framing, PART PDM REV: X-048, DRAWING PDM REV: X-016

| | | |
|---|-------------|--------------|
| CALIFORNIA INSTITUTE OF TECHNOLOGY MASSACHUSETTS INSTITUTE OF TECHNOLOGY | | |
| SIZE | DWG. NO. | REV. |
| B | D1102144 | v1 |
| SCALE: 1:8 | PROJECTION: | SHEET 2 OF 3 |

D1102144_ACB Installation Stand_Telescope Tube Framing, PART PDM REV: X-048, DRAWING PDM REV: X-016

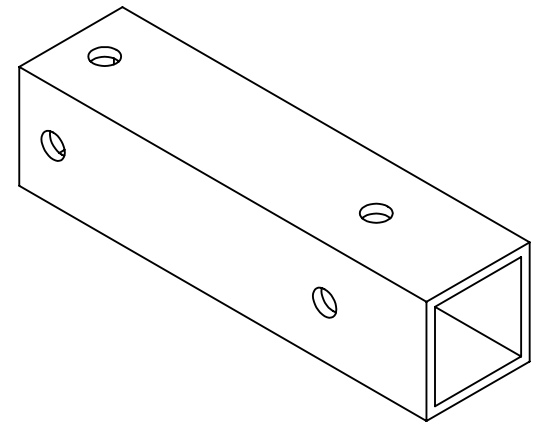
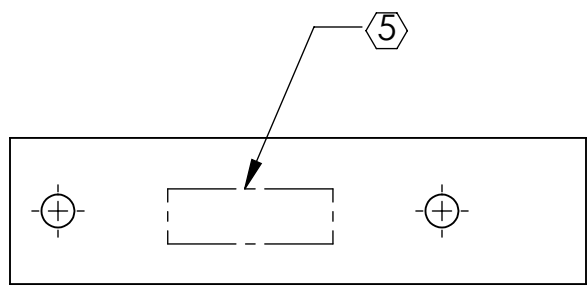

GENERAL VIEW
FOR REFERENCE ONLY
NO SCALE

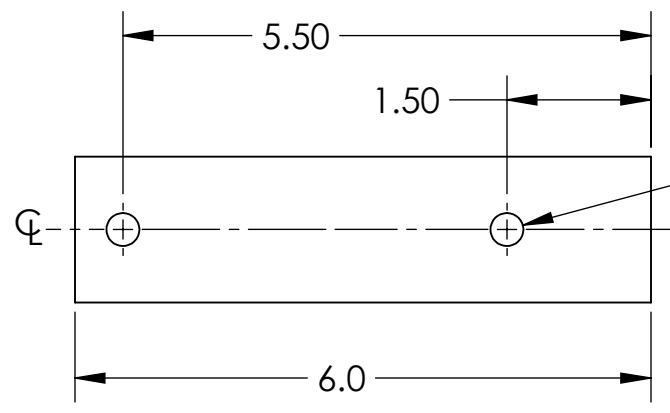

4X ϕ .34 THRU
BOTH SIDES

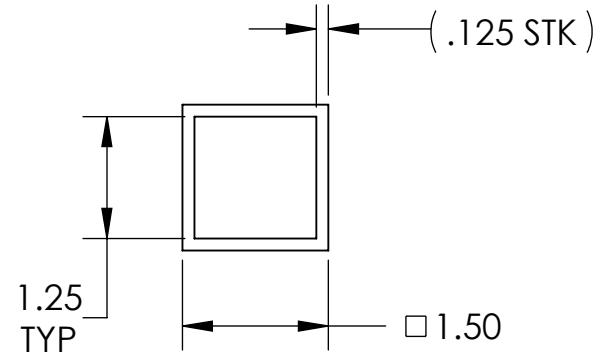

-03
1.50" Aluminum TUBE
FRAMING-TUBE

| | |
|---|--|
|  CALIFORNIA INSTITUTE OF TECHNOLOGY MASSACHUSETTS INSTITUTE OF TECHNOLOGY | |
| SIZE B | DWG. NO. D1102144 |
| SCALE: 1:8 | PROJECTION:  SHEET 3 OF 3 |
| REV. v1 | |