

REV.	DATE	DCN #	DRAWING TREE #
v2	21 JUL 2014	-	-
-	-	-	-
-	-	-	-

1. Cleanroom gloves, mask and frock should be worn at all times when handling the lead, even when it is within its plastic.
2. The lead discs (90385K46) you called about come wrapped in a thick plastic bag.
3. The lead discs need to be removed from plastic sheeting prior to being installed into cans. See step 1. Protective clothing should be disposed of after each use.
4. The area used must be cleaned up after use and all extra items e.g. bags lead came in disposed of. If operator feels dust is airborne they should allow dust to settle and then clean it up before proceeding.

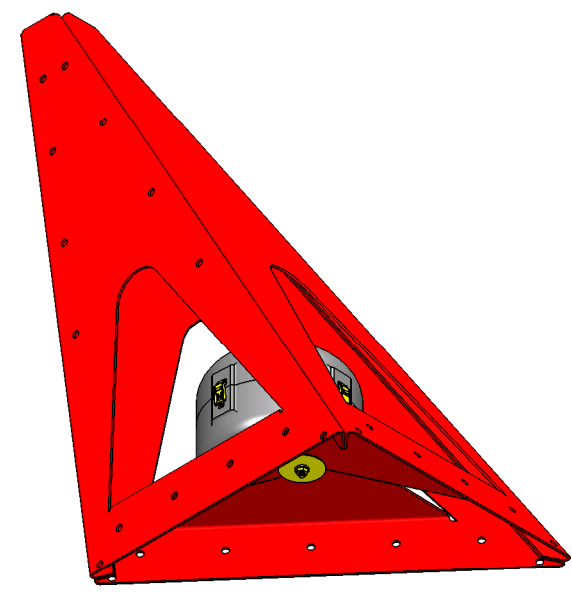

ISO VIEW, UNDERSIDE

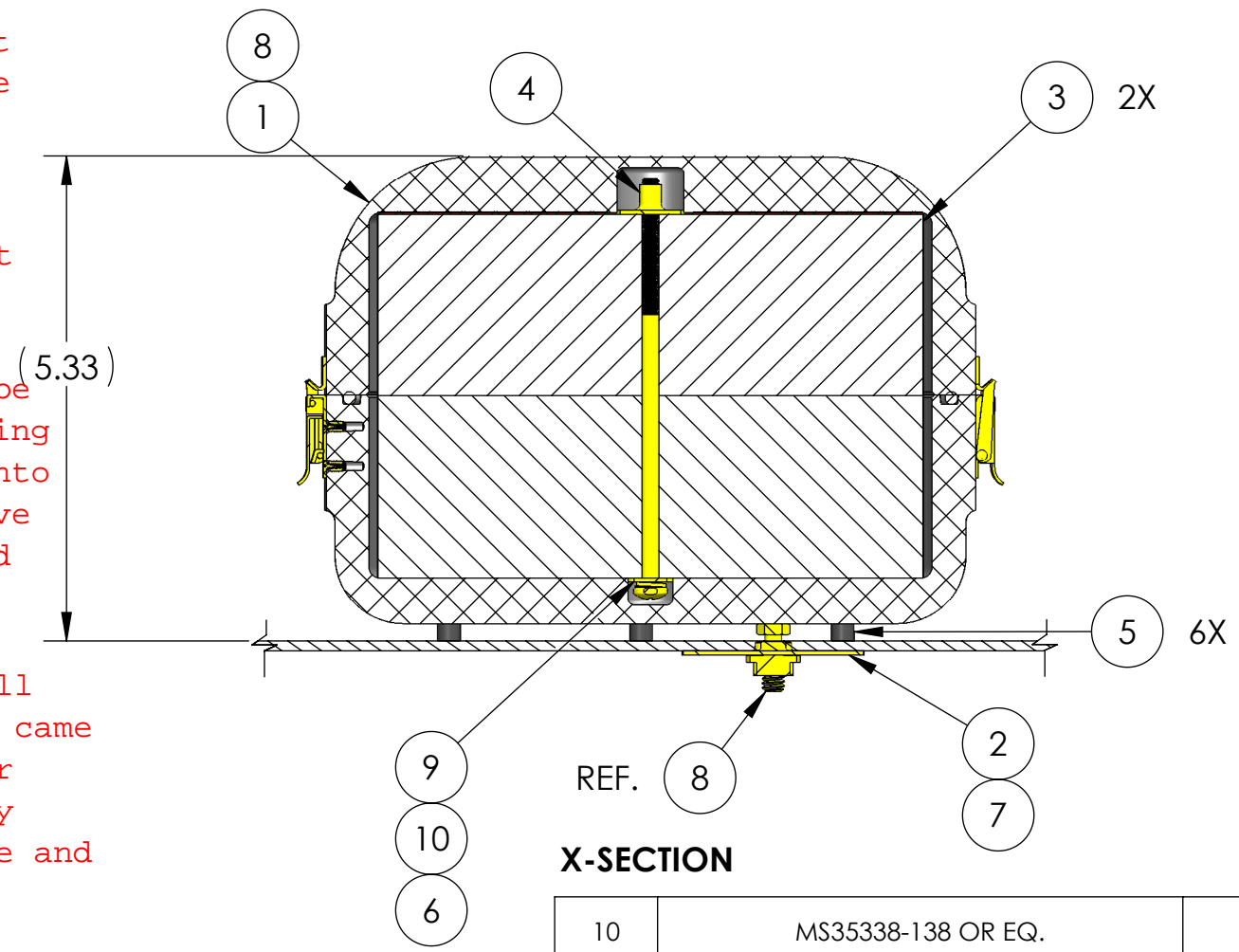
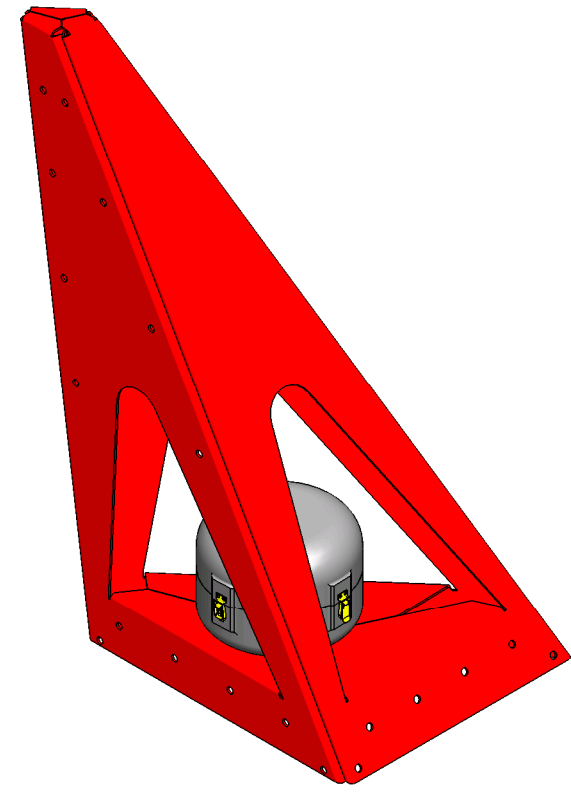

ISO VIEW

X-SECTION

ITEM NO.	PART NUMBER	DESCRIPTION	QTY.
10	MS35338-138 OR EQ.	WASHER, SPLIT-LOCK, NO. 10	1
9	MS15795-842 OR EQ.	WASHER, FLAT, NO. 10	1
8	95316A470 McMASTER-CARR OR EQ.	MALE/MALE ADPTER, 10-32 Screw x 3/8" Long TO 1/4"-20 Screw x 5/8" Long, 5/16" Hex	1
7	93776A421 McMASTER-CARR OR EQ.	FLANGED HEX NUT, 1/4"-20 Thread Size, 7/16" Wide, 15/64" Overall Height	1
6	91772A854 McMASTER-CARR OR EQ.	SCREW, PHP, 10-32 X 7.5 LG.	1
5	MAKE FROM: McMASTER-CARR 9029K12	VITON CORD, .25 OD. X .25 LG.	6
4	90860A107 McMASTER-CARR OR EQ.	WELD NUT, 3/4 BASE DIA. X 9/32 LG.	1
3	90385K46 McMASTER-CARR OR EQ.	LEAD DISC 6" OD X 25/64 ID., 2.0 THK.	2
2	D1400080	aLIGO, OPLEV, PASSIVE DAMPING ASSY., ABS ENCLOSURE	1
1	D1301005	aLIGO, OPLEV, PASSIVE DAMPING ASSY., ABS ENCLOSURE	1

PARTS LIST

NOTES AND TOLERANCES: (UNLESS OTHERWISE SPECIFIED)

DIMENSIONS ARE IN INCHES

MATERIAL	N/A	FINISH	N/A μinch	SYSTEM	ADVANCED LIGO	SUB-SYSTEM	AOS	PART NAME	aLIGO, AOS, Oplev Passive Damping Assembly	DESIGNER	E.JAMES	19 JAN 2012	SIZE	DWG. NO.	REV.
				NEXT ASSY	MULTIPLE					DRAFTER	E.SANCHEZ	19 JAN 2012	B	D1200962	v2
										CHECKER	SEE DCC	SEE DCC			
										APPROVAL	SEE DCC	SEE DCC	SCALE:	NTS	PROJECTION:

SCALE: NTS PROJECTION: SHEET 1 OF 1

D1200962 aLIGO, AOS, Oplev Passive Damping Assembly, PART PDM REV: X-001, DRAWING PDM REV: X-001