

- NOTES CONTINUED:**
5. SCRIBE, ENGRAVE (A VIBRATORY TOOL MAY BE USED), LASER MARK OR MECHANICALLY STAMP (NO INKS OR DYES) DRAWING PART NUMBER, REVISION (AND VARIANT OR 'TYPE' IF APPLICABLE) ON NOTED SURFACE OF PART FOLLOWED ON THE NEXT LINE WITH A THREE DIGIT SERIAL NUMBER. SERIAL NUMBERS START AT 001 FOR THE FIRST ARTICLE AND PROCEED CONSECUTIVELY. USE MINIMUM 0.12" HIGH CHARACTERS, UNLESS THE SIZE OF THE PART DICTATES SMALLER CHARACTERS. EXAMPLE: DXXXXXX-VY, TYPE-XX, S/N XXX
 6. APPROXIMATE WEIGHT = .33 LB.
 7. MACHINE ALL SURFACES TO REMOVE OXIDES AND MILL FINISH. USE OF ABRASIVE REMOVAL TECHNIQUES IS NOT ALLOWED. REFER TO LIGO-E0900364
 8. ALL PARTS SHALL BE MANUFACTURED IN ACCORDANCE WITH LIGO SPECIFICATION E0900364.
 9. ALL MATERIAL IS TO BE VIRGIN MATERIAL (i.e. NO WELD REPAIRS, PLUGS OR RECYCLED MATERIAL). NO REPAIRS SHALL BE MADE UNLESS APPROVED IN ADVANCE, AND IN WRITING, BY LIGO LABORATORY. REFER TO LIGO-E0900364.

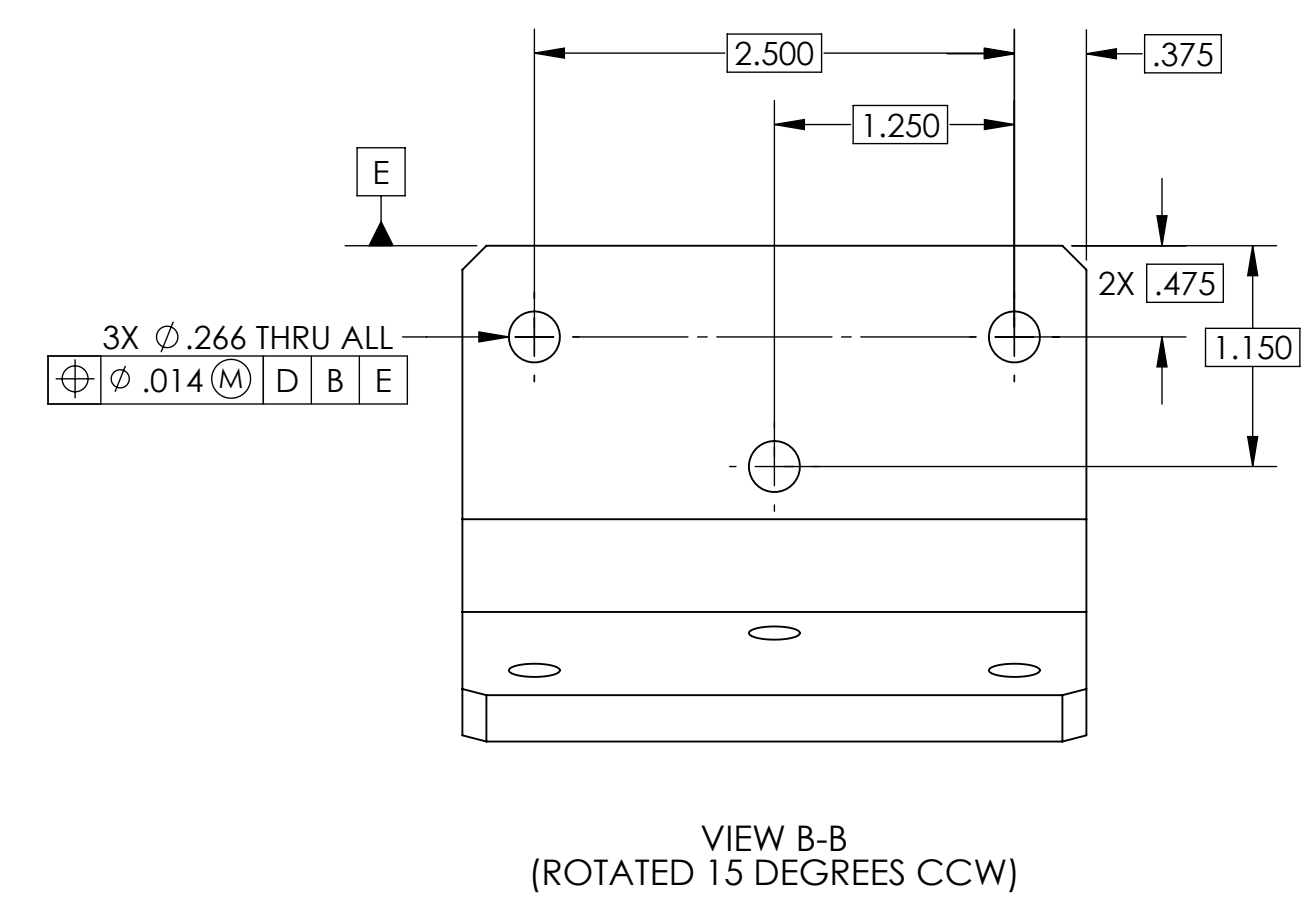

REV.	DATE	DCN #	DRAWING TREE #
v1	05 NOV 2012	E1200891-x0	E1201007-v2
v2	23 SEP 2013	E1300729-x0	E1201007-v3
-	-	-	-

TYPE	DESCRIPTION
-01	X-arm
-02	Y-arm

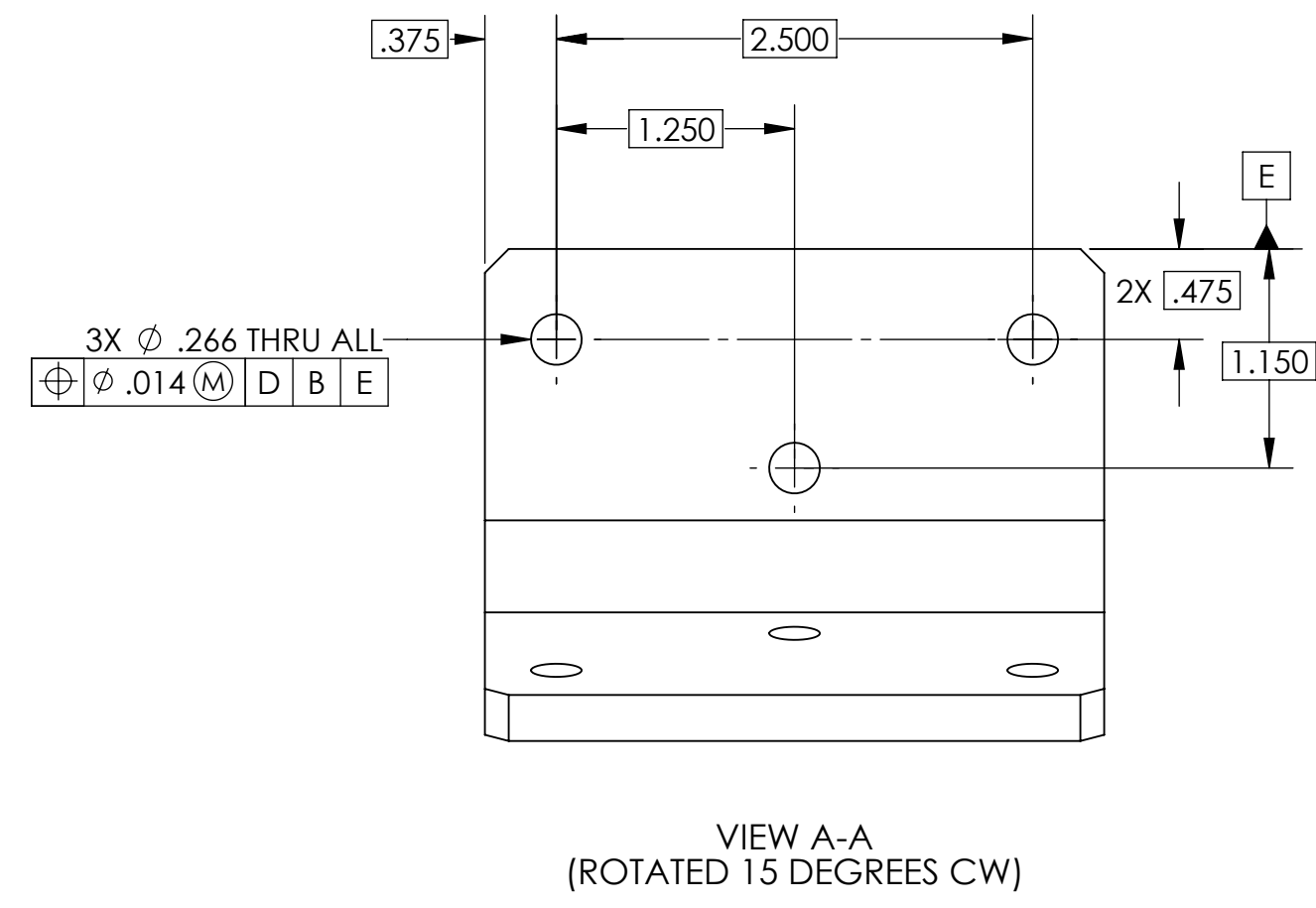
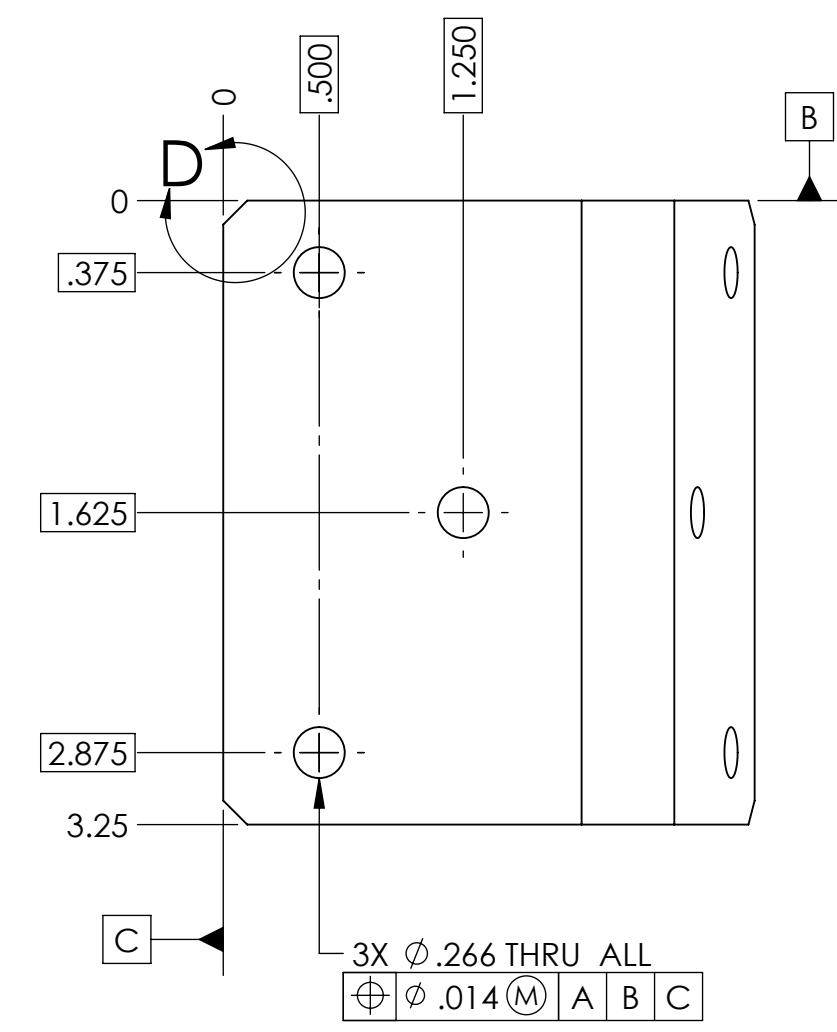
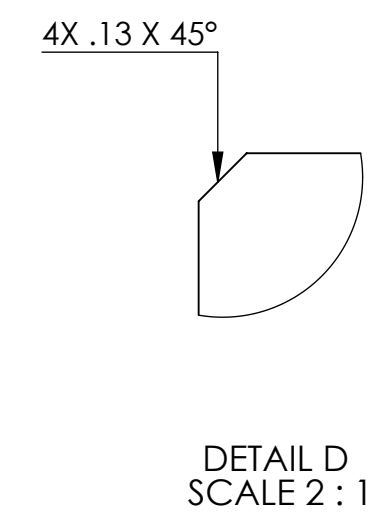
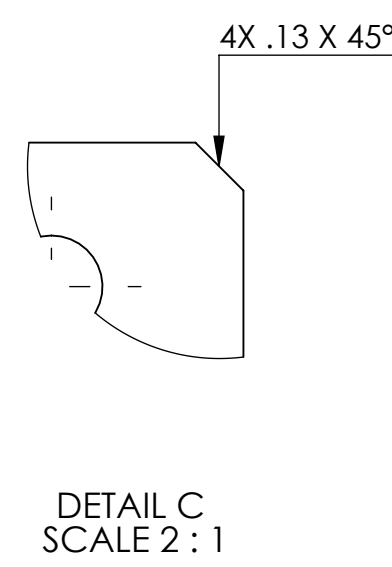
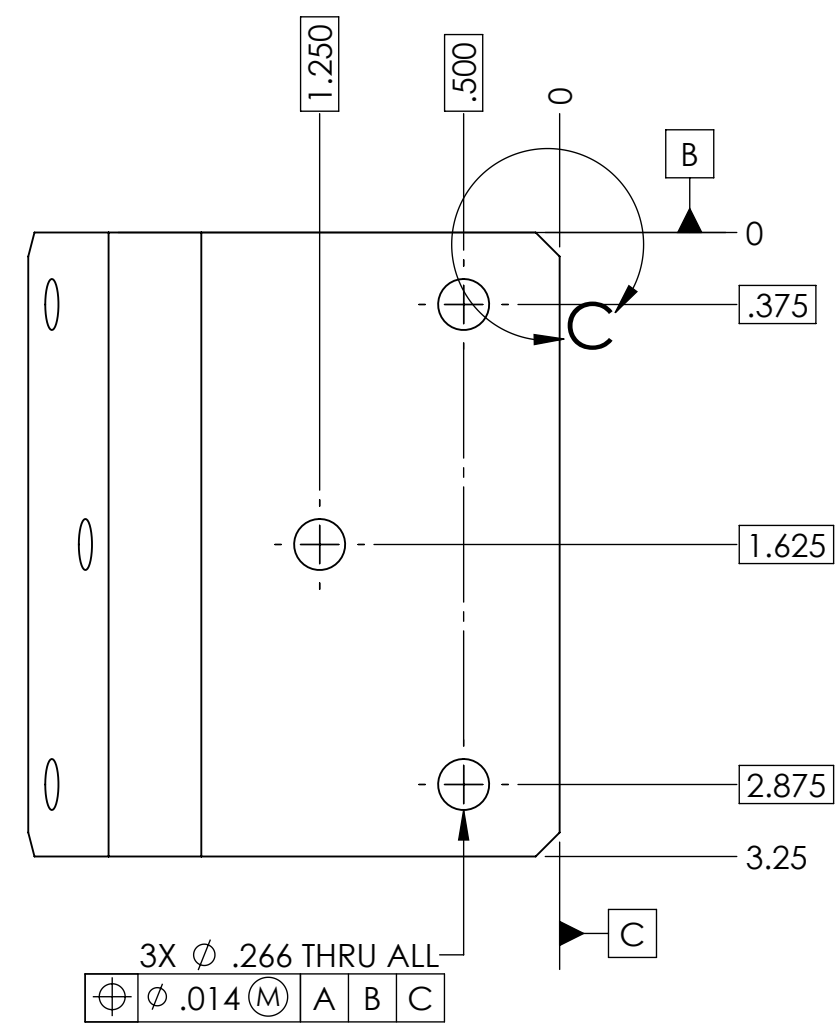
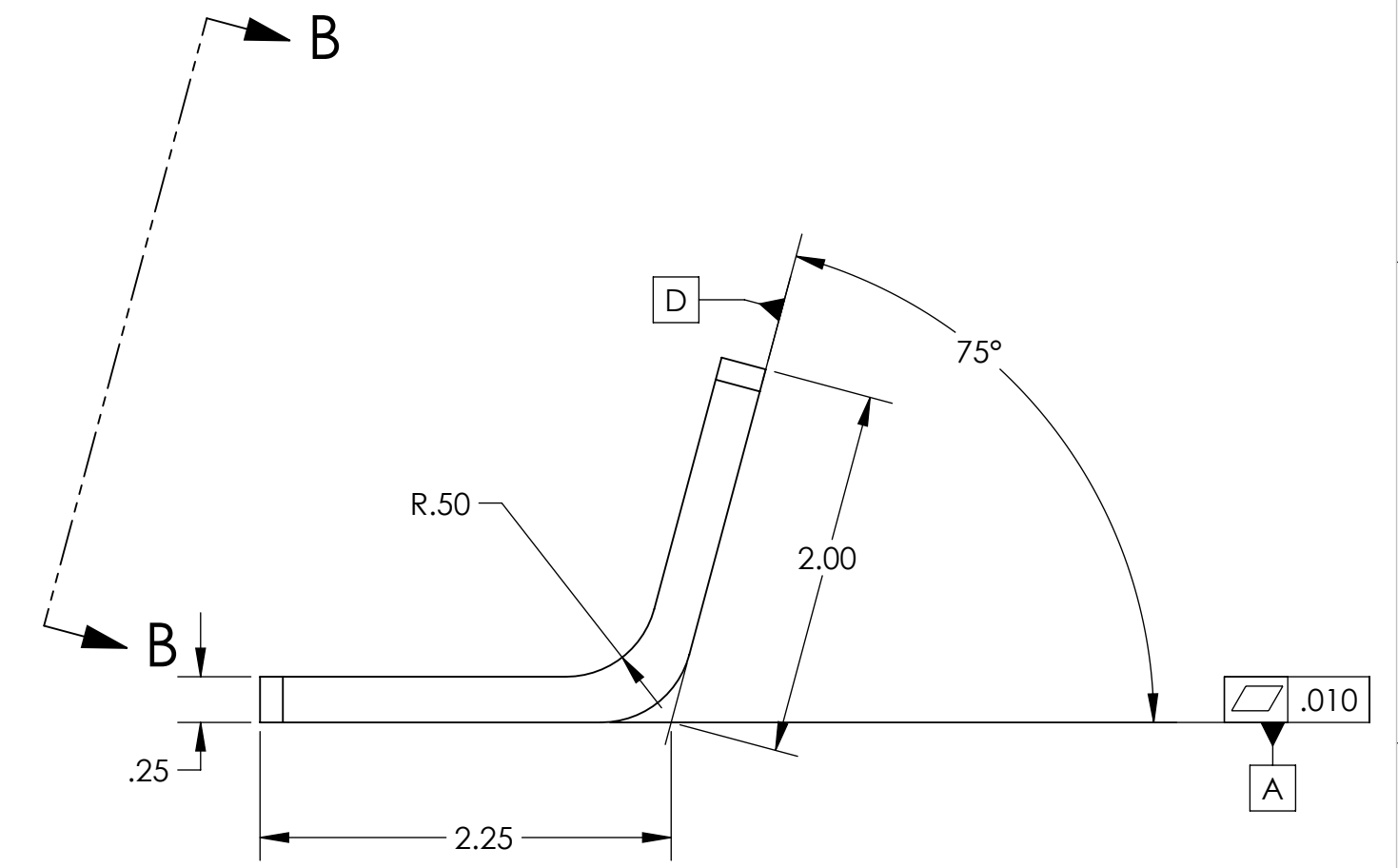
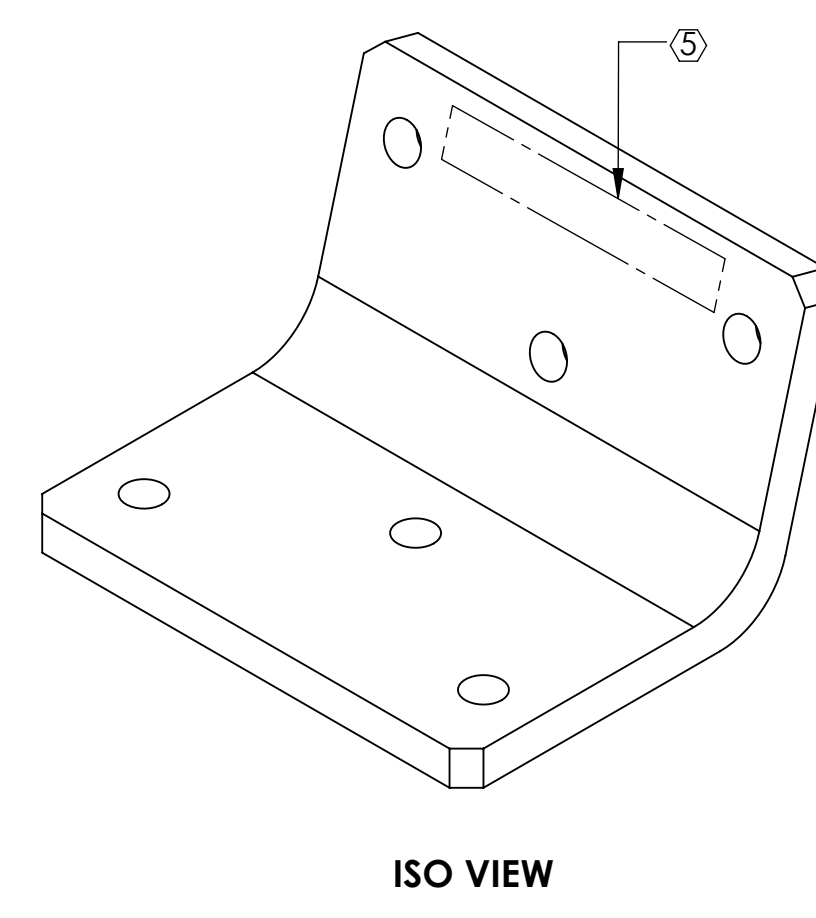
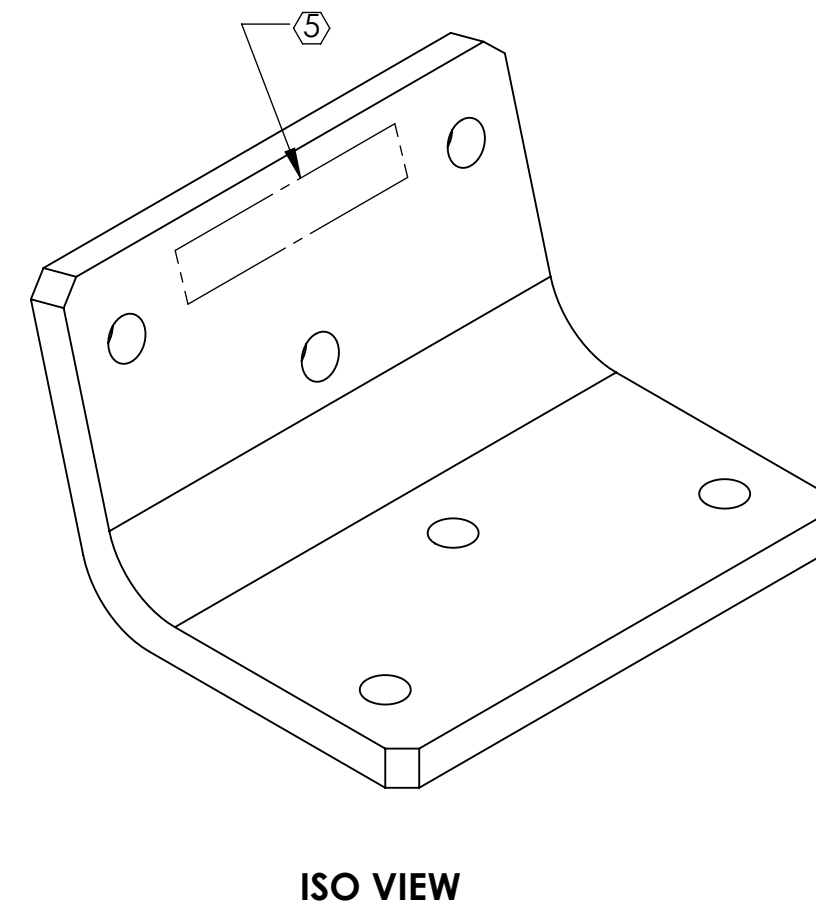
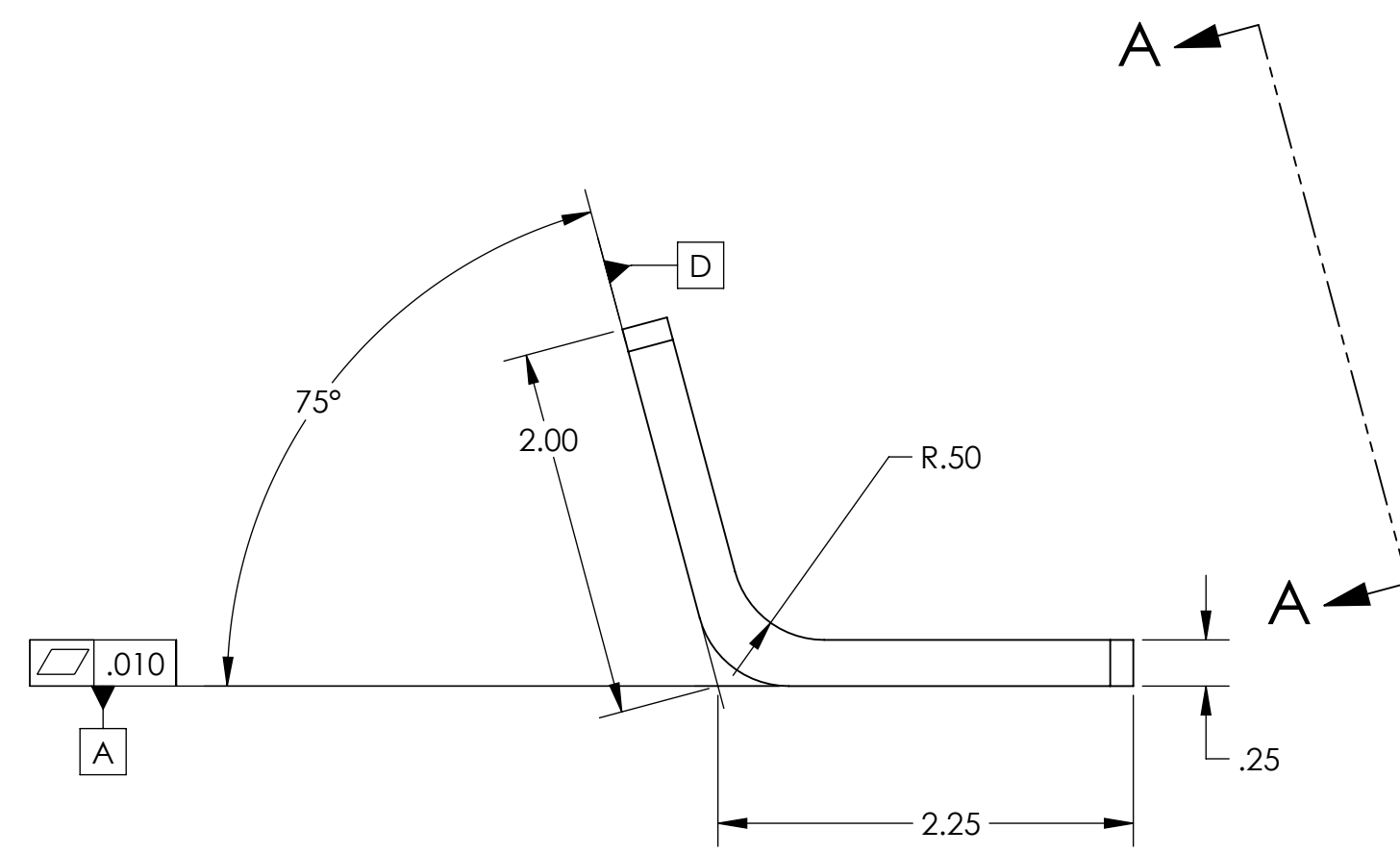

-02 DETAIL

-01 DETAIL

DIMENSIONS ARE IN INCHES		TOLERANCES:		ANGULAR ± 1.0°		MATERIAL		FINISH		NEXT ASSY		SYSTEM		SUB-SYSTEM		PART NAME	
.XX	± .01	.XXX	± .005			6061 Alloy		63 μinch		D1200953		ADVANCED LIGO		AOS		BACK SIDE WALL STRUT, CO2P PERISCOPE	
<p>NOTES AND TOLERANCES: (UNLESS OTHERWISE SPECIFIED)</p> <ol style="list-style-type: none"> 1. INTERPRET DRAWING PER ASME Y14.5-1994. 2. REMOVE ALL SHARP EDGES, .005-.015, FOR MACHINED PARTS. ROUND ALL EDGES APPROXIMATELY R.02. 3. DO NOT SCALE FROM DRAWING. 4. ALL MACHINING FLUIDS MUST BE FULLY SYNTHETIC, FULLY WATER SOLUBLE AND FREE OF SULFUR, SILICONE, AND CHLORINE. 																	
<p>DESIGNER: M. JACOBSON DATE: 21 SEPT 2012 SIZE: DWG. NO. REV.:</p> <p>DRAFTER: E.SANCHEZ DATE: 02 NOV 2012 D D1201371 v2</p> <p>CHECKER: M. JACOBSON DATE: 02 NOV 2012</p> <p>APPROVAL: SCALE: 1:1 PROJECTION: SHEET 1 OF 1</p>																	

D:\201371_BACK_SIDE_WALL_STRUT_CO2P_PERISCOPE_PART_PDM_REV_X-004_DRAWING_PDM_REV_X-006