

D1201528\_IR SENSOR SUBASSEMBLY AD1101627\_VIEWPORT ENCLOSURE ASSY, H1-L1 CO2P, PART PDM REV: X-003, DRAWING PDM REV: X-002

REV.	DATE	DCN #	DRAWING TREE #
v1	DEC 05 2012	E1200247-x0	E1200248-v1
-	-	-	-
-	-	-	-

TYPE	DESCRIPTION
-01	X-ARM CONFIG.
-02	Y-ARM CONFIG.

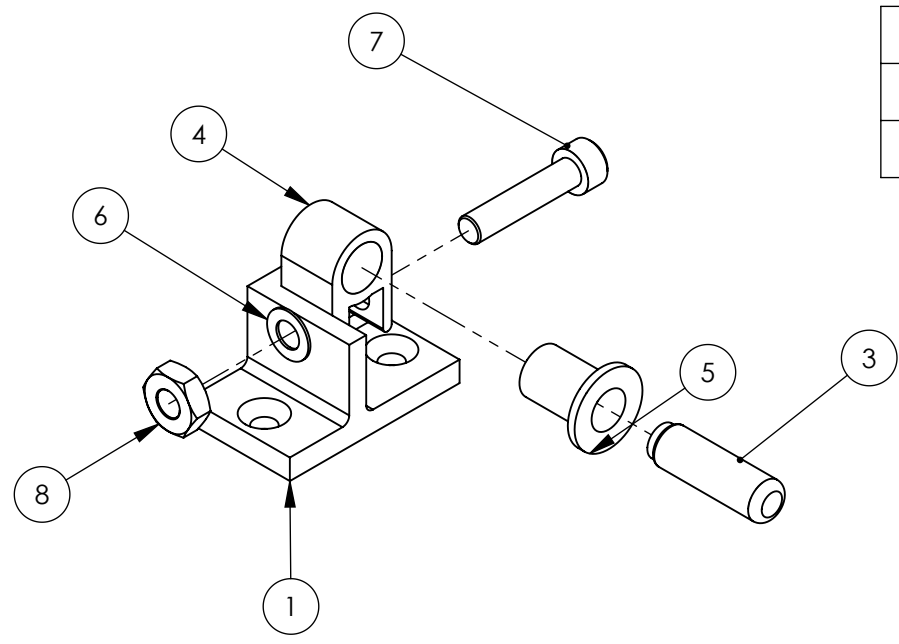

**EXPLODED**  
(IR SENSOR CABLE NOT SHOWN)

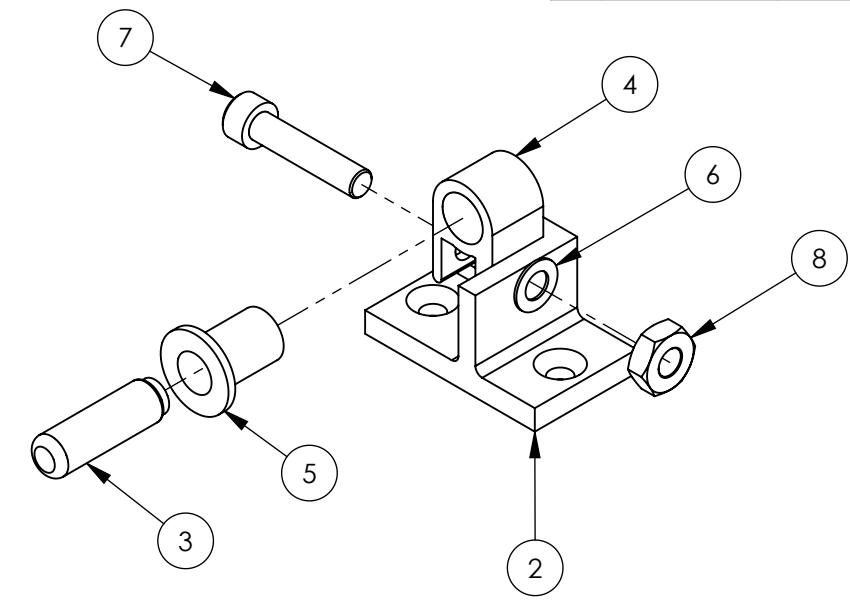
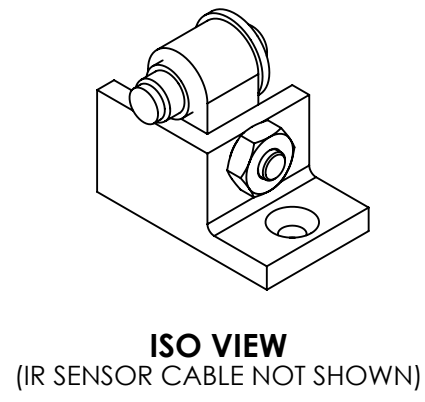
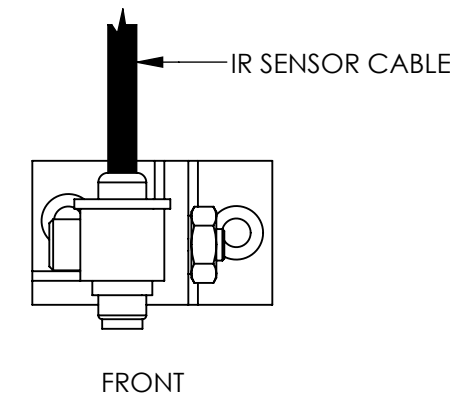

**EXPLODED**  
(IR SENSOR CABLE NOT SHOWN)

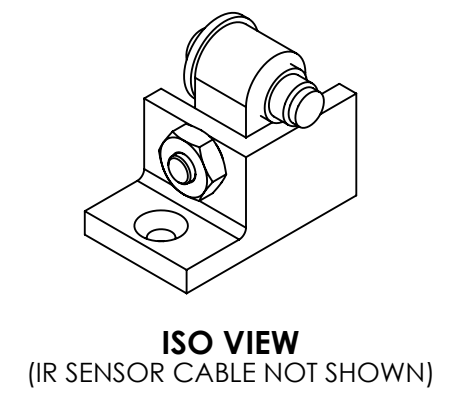
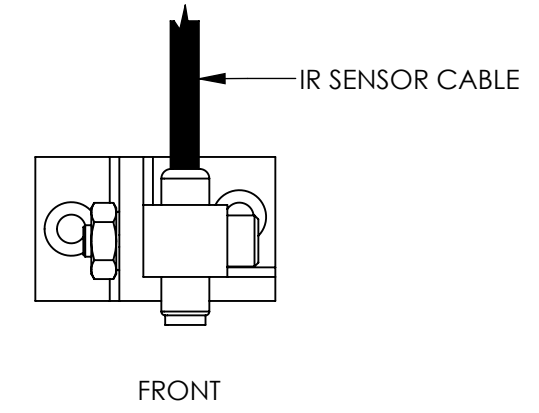

**-01 DETAIL**

**-02 DETAIL**

ITEM NO.	PART NUMBER	DESCRIPTION	D1201528-01/QTY.	D1201528-02/QTY.
8	N-832 UC COMPONENTS OR EQ.	HEX NUT, #8-32	1	1
7	C-812 UC COMPONENTS OR EQ.	SCREW, SOCKET HEAD CAP, #8-32 UNC-2A X 0.75 LONG	1	1
6	WF-08 UC COMPONENTS OR EQ.	WASHER, FLAT, #8 (NAS 620-C8L OR EQUIVALENT)	1	1
5	6627K14 McMASTER-CARR	PEEK Flanged Sleeve Bearing. 0.25" ID, 5/16" OD, 1/2" L, 1/2" Flange OD	1	1
4	53175K21 McMASTER-CARR	MINI BOLT TUBE CLAMP, ID RANGE .2967 TO .3281, SSSL	1	1
3	OS36SM-K-1xxF OMEGA	OMEGA SUMINI IR SENSOR	1	1
2	D1201507-02	SUPPORT BLOCK, IR SENSOR (Yarm)	-	1
1	D1201507-01	SUPPORT BLOCK, IR SENSOR (Xarm)	1	-
PARTS LIST				

**NOTES AND TOLERANCES: (UNLESS OTHERWISE SPECIFIED)**

DIMENSIONS ARE IN INCHES

TOLERANCES:  
 .XX ± .01  
 .XXX ± .005  
 ANGULAR ± 1.0°

1. INTERPRET DRAWING PER ASME Y14.5-1994.  
 2. REMOVE ALL SHARP EDGES, .005-.015, FOR MACHINED PARTS. ROUND ALL EDGES APPROXIMATELY R.02.  
 3. DO NOT SCALE FROM DRAWING.  
 4. ALL MACHINING FLUIDS MUST BE FULLY SYNTHETIC, FULLY WATER SOLUBLE AND FREE OF SULFUR, SILICONE, AND CHLORINE.

**MATERIAL** N/A      **FINISH** N/A μinch

CALIFORNIA INSTITUTE OF TECHNOLOGY MASSACHUSETTS INSTITUTE OF TECHNOLOGY		<b>PART NAME</b> IR SENSOR SUB-ASSY	
<b>SYSTEM</b> ADVANCED LIGO	<b>SUB-SYSTEM</b> AOS	<b>DESIGNER</b> E.SANCHEZ	<b>DATE</b> DEC 05 2012
<b>DRAFTER</b> M. JACOBSON	<b>CHECKER</b> M. JACOBSON	<b>DATE</b> DEC 05 2012	<b>DATE</b> DEC 05 2012
<b>APPROVAL</b> M. JACOBSON	<b>SCALE</b> 1:1	<b>PROJECTION</b> 	<b>SHEET</b> 1 OF 1