

| REV. | DATE | DCN # | DRAWING TREE # |
|------|-------------|-------------|----------------|
| v1 | 15 JAN 2013 | - | - |
| v2 | 05 FEB 2013 | E1300029-x0 | - |
| - | - | - | - |

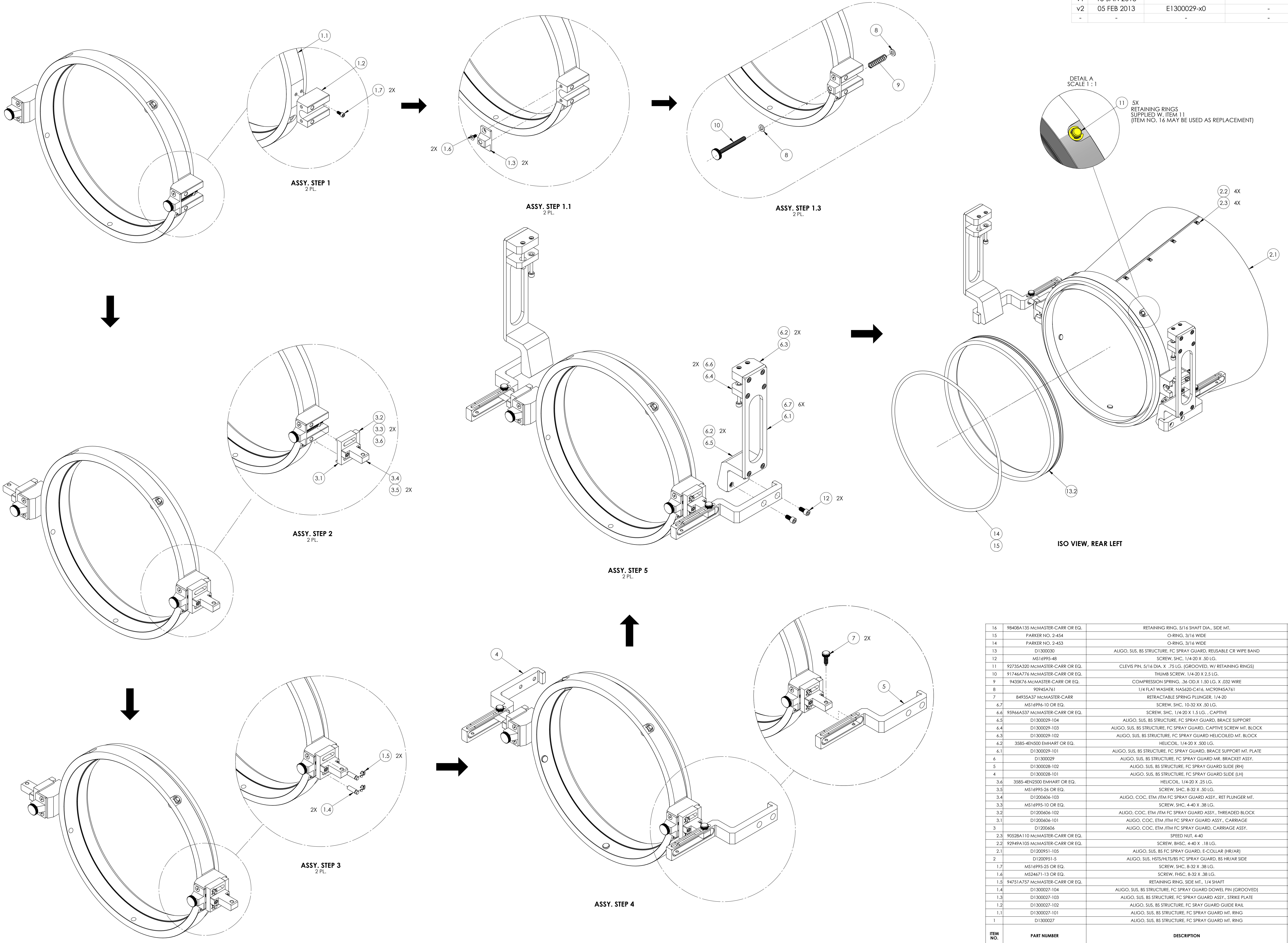

| ITEM NO. | PART NUMBER | DESCRIPTION | QTY. |
|----------|--------------------------------|---|------|
| 16 | 98408A135 McMaster-Carr OR EQ. | RETAINING RING, 5/16 SHAFT DIA., SIDE MT. | A/R |
| 15 | PARKER NO. 2-454 | O-RING, 3/16 WIDE | 1 |
| 14 | PARKER NO. 2-453 | O-RING, 3/16 WIDE | 1 |
| 13 | D1300030 | ALIGO, SUS. BS STRUCTURE, FC SPRAY GUARD, REUSABLE CR WIPE BAND | 1 |
| 12 | MS16995-48 | SCREW, SHC, 1/4-20 X .50 LG. | 4 |
| 11 | 92735A320 McMaster-Carr OR EQ. | CLEVIS PIN, 5/16 DIA. X .75 LG. (GROOVED, W/ RETAINING RINGS) | 5 |
| 10 | 91746A776 McMaster-Carr OR EQ. | THUMB SCREW, 1/4-20 X 2.5 LG. | 2 |
| 9 | 9439K76 McMaster-Carr OR EQ. | COMPRESSION SPRING, .36 OD X 1.50 LG. X .032 WIRE | 2 |
| 8 | 90945A761 | 1/4 FLAT WASHER, NAS620-C416, MC90945A761 | 4 |
| 7 | 84935A37 McMaster-Carr | RETRACTABLE SPRING PLUNGER, 1/4-20 | 2 |
| 6.7 | MS16996-10 OR EQ. | SCREW, SHC, 10-32 XX .50 LG. | 6 |
| 6.6 | 95966A537 McMaster-Carr OR EQ. | SCREW, SHC, 1/4-20 X 1.5 LG., CAPTIVE | 2 |
| 6.5 | D1300029-104 | ALIGO, SUS. BS STRUCTURE, FC SPRAY GUARD, BRACE SUPPORT | 1 |
| 6.4 | D1300029-103 | ALIGO, SUS. BS STRUCTURE, FC SPRAY GUARD, CAPTIVE SCREW MT. BLOCK | 1 |
| 6.3 | D1300029-102 | ALIGO, SUS. BS STRUCTURE, FC SPRAY GUARD HELICOILED MT. BLOCK | 1 |
| 6.2 | 3585-4EN500 EMHART OR EQ. | HELICOIL, 1/4-20 X .500 LG. | 4 |
| 6.1 | D1300029-101 | ALIGO, SUS. BS STRUCTURE, FC SPRAY GUARD, BRACE SUPPORT MT. PLATE | 1 |
| 5 | D1300029 | ALIGO, SUS. BS STRUCTURE, FC SPRAY GUARD MR. BRACKET ASSY. | 2 |
| 4 | D1300028-102 | ALIGO, SUS. BS STRUCTURE, FC SPRAY GUARD SLIDE [RH] | 1 |
| 3.6 | 3585-4EN2500 EMHART OR EQ. | HELICOIL, 1/4-20 X .25 LG. | 1 |
| 3.5 | MS16995-26 OR EQ. | SCREW, SHC, 8-32 X .50 LG. | 2 |
| 3.4 | D1200606-103 | ALIGO, COC. ETM /ITM FC SPRAY GUARD ASSY., RET PLUNGER MT. | 1 |
| 3.3 | MS16995-10 OR EQ. | SCREW, SHC, 4-40 X .38 LG. | 2 |
| 3.2 | D1200606-102 | ALIGO, COC. ETM /ITM FC SPRAY GUARD ASSY., THREADED BLOCK | 1 |
| 3.1 | D1200606-101 | ALIGO, COC. ETM /ITM FC SPRAY GUARD ASSY., CARRIAGE | 1 |
| 3 | D1200606 | ALIGO, COC. ETM /ITM FC SPRAY GUARD, CARRIAGE ASSY. | 2 |
| 2.3 | 90528A110 McMaster-Carr OR EQ. | SPEED NUT, 4-40 | 4 |
| 2.2 | 92949A105 McMaster-Carr OR EQ. | SCREW, BHSC, 4-40 X .18 LG. | 4 |
| 2.1 | D1200951-105 | ALIGO, SUS. BS FC SPRAY GUARD, E-COLLAR (HR/AR) | 1 |
| 2 | D1200951-5 | ALIGO, SUS. HSTS/HLTS/BS FC SPRAY GUARD, BS HR/AR SIDE | 1 |
| 1.7 | MS16995-25 OR EQ. | SCREW, SHC, 8-32 X .38 LG. | 4 |
| 1.6 | MS24671-13 OR EQ. | SCREW, FHSC, 8-32 X .38 LG. | 4 |
| 1.5 | 94751A757 McMaster-Carr OR EQ. | RETAINING RING, SIDE MT., 1/4 SHAFT | 4 |
| 1.4 | D1300027-104 | ALIGO, SUS. BS STRUCTURE, FC SPRAY GUARD DOWEL PIN (GROOVED) | 4 |
| 1.3 | D1300027-103 | ALIGO, SUS. BS STRUCTURE, FC SPRAY GUARD ASSY., STRIKE PLATE | 2 |
| 1.2 | D1300027-102 | ALIGO, SUS. BS STRUCTURE, FC SPRAY GUARD GUIDE RAIL | 2 |
| 1.1 | D1300027-101 | ALIGO, SUS. BS STRUCTURE, FC SPRAY GUARD MT. RING | 1 |
| 1 | D1300027 | ALIGO, SUS. BS STRUCTURE, FC SPRAY GUARD MT. RING | 1 |

NOTES AND TOLERANCES: (UNLESS OTHERWISE SPECIFIED)

ADVANCED LIGO SUB-SYSTEM **SUS**

MATERIAL: N/A FINISH: N/A μinch NEXT ASSY: MULTIPLE

DESIGNER: E.SANCHEZ 15-JAN-2013 SIZE: DWG. NO. **E** D1300031 REV. v2

DRAFTER: E.SANCHEZ 15-JAN-2013 CHECKER: SEE DCC APPROVAL: SEE DCC

SCALE: 1:2 PROJECTION: SHEET 1 OF 2

D:\30001\MGCO\SUS_BS_STRUCTURE\FC_SPRAY_GUARD_ASSY_PART_DRAWING\X02_DRAWING_DRAWING.X02

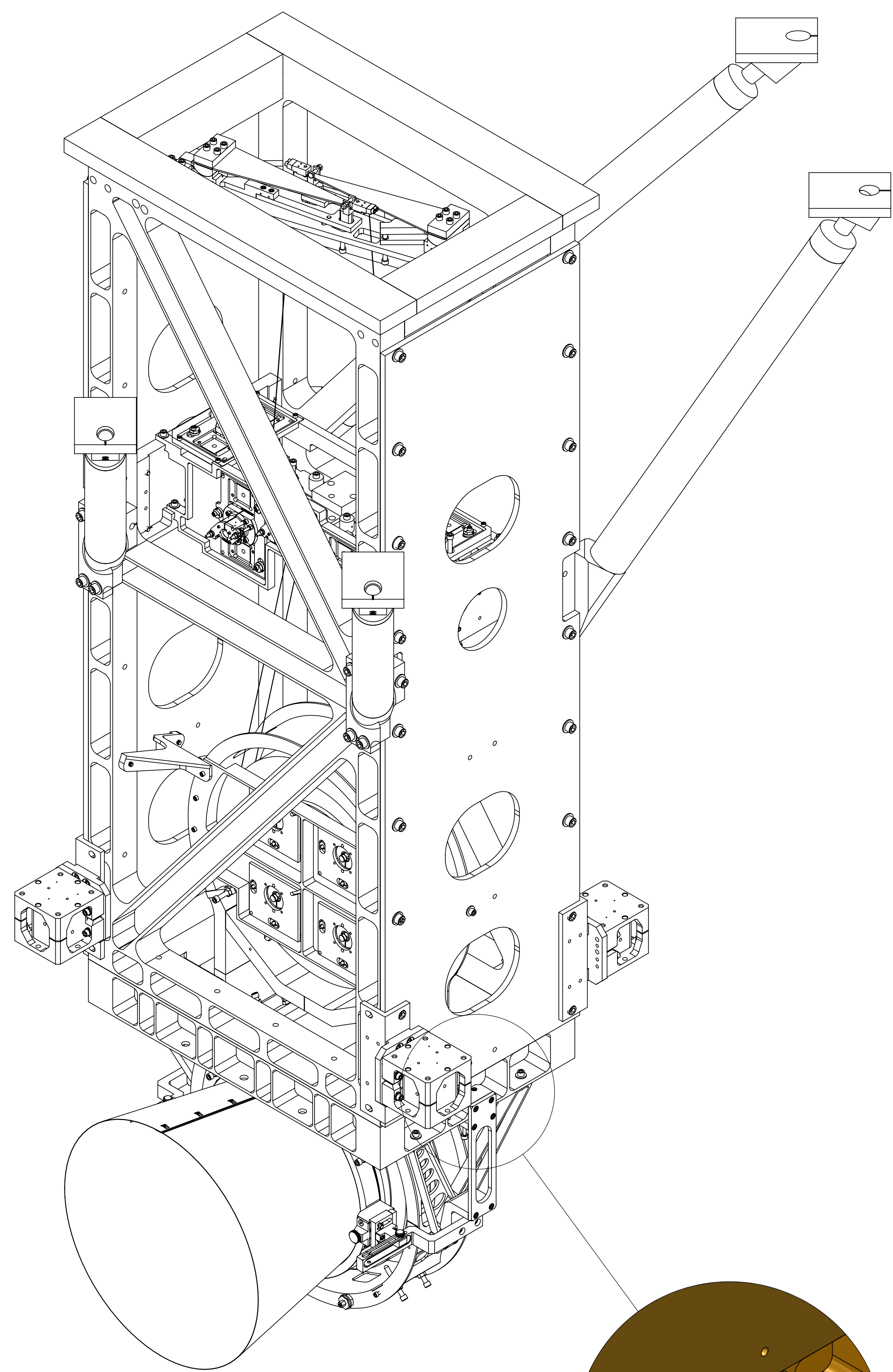

ISO VIEW
SCALE 1:4

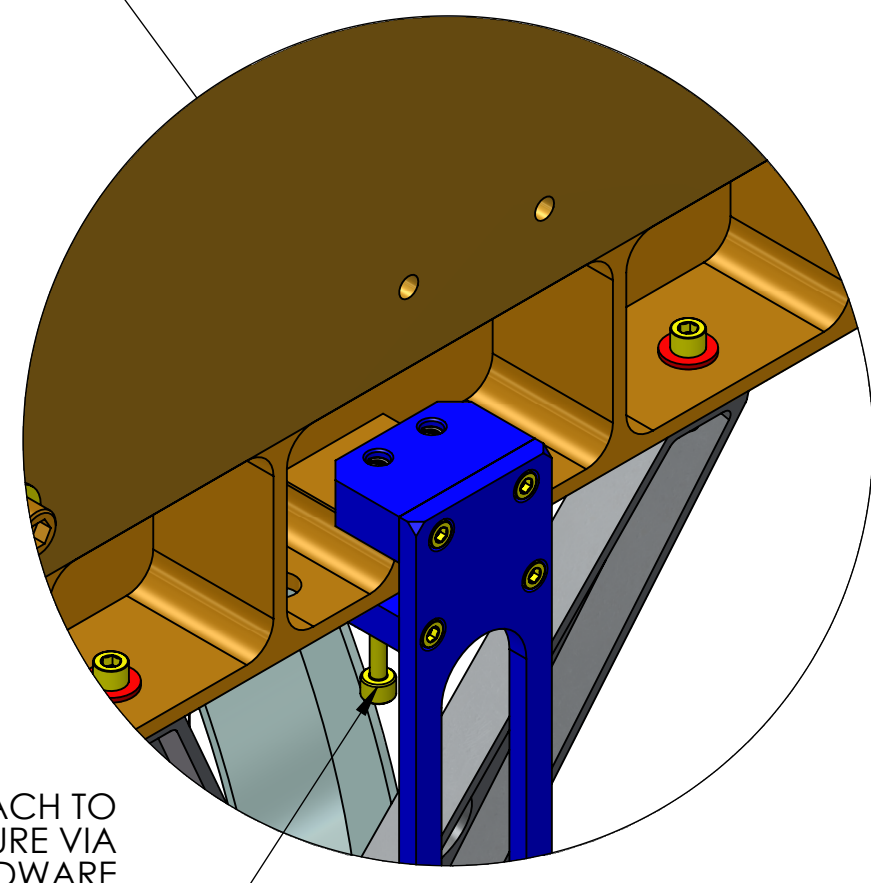

ATTACH TO
STRUCTURE VIA
CAPTIVE HARDWARE
SUPPLIED WITH
ITEM NO. 6
QTY. 2
4 FL.

DETAIL B

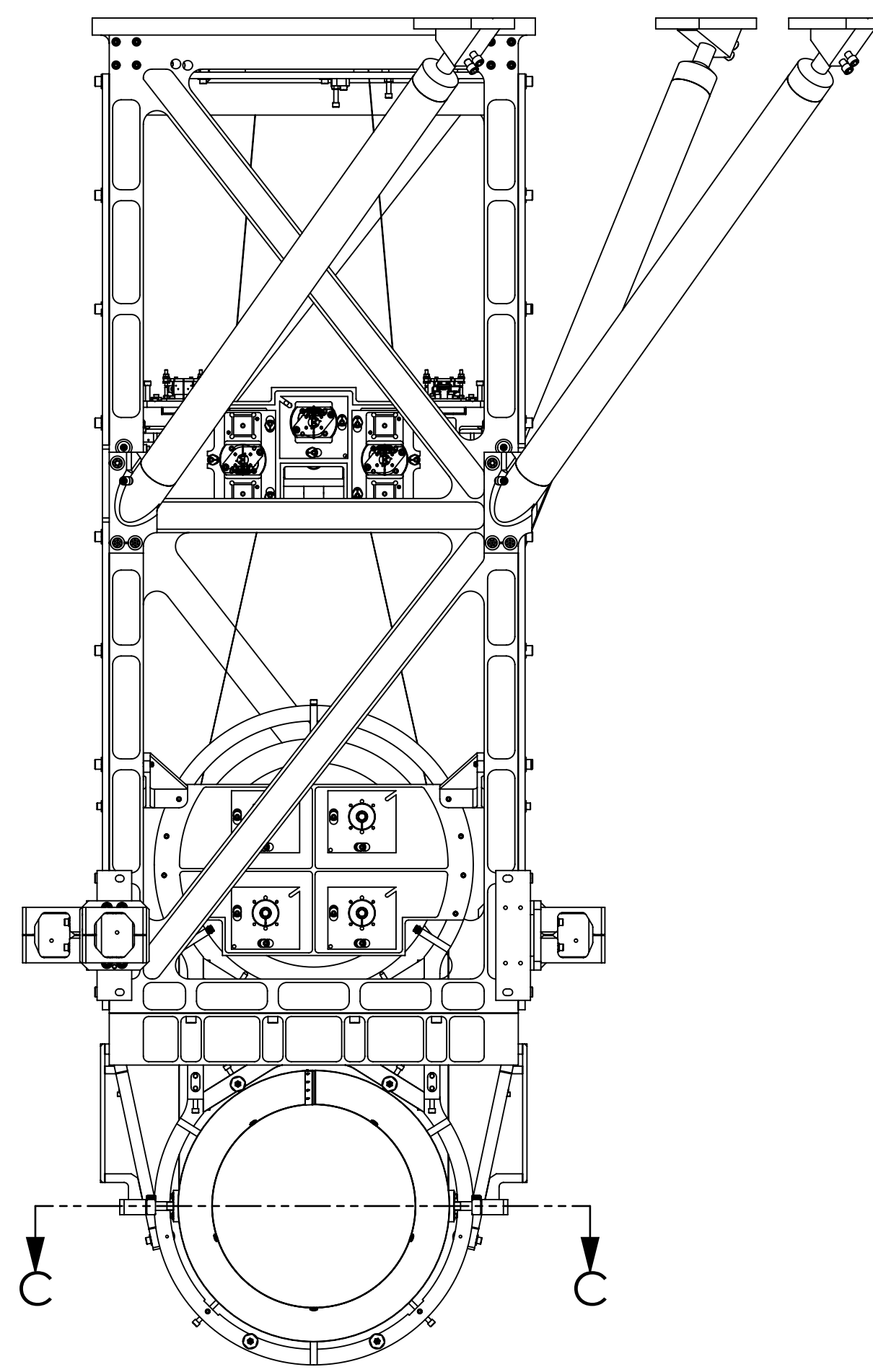

FRONT VIEW
SCALE 1:8

SPRAY GUARD , IN SERVICE

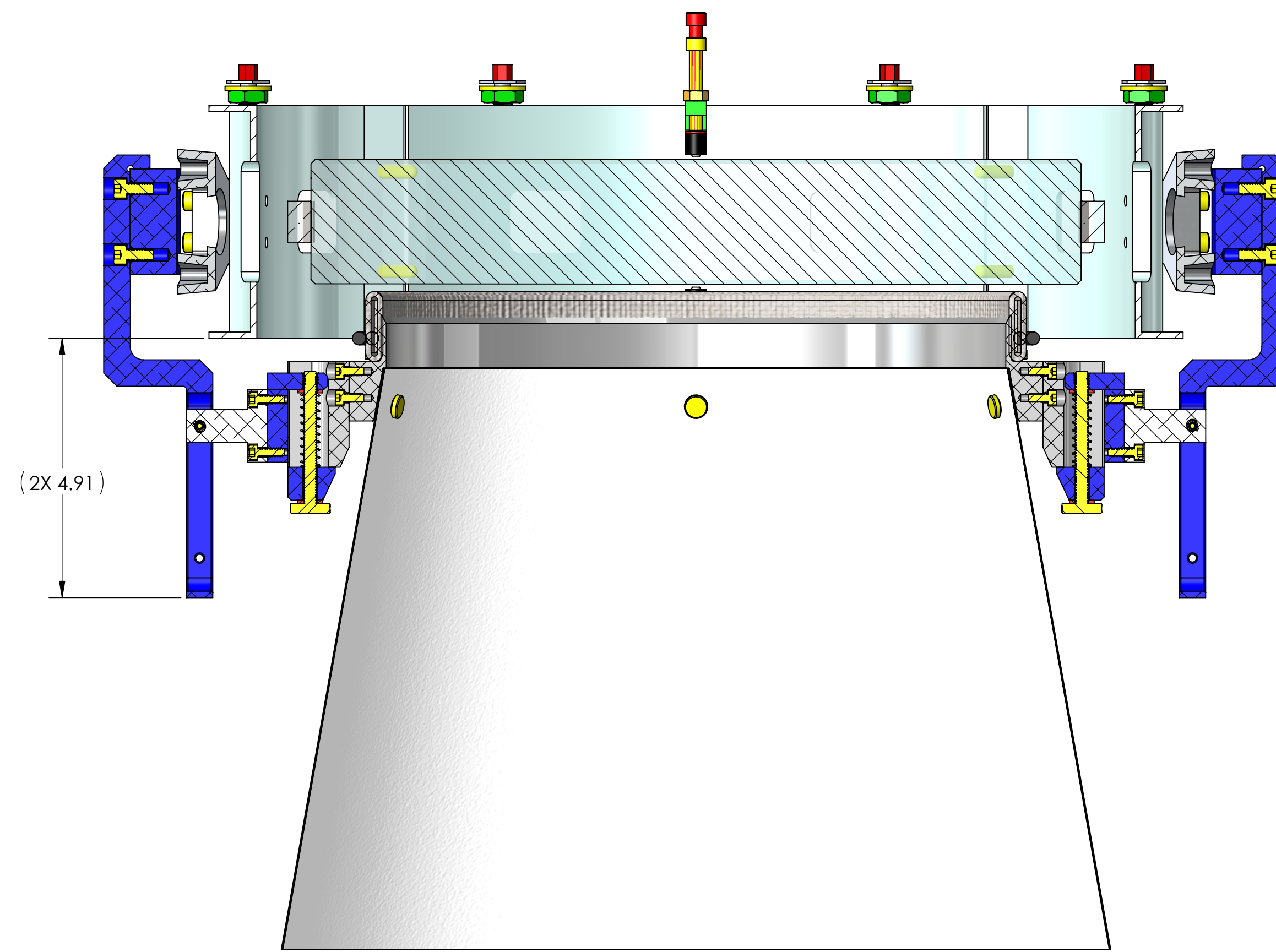

SECTION C-C

SPRAY GUARD , RETRACTED

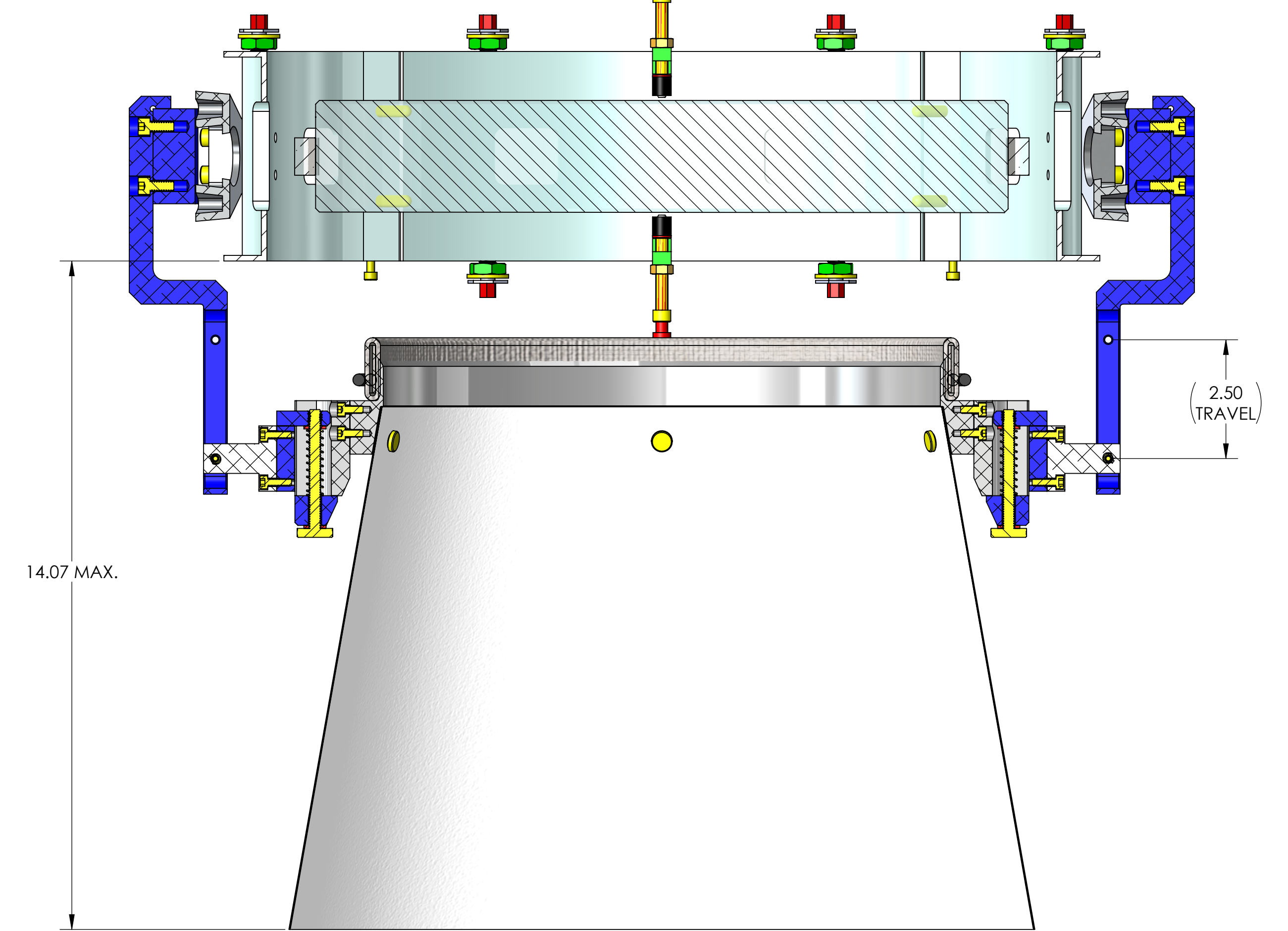

SECTION C-C

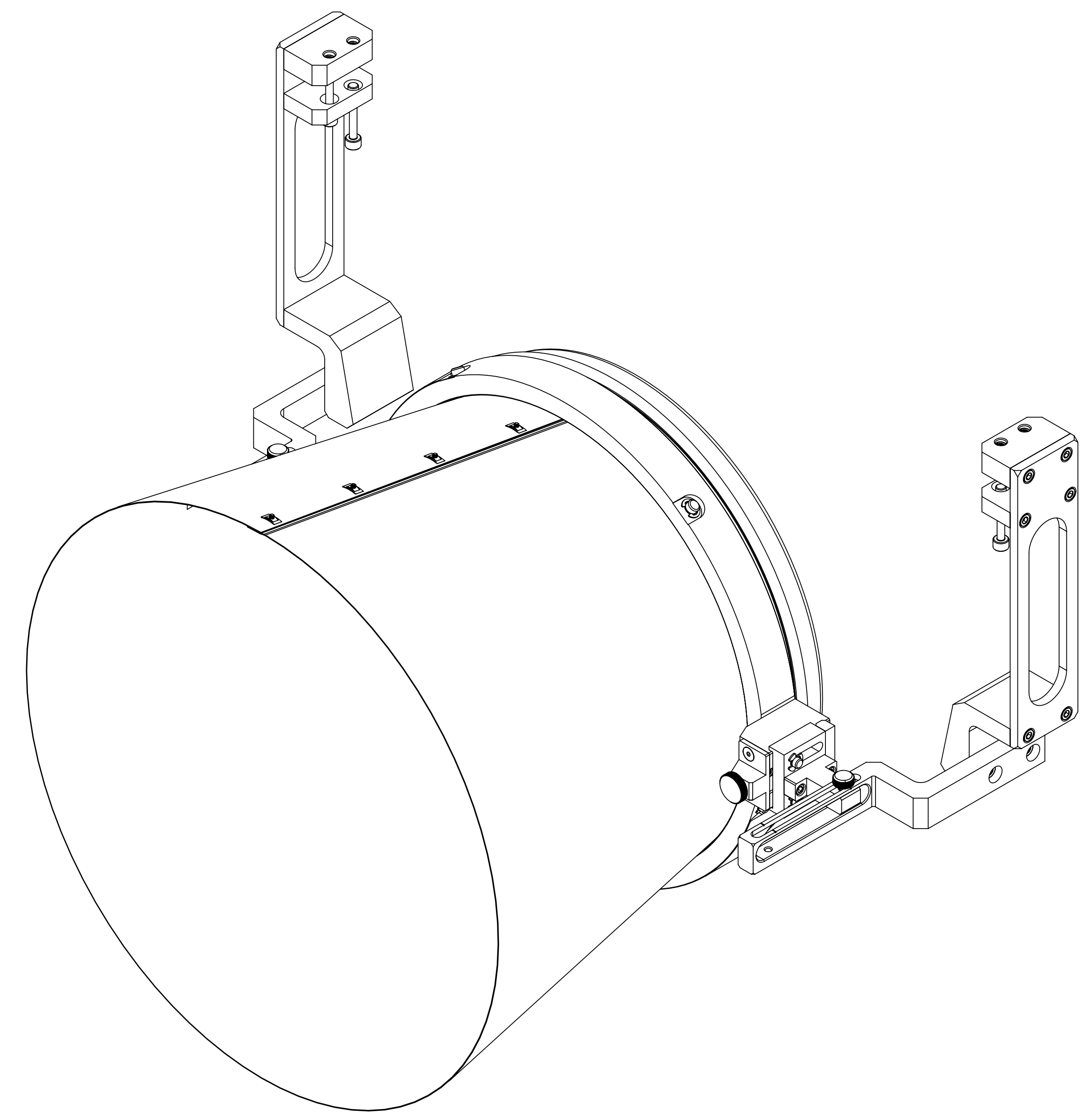

ISO VIEW