

D1300367_alIGO_OMCS_Transport_Handle_Assembly, PART PDM REV: X-003, DRAWING PDM REV: X-000

REV.	DATE	DCN #	DRAWING TREE #
v1	28 JAN 2013	E1300085	E0900061
-	-	-	-
-	-	-	-

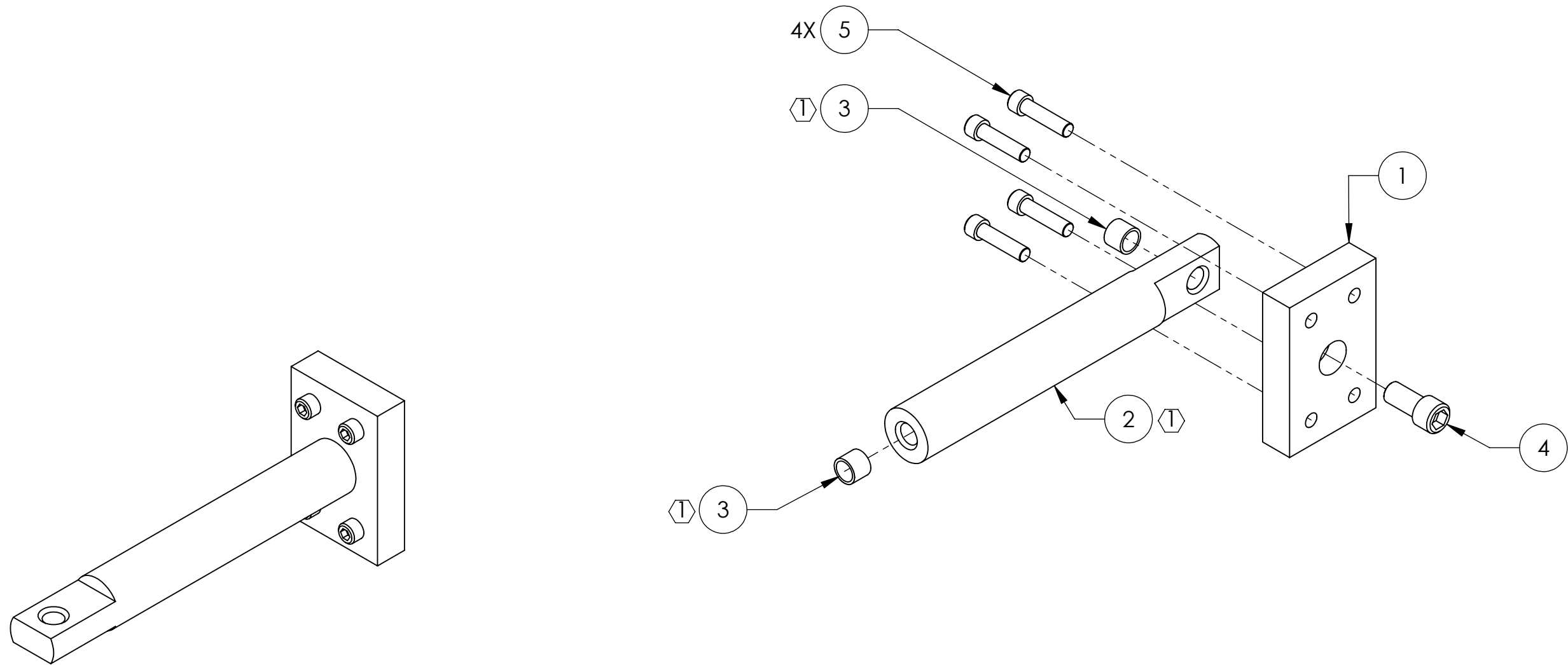

ALTERNATE CONFIGURATION

ITEM NO.	PART NUMBER	DESCRIPTION	MATERIAL	REQ	SPARE	TOTAL
5	-	SCREW, SOCKET HEAD CAP, 1/4-20 UNC-2A X 1 LONG	300 SSTL	4	1	5
4	-	SCREW, SOCKET HEAD CAP, 3/8-16 UNC-2A X 0.75 LONG	300 SSTL	1	0	1
3	1185-6EN375	HELICOIL, 3/8-16 X 0.375 LONG (T)	NITRONIC 60	2	1	3
2	D1002718	TRANSPORT HANDLE (T)	6061-T6 Al	1	0	1
1	D1002717	TRANSPORT HANDLE MOUNTING PLATE	6061-T6 Al	1	0	1

PARTS LIST

NOTES AND TOLERANCES: (UNLESS OTHERWISE SPECIFIED)		CALIFORNIA INSTITUTE OF TECHNOLOGY MASSACHUSETTS INSTITUTE OF TECHNOLOGY		PART NAME	
(T) HELICOILS TO BE INSTALLED INTO ITEM NO. 2 BY LIGO PERSONNEL PRIOR TO ASSEMBLY AND AFTER ALL PARTS ARE CLEANED AND BAKED.		SYSTEM ADVANCED LIGO		SUB-SYSTEM SUS	
MATERIAL		NEXT ASSY		DESIGNER M. MEYER 13 OCT 2010 DRAFTER D. BRIDGES 13 OCT 2010 CHECKER B. MOORE 14 OCT 2010 APPROVAL	
N/A		N/A		PART NAME TRANSPORT HANDLE ASSEMBLY (OMCS)	
FINISH		SCALE: 1:2		DWG. NO. D1300367	
N/A μinch		PROJECTION:		REV. v1	
		SHEET 1 OF 1			