

8 7 6 5 4 3 2 1

NOTES CONTINUED:

④ SCRIBE, ENGRAVE (A VIBRATORY TOOL MAY BE USED), LASER MARK OR MECHANICALLY STAMP (NO INKS OR DYES) DRAWING PART NUMBER, REVISION ON NOTED SURFACE OF PART FOLLOWED ON THE NEXT LINE WITH A THREE DIGIT SERIAL NUMBER. SERIAL NUMBERS START AT 001 FOR THE FIRST ARTICLE AND PROCEED CONSECUTIVELY. USE MINIMUM 0.12" HIGH CHARACTERS. EXAMPLE: D1300778-V2, S/N 001

D 5. WEIGHT: 1.42 LB.

⑥ SCRIBE PART ALL ACROSS AT NOTED LOCATIONS, .015 WIDE MAX.

REV.	DATE	DCN #	B OM #
v1	03 DEC 2013	-	-
v2	07 DEC 2013	E1300936-x0	-
-	-	-	-

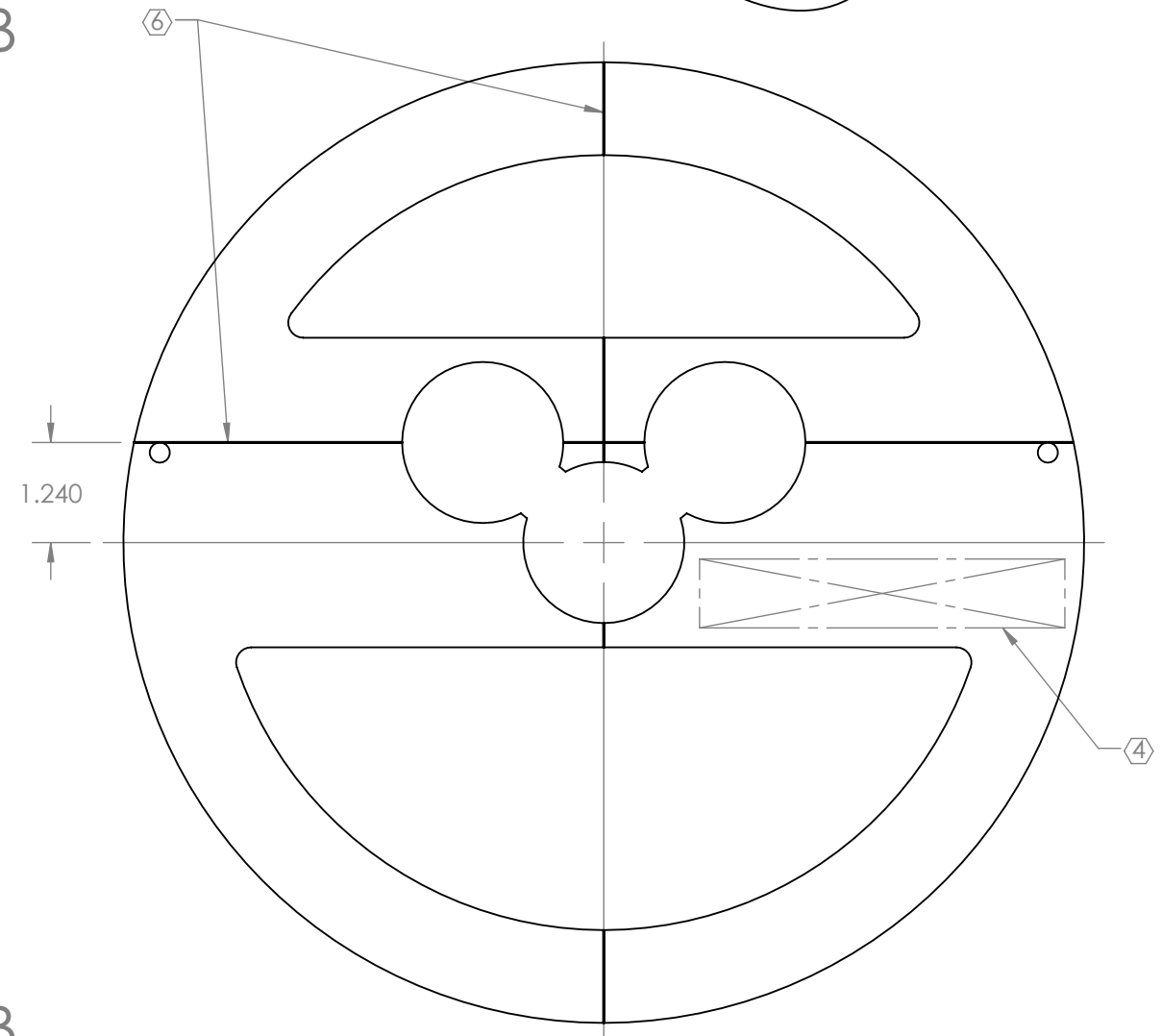
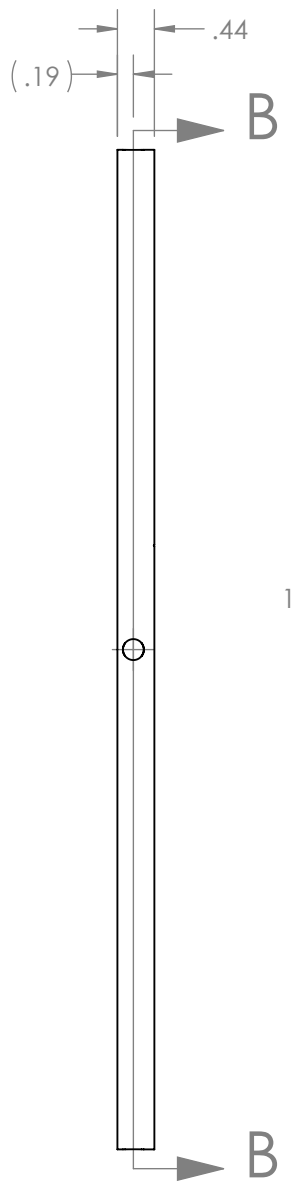
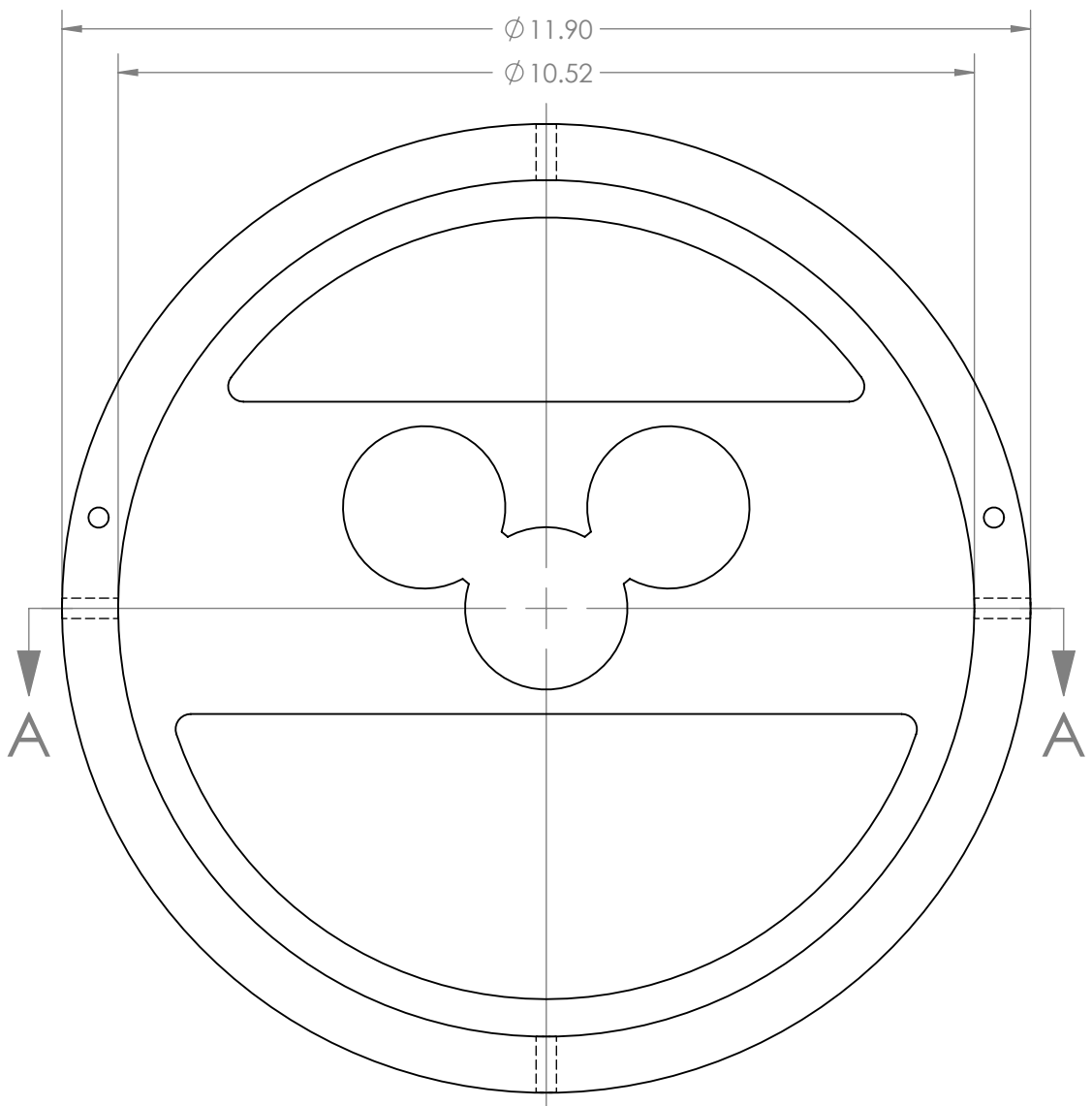
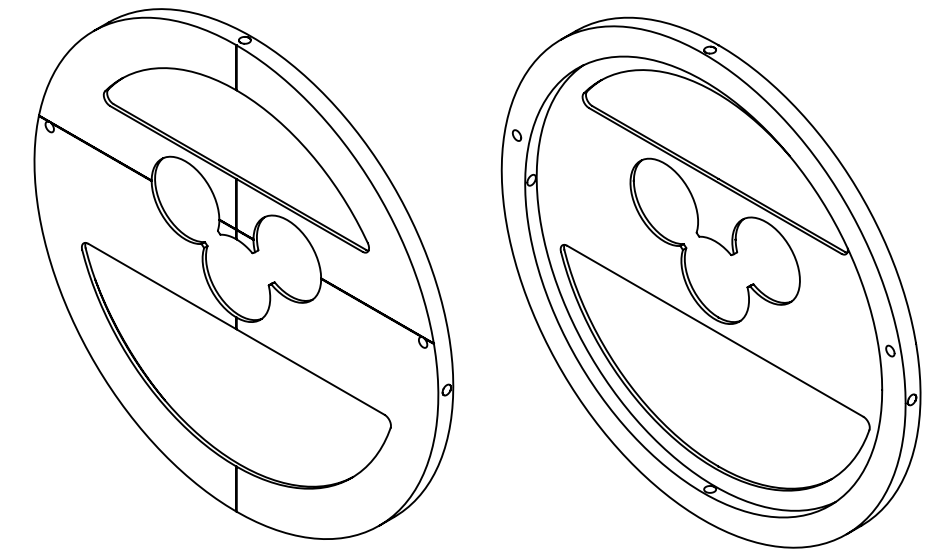

D1300778 aLIGO Pcal Tooling, Viewport Beam Target, PART PDM REV: X-015, DRAWING PDM REV: X-004

NOTES AND TOLERANCES: (UNLESS OTHERWISE SPECIFIED)				LIGO CALIFORNIA INSTITUTE OF TECHNOLOGY MASSACHUSETTS INSTITUTE OF TECHNOLOGY		PART NAME	
DIMENSIONS ARE IN INCHES				ADVANCED LIGO		aLIGO PCAL TOOLING, VIEWPORT BEAM TARGET	
TOLERANCES: .XX ± .03 .XXX ± N/A ANGULAR ± 0.5°				SUB-SYSTEM AOS		DESIGNER R. SAVAGE	
MATERIAL 6061-T6 Al				NEXT ASSY D1300777		DRAPER C. CONLEY	
FINISH 250 μinch Ra MAX						CHECKER SEE DCN	
						APPROVAL SEE DCN	
						REVISIONS 03 DEC 2013 03 DEC 2013 SEE DCN SEE DCN	
						SIZE DWG. NO. B D1300778	
						REV. v2	
						SCALE: NONE PROJECTION: SHEET 1 OF 2	

8 7 6 5 4 3 2 1

D1300778 dLIGO Pcal Tooling, Viewport Beam Target, PART PDM REV: X-015, DRAWING PDM REV: X-004

8 7 6 5 4 3 2 1

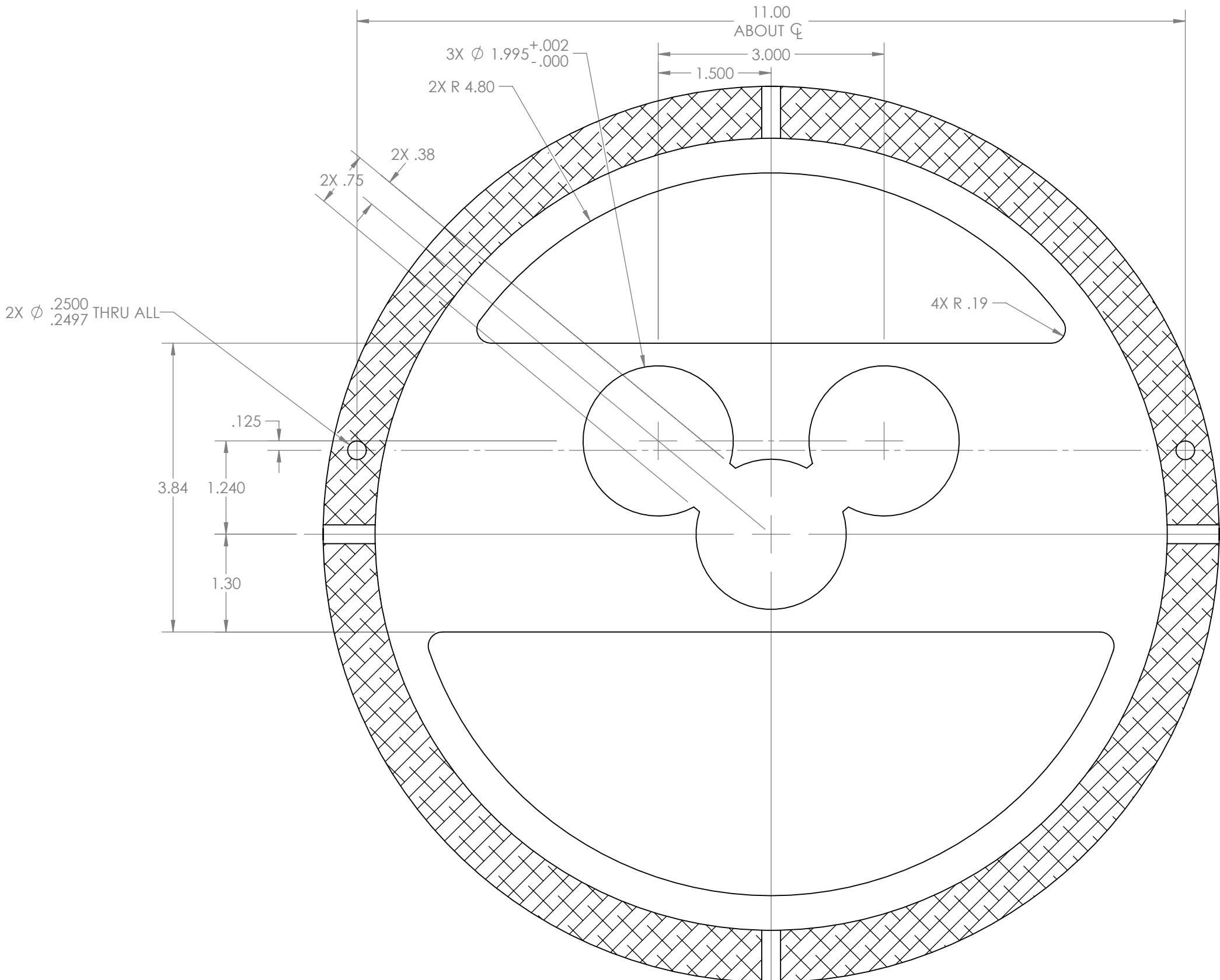
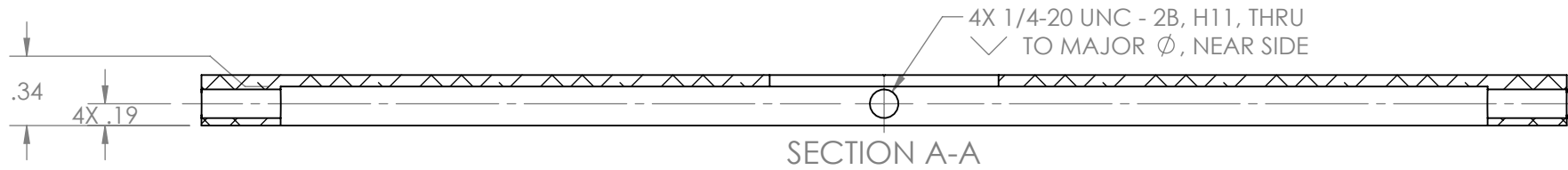

LIGO CALIFORNIA INSTITUTE OF TECHNOLOGY
MASSACHUSETTS INSTITUTE OF TECHNOLOGY

SIZE	DWG. NO.	REV.
B	D1300778	v2
SCALE: NONE	PROJECTION:	SHEET 2 OF 2

8 7 6 5 4 3 2 1