

A5BI:57HF8; BCHG
 % BHFDF9H8F5K B: D9F 5GA 9M()!% - ("
 & " 8C BCHG7 5@: FCA 8F5K B: "
 BGD97HC B DC @G< 5@: 579G25@G F: 579GFB7 @ 8 B: 16(1298: 9G5B8 7<5A: 9F"G
 G F: 57 9G<5@: 5DD95F HF5BG5F9BHK #: BC: F9MGI: GC F
 G7F5H7<9GJ @6@9HC H: 9B5798 9M9K <9B J 9K 98 "B BCFA 5@
 FCCA @: <H5: 5BGH5 6@57? 6@57?: FC1B8"
 (" 9H7 <Z: F B8 CF G5B86@5GHK: 9@9F 5@BI A 69F "59FA LL 75DDFC L"
 K <9F9G<CK B2@9H9F B: 5DDFC L"(a a <= <2K <9F9 LL "G
 B7F9A 9B5@G6FHB: K #: "\$"
)" 9GB: C @ 7C 5HB: D9F 9S- \$\$% . "
 " BC H5 HF5BGA GJ 9C DH7 5@7 CA DC B9BH
 BC <CA C: 9B 9MCF 6I 66@: @5GF9E I F9A 9BH
 A 5H@: I 98 G@7 5ZD9F @: C 9S, \$\$, - "

9H7 <Z F B8ZCF G5B86@5GHF9: GF5HC B A 5F?G
 \$%) a a ± \$%) a a K B91
 % a a ± a a @ B: A B A I A @: 6@
 89DH: @B 95@C B: 7@Z 7 9B H9F 98
 69HK 99B G F: 57 9G 16@F5B8 16&12D5F5@9@
 HC H: 97 M@B8F 7 5@5L G
 FB9: B98 6M85H A: 95H F915I L
 K H: B ± \$% a 5B8
 % \$: FCA G7 F 69 @B 95H@C 7 5HC B C:
 A B A I A D5FHk 7? B9GG

F58+G5FC1B8 6CHCA C: F97 9GG
 Z \$
 F%: FCI B8: B G< 57 9DH5 6@: CF 65G95B8
 G89GC: F97 9GG

F9J "	85H@	87B :	8F5K B: HF99.
j %	\$* A 5M&\$%	!	!
j (% C 7H&\$%	9% \$\$(%\$! \$	
!	!	!	

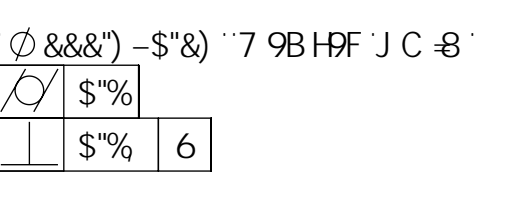
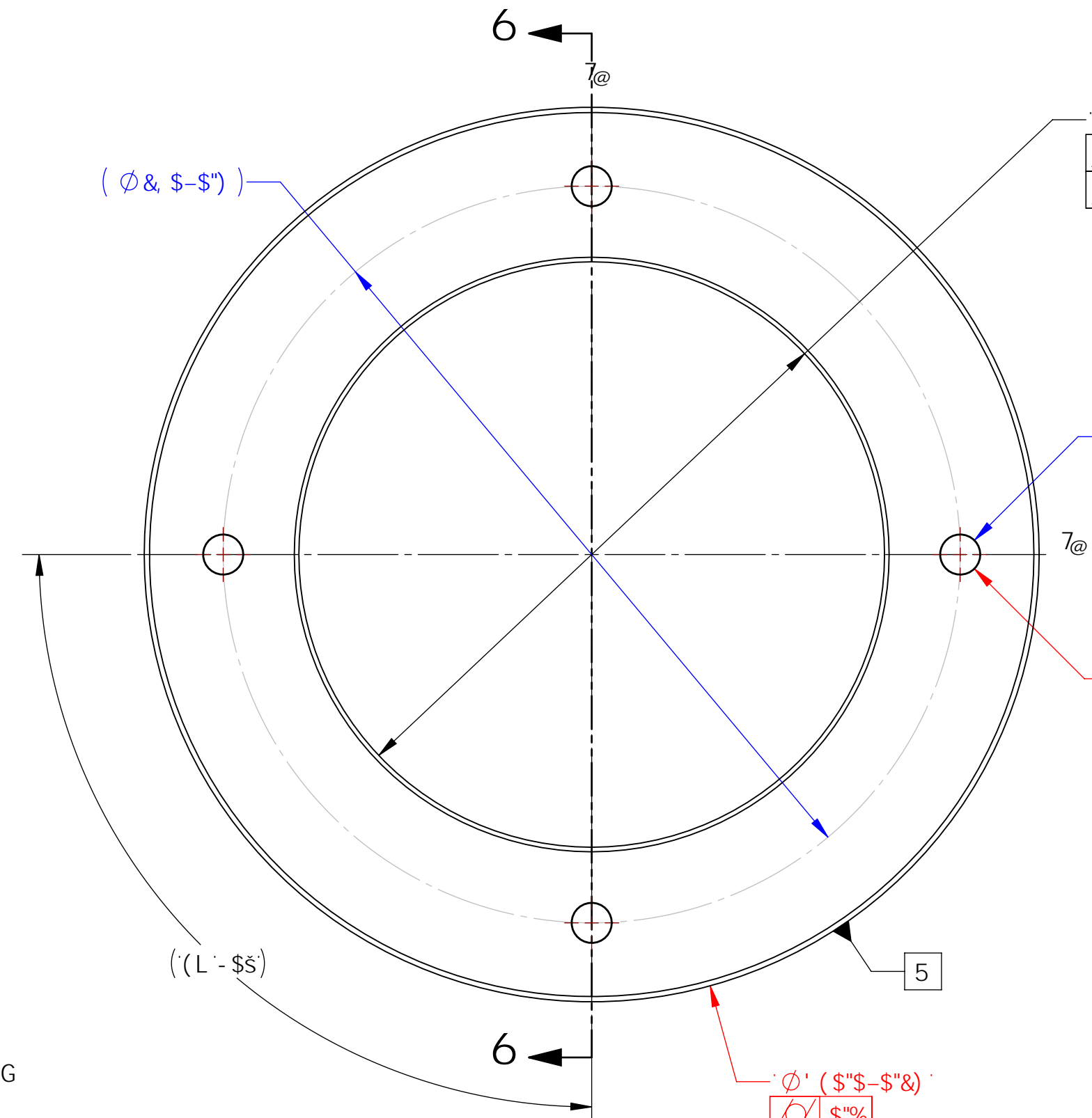
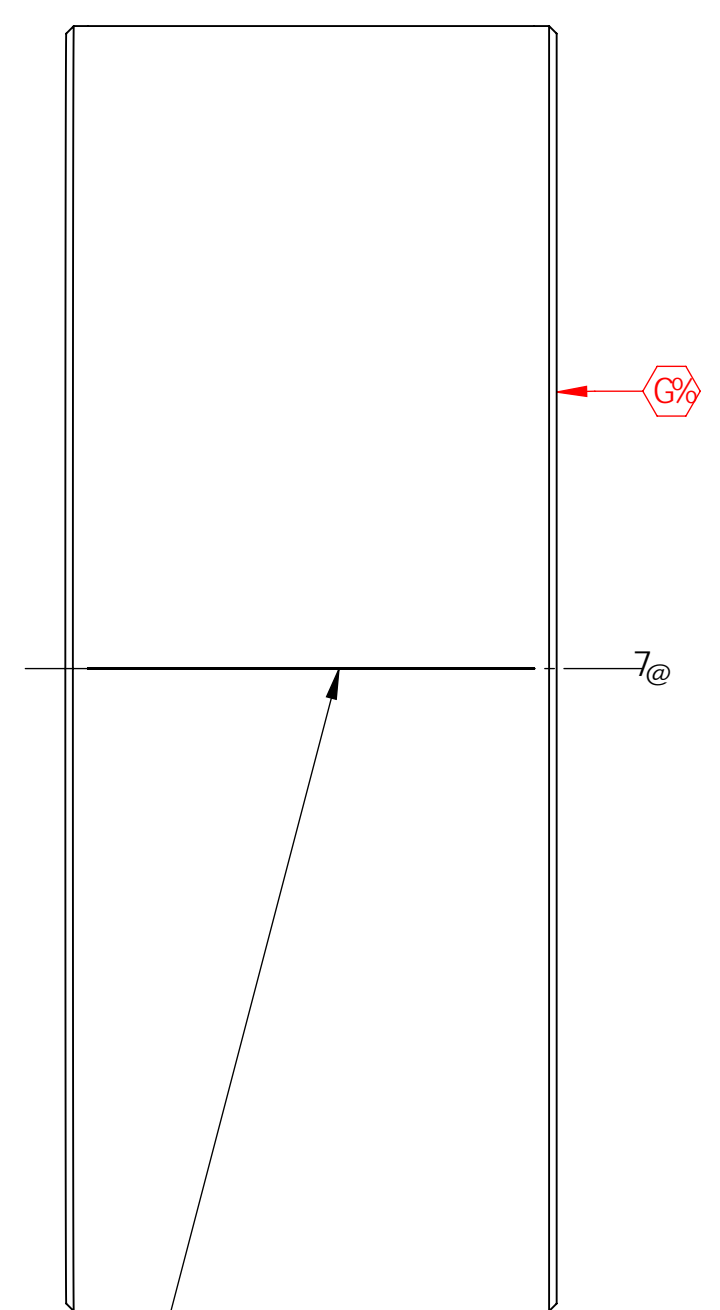
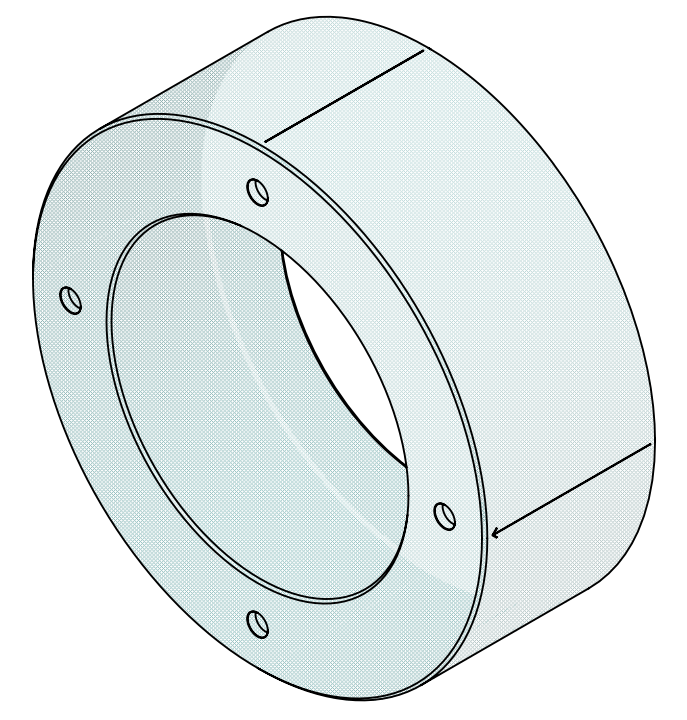
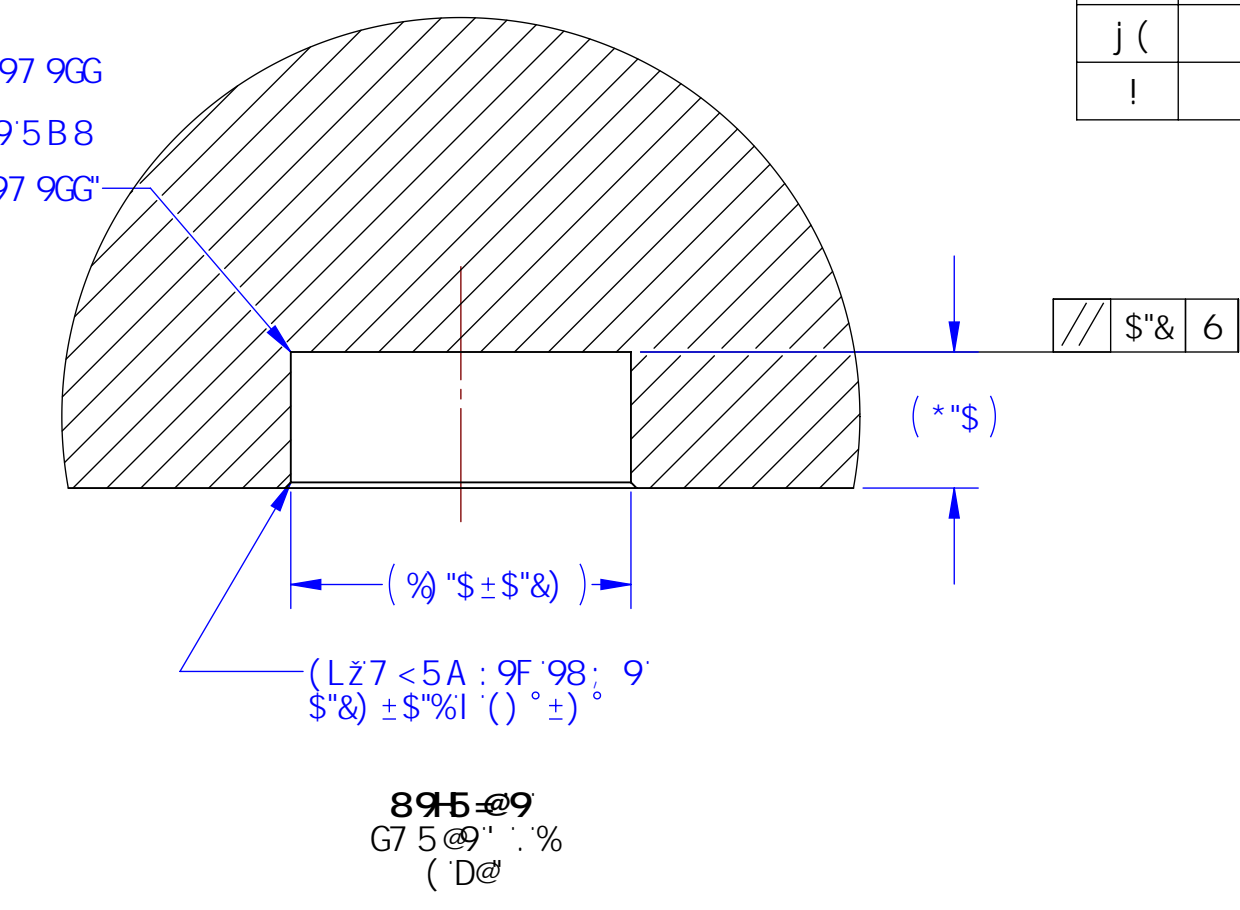
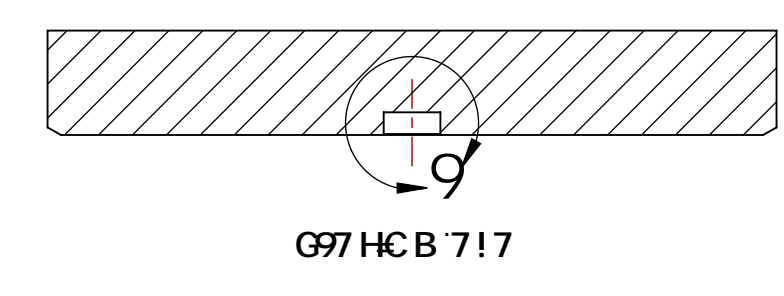
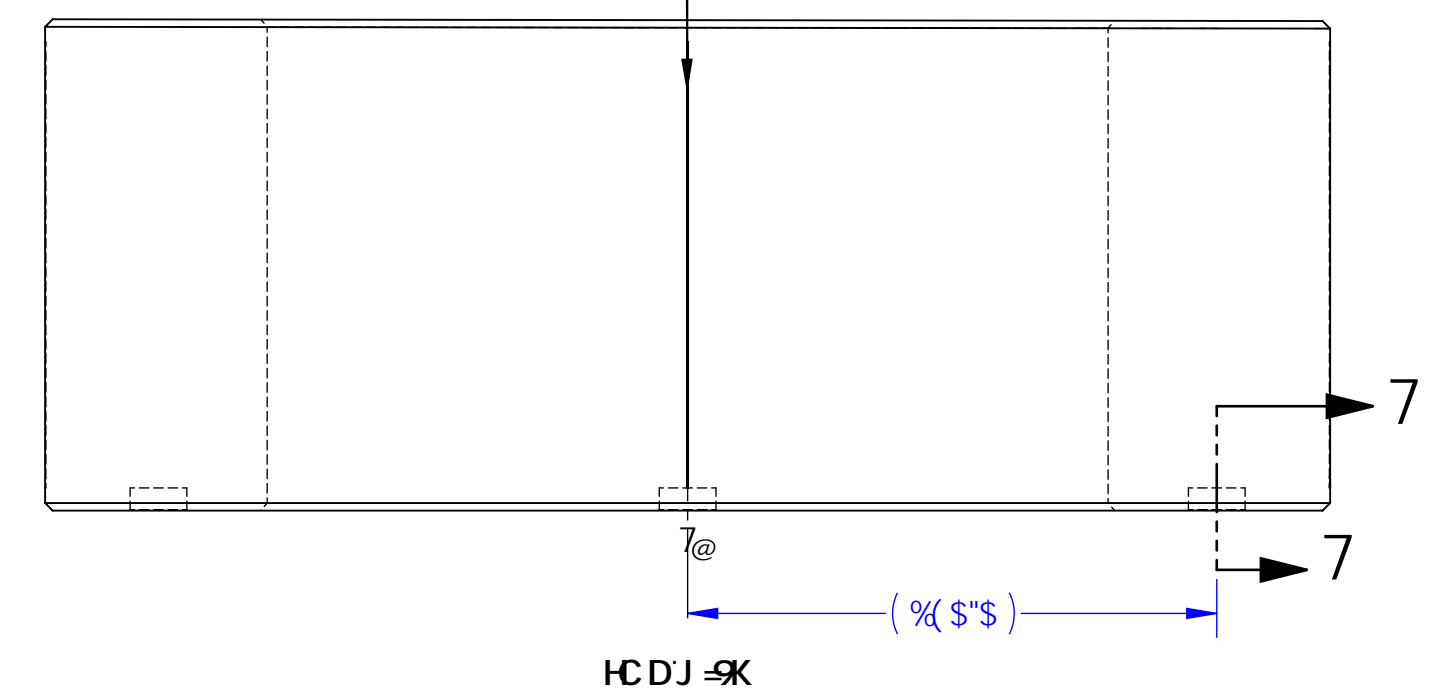

GF588@H 95FFCK 98
 F9: 9F9B 7 9 @B 97 5HB:
 D5FHC: A B A I A H: 7? B9GG
 ff9: 9F HC 89F5 @? L

(Lz φ % "\$±\$%) ∇ *"\$
 9E I 5 @MGD5 7 98 CB 5 & \$±\$%) 6C @H7 F7 @?
 98: 97 < DD-B: HC 69A B A @98"
 (φ \$%) 5

& "\$±\$%) L' *° ±°
 7 < 5A: 9F 5 @5FC1 B8

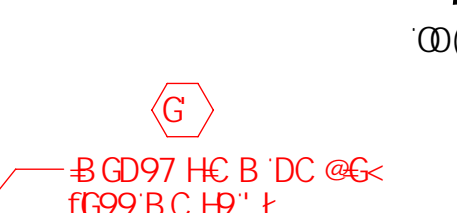

BGD97HC B DC @G<
 fG99 BC H9' L

"\$ SA 5L"
 K 98: 95B: @

9H7 <Z F B8ZCF G5B86@5GHF9: GF5HC B A 5F?G
 \$%) a a ± \$%) a a K B91
 % a a ± a a @ B: A B A I A @: 6@
 89DH: @B 95@C B: 7@Z 7 9B H9F 98
 69HK 99B G F: 57 9G 16@F5B8 16&12D5F5@9@
 HC H: 97 M@B8F 7 5@5L G
 FB9: B98 6M85H A: 95H F915I L
 K H: B ± \$% a 5B8
 % \$: FCA G7 F 69 @B 95H@C 7 5HC B C:
 A B A I A D5FHk 7? B9GG

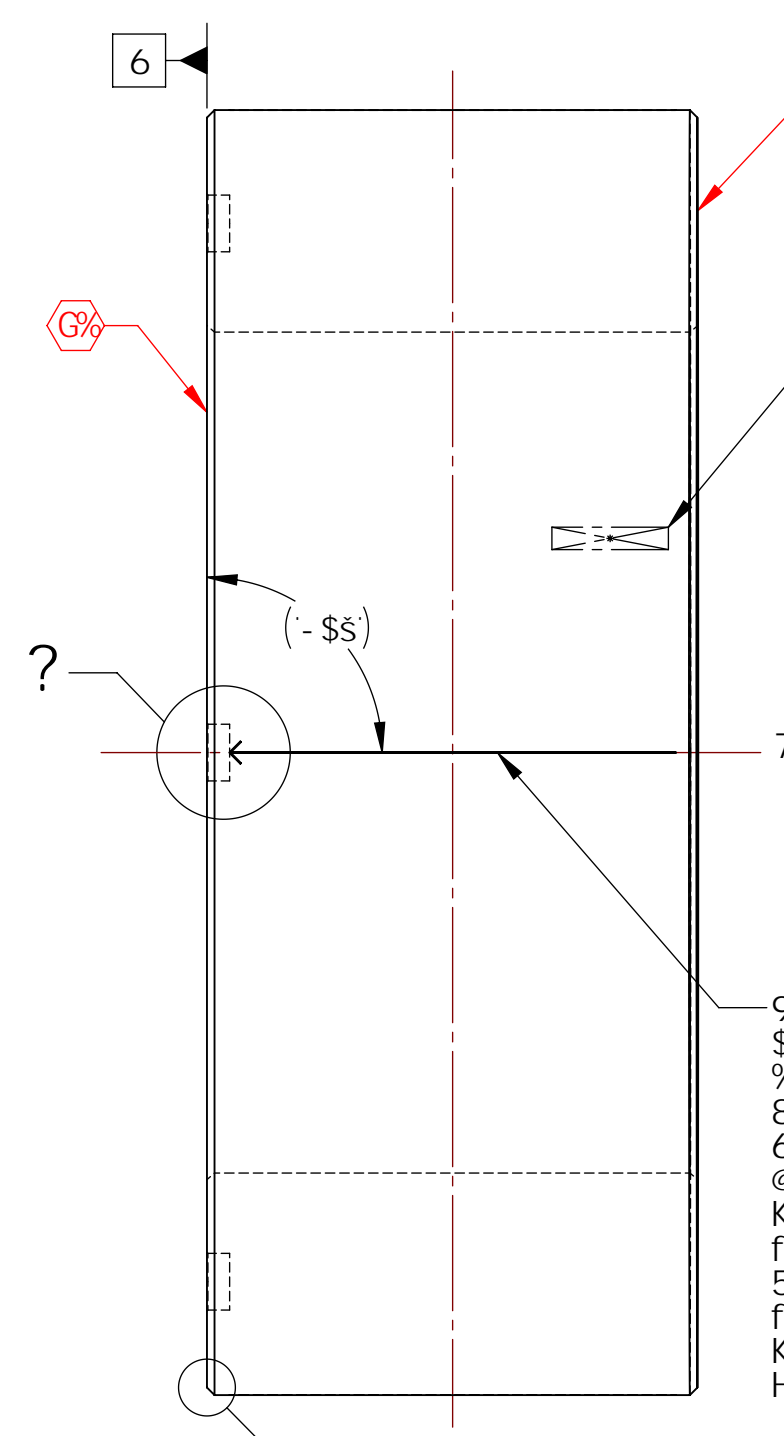
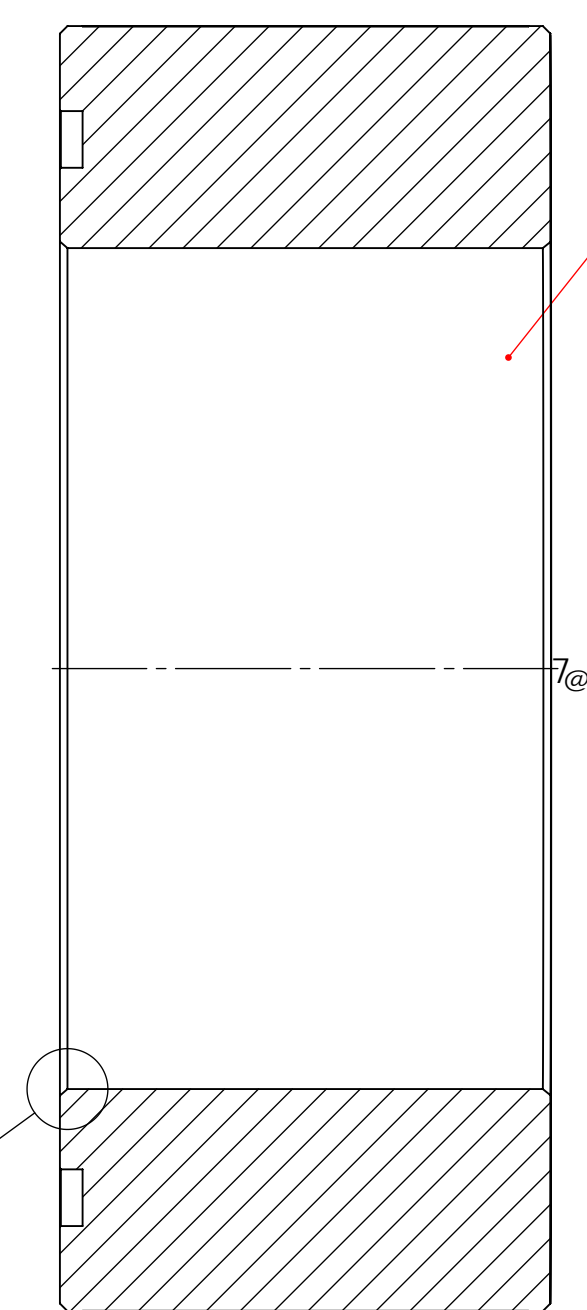

9H7 <Z: F B8 CF G5B86@5GH9F 5@
 BI A 69FZ5DDFC L"K <9F9G<CK Bz
 @H9F B: 5DDFC L"(a a <= <
 fG99 BC H9 (: C F: I FH: 9F 89F5 @C

9H7 <Z F B8ZCF G5B86@5GHF9: GF5HC B A 5F?G
 \$%) a a ± \$%) a a K B91
 % a a ± a a @ B: A B A I A @: 6@
 89DH: @B 95@C B: 7@Z 7 9B H9F 98
 69HK 99B G F: 57 9G 16@F5B8 16&12D5F5@9@
 @C 7 5HC B C: A B A I A D5FHk 7? B9GG
 K H: B ± \$% a 5B8
 % \$: FCA G7 F 69 @B 95H@C 7 5HC B C:
 A B A I A D5FHk 7? B9GG

89F5 @8
 G7 5 @9 % . %
 & D@

G97 HC B 6!6

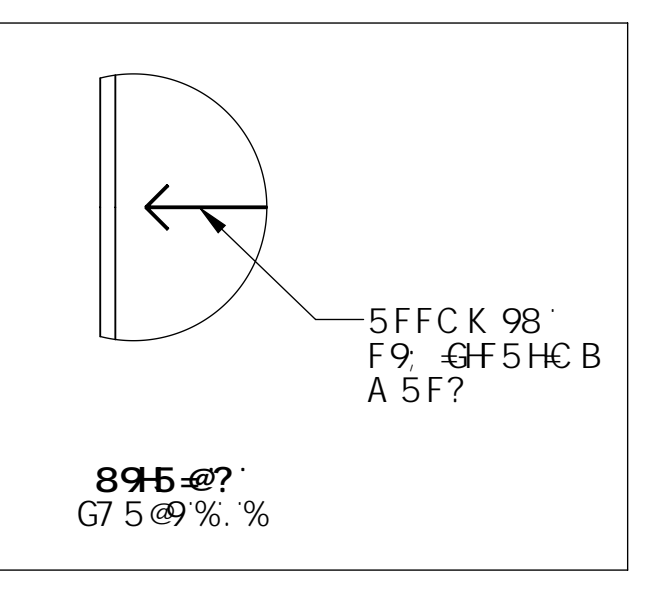

& "\$±\$&L' () ±°
 7 < 5A: 9F 5 @5FC1 B8

89F5 @5
 G7 5 @9 (. %
 & D@

89558% F: 819K FYUWHX A UGJHFA I D5FH8A F9 LLS)9F5K B: DBA F9J LLS

BCHG5B8 HC @F5B7 9G 11 B @GCH 9K @9D97 = 98L		LIGO 75@CFB5-BGHH HPC: H77 <BC@: M A 5G57 <I GHHG-BGHH HPC: H77 <BC@: M		D5FH85A 9	
8A 98GC BG5F9 B A @A 9HFG		GMBH 58J 5B7 98 @ C		G 6/GMBH !	
HC @F5B7 9G L' ± \$% LL' ± \$%)		B9LH5GM		89G: B9F : '6]l g'ym S) A 5M&59 G@P BK: " BC"	
5B: I @5F ± \$% "		A 5H@-5@		7 < 97 9F 998 7 7 998 7 7	
G99 BC H9 +		B#5		8 8 % \$ \$ \$ * ' j (
BCHG σ]oW		B#5		5DDFC J 5@ 998 7 7 998 7 7 G7 5 @9 % & DFC 97 HC B. G< 99H% C: %	